

Job Name: 25-3113 ADS Project Smash
 Job Location: Nashville, TN
 Contractor: ADS Advances Drainage Systems, Inc.

Plant: Beaver Dam
 11/10/2025 2:18:48 PM

Tech: J. Coppage
 PC: C. Goff



Structure ID: WQU-1

P6 MH096LD17-CON

MH FLAT TOP w/ 24" Conc. Hole

- P7) 24" - CASTING HEIGHT - 7"
- P6) 96" - MH FLAT TOP w/ 24" Conc. Hole - 17"
- P5) 96" - MH RISER NO STEPS - 66"
- P4) 96" - MH RISER NO STEPS - 96"
- P3) 96" - MH RISER NO STEPS - 96"
- P2) 96" - MH RISER Custom Ht - 50"
- P1) 96" - MH MONOBASE 13F, Custom Ht - 24"
- 1) ASSEMBLY REQUIRED
- 1) SECONDARY POUR
- 5) 96" - Conseal CS-102 1.00"
- 2) Hole - 40

0 lb
 10473 lb
 16442 lb
 22941 lb
 22941 lb
 12456 lb
 17113 lb
 0 lb
 0 lb
 0 lb
 0 lb

 Structure Total: 102366 lb

- Structure Notes:
1. JR HOE MC-375 STORM PROVIDED BY ICAST.
 2. PER ASTM C478 SPECIFICATIONS.
 3. CONCRETE = 4,000 PSI AT 28 DAYS.
 4. REINFORCING PER ASTM A615 (GRADE 60).
 - RISER/WALLS (As .24)
 - FLOOR (As .47) #5 BARS AT 8" C.C.E.W.
 5. LIFTING ANCHORS TO BE INSTALLED ON THE OUTSIDE OF THE STRUCTURE.
 6. INTERNAL COMPONENTS TO BE INSTALLED IN THE FIELD.

GENERAL NOTES:

1. MANUFACTURED TO ASTM C-478 (LATEST REVISION).
2. CONCRETE 5,000 PSI AT 28 DAYS.
3. WEIGHT: 10,473 LBS.
4. REINFORCING: TOP MAT: #4 BAR @ 18" C/C E.W.
 BOTTOM MAT: #5 BAR @ 12" C/C E.W.
 PER ASTM A615 (GRADE 60)

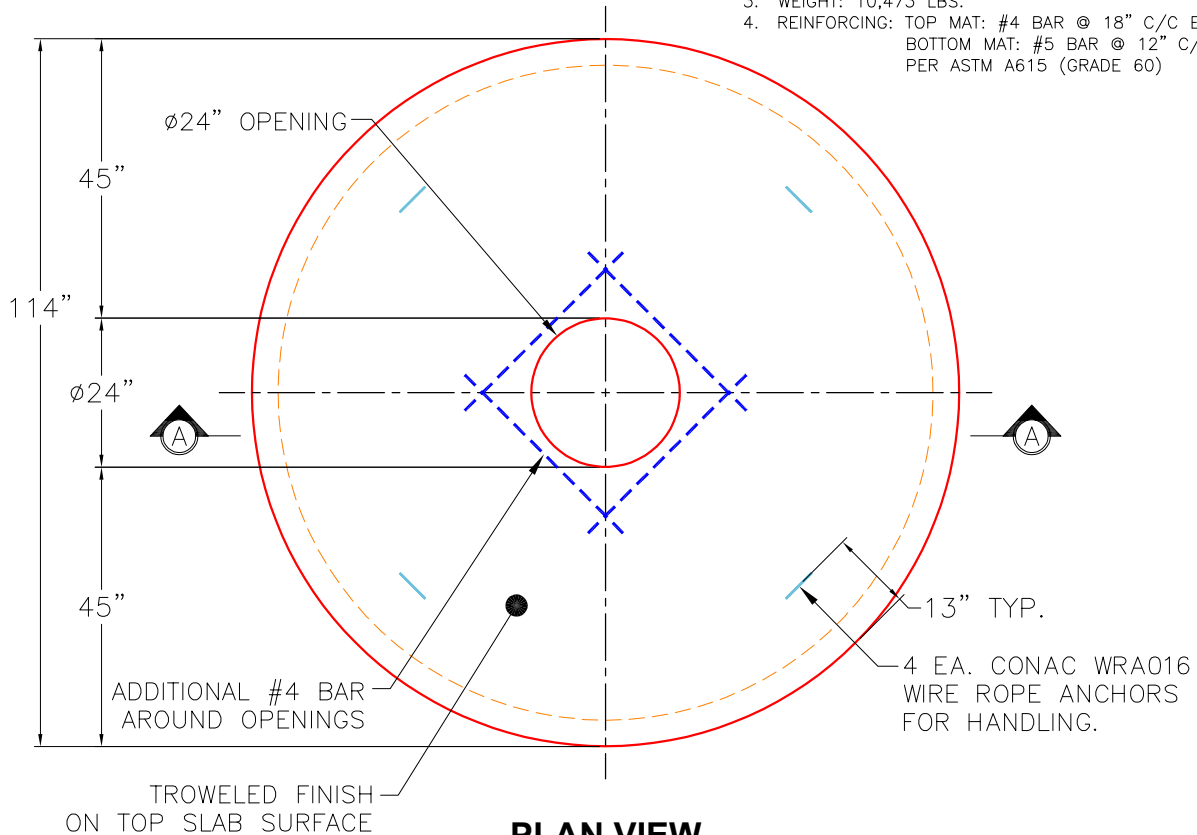

PLAN VIEW

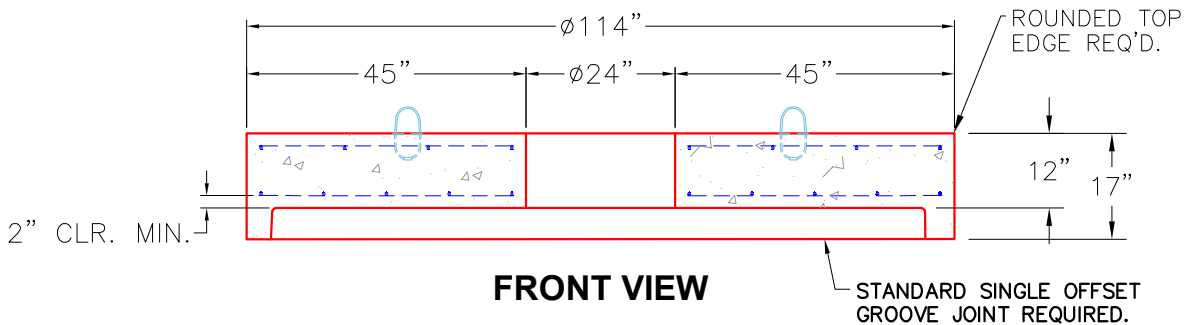

FRONT VIEW

Coating (Int):
 Coating (Ext):

Seam Up: Flat
 Seam Dn: Groove

Wall Thickness: 9"

Height (Ext): 17"

Weight (Net): 10473 lb
 Volume (Net): 2.68cu.yd