

PLAN VIEW

GENERAL NOTES:

1. CONCRETE: 4,500 PSI AT 28 DAYS
2. REINFORCING: #5 BAR @ 12" C.C. E.W. (GRADE 60)
3. PIPE AND LIFTING ANCHOR POCKETS TO BE GROUTED WITH NON-SHRINK GROUT
4. 3/4" CHAMBER ON ALL EXPOSED EDGES
5. WEIGHT: 7,260 LBS

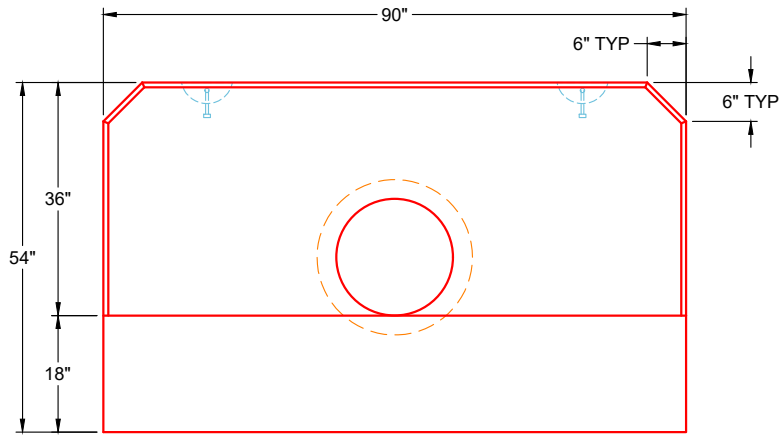

FRONT VIEW

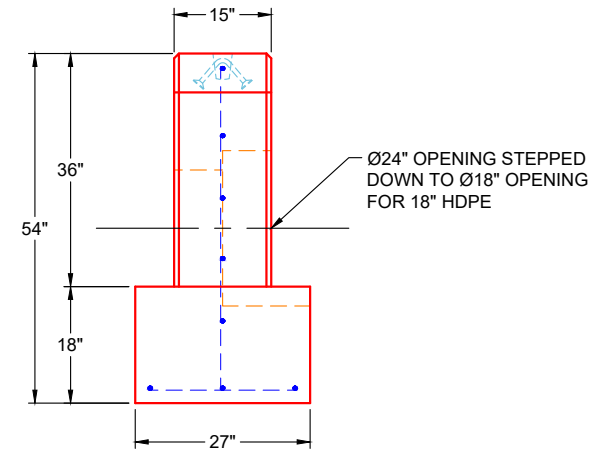

SIDE VIEW

REVISION INFORMATION

REV.	DATE	DESCRIPTION



SUBMITTAL DRAWING: 18" KYTC STD STRAIGHT HW		
CUSTOMER: INFINITY PIPELINE, INC.		
PROJECT: THE LAUREL ASSISTED LIVING FACILITY		
STRUCTURE: LS-14		
QUOTE/SALES ORDER NO: 25-2649		
CHECKED BY: B. SMITH	DRAWN BY: K. CARDWELL	
DATE: 11/04/25	SCALE: NTS	PG. 1 OF 1