

PLAN VIEW

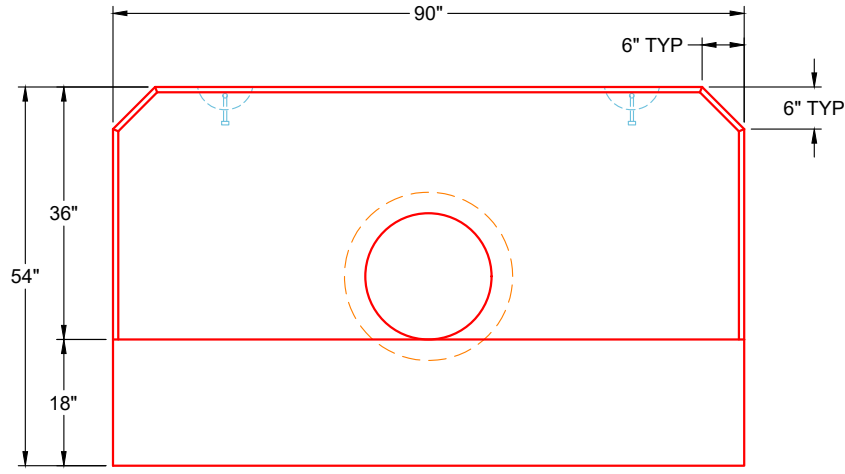

FRONT VIEW

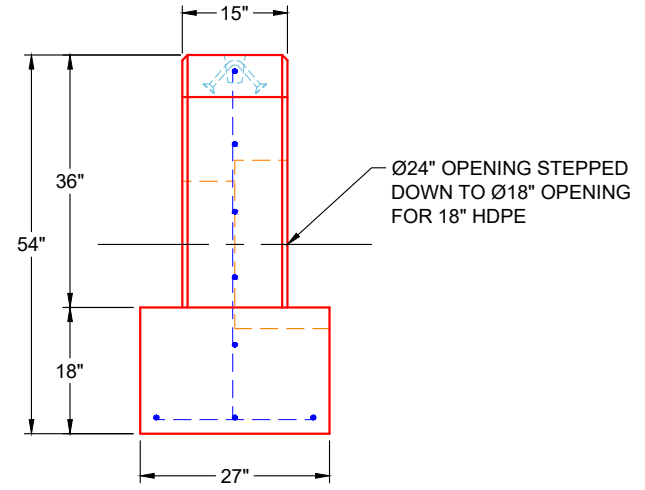

SIDE VIEW

GENERAL NOTES:

1. CONCRETE: 4,500 PSI AT 28 DAYS
2. REINFORCING: #5 BAR @ 12" C.C. E.W. (GRADE 60) - 2" MIN. REBAR CLEARANCE (TYP)
3. 3/4" CHAMBER ON ALL EXPOSED EDGES
4. WEIGHT: 7,260 LBS

PRODUCTION WORK ORDER

PRODUCT I.D.: HWKYTC-STD18

DESCRIPTION: 18" KYTC STANDARD STRAIGHT HW



QUALITY CONTROL CHECKLIST	
<input type="checkbox"/>	ALL DIMENSIONS CORRECT.
<input type="checkbox"/>	LIFTERS INSTALLED.
<input type="checkbox"/>	OPENING CENTERED.
<input type="checkbox"/>	REINFORCING CORRECT.
<input type="checkbox"/>	SURFACE QUALITY ACCEPTABLE.
<input type="checkbox"/>	EDGES CHAMFERED.
<input type="checkbox"/>	ALL PATCHWORK ACCEPTABLE.

PRODUCT VIEW: RIGHT SIDE UP
PLANT: BEAVER DAM, KY
WEIGHT: 7,260 LBS
TOP SECTION JOINT: N / A
BASE SECTION JOINT: N / A
QC CHECK INITIALS:

CUSTOMER: INFINITY PIPELINE, INC.	
PROJECT: THE LAUREL ASSISTED LIVING FACILITY	
STRUCTURE: LS-14	
ORDER NO: 25-2649	
PE: J.H. ROSS	DRAWING: K. CARDWELL
DATE: 11/04/25	SCALE: NTS PG. 1 OF 1

THIS DRAWING IS THE PROPERTY OF INFRASTRUCTURE PRECAST, INC. ANY USE OR DUPLICATION OF THIS DRAWING WITHOUT PRIOR AUTHORIZATION IS STRICTLY PROHIBITED.