

Job Name: 25-2631 The Maxwell PH 2
 Job Location: Lexington, KY
 Contractor: Woodall Construction Co., Inc.

Plant: Beaver Dam

Tech: C.Russ

11/7/2025 12:48:18 PM

PC: T. Ryan



Structure ID: OS 3

P2 MH048CN42

ECC CONE w/ 24" HOLE

- P4) 24" - CASTING HEIGHT - 7"
- P3) 24" - GRADE RING - 3"
- P2) 48" - ECC CONE w/ 24" HOLE - 42"
- P1) 48" - MH BASE - 48"
- 1) 48" - SGL 1"x14.5' Butyl (2x)
- 2) Hole - 24"
- 8) MH Step ML-10-TDS-NCR - 10"

- Structure Notes:**
1. ASTM C478 SPEC'S.
 2. CONCRETE = 4,000 PSI AT 28 DAYS.
 3. REINFORCING PER ASTM A615 (GRADE 60.)
 4. CASTING PROVIDED BY OTHERS.

	0 lb
	202 lb
	3200 lb
	4289 lb
	0 lb
	0 lb
	0 lb
Structure Total:	7691 lb

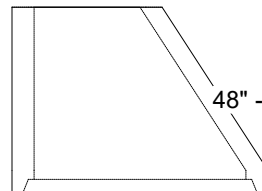
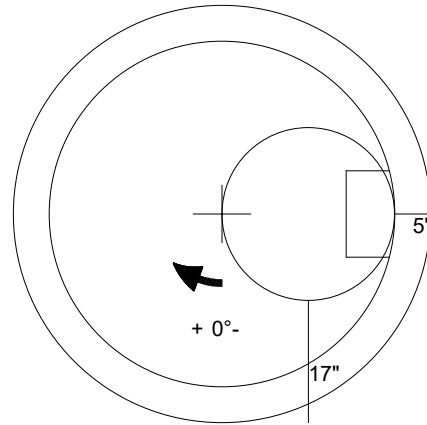

48" - ECC CONE w/ 24" HOLE - 42" - (P2)

Coating (Int):
 Coating (Ext):

Seam Up: Flat
 Seam Dn: Groove

Wall Thickness: 5"

Height (Ext): 42"

Weight (Net): 3200 lb
 Volume (Net): 0.5cu.yd