

**Job Name: 25-2627 High St. Culvert Replacement**  
**Job Location: Springfield, KY**  
**Contractor: M&J Construction**

PC: C. Goff  
 TECH: J. Horsley  
 Plant: Beaver Dam



Structure ID: 002 (KY CBI A)

Spec: KYTC  
 Type: CBI TYPE A (10') private  
 Size: 24" x 84"

Rim: 756.17'  
 Invert: 749.25'  
 Rim to Invert: 6.92'

Sump: 3"  
 Floor (Top): 749'  
 Floor Height: 8"

Floor (Bot): 748.333'  
 Overall Height: 7.833'  
 Slack: 0.04"

Structure Notes:

- PER KYTC CBI TYPE A / ASTM C913 SPEC'S.
- CONCRETE = 4,000 PI AT 28 DAYS.
- NO STEPS & NO INVERT CHANNEL.
- CASTING BY ICAST (HOE K-206 TY. F/C) CAST INTO TOP SLAB.

REINFORCING PER ASTM A615 (GRADE 60).  
 - TOP PHASE (As .62) #5 BARS AT 6" C.C.E.W.  
 - WALLS (As .31) #5 BARS AT 12" C.C.E.W.  
 - FLOOR (As .31) #5 BARS AT 12" C.C.E.W.

STRUCTURE SUMMARY:

P4) 24" x 120" - CB INLET KY A 10' TOP LEFT F/G - 10"	3400 lb
P3) 24" x 120" - CB INLET KY A 10' BOTTOM LEFT T/G - 18"	5270 lb
P2) 24" x 84" - CB FT REDUCER 24"X36" HOLE T/F - 8"	2105 lb
P1) 24" x 84" - BOX BASE 8inW, 8inF, Variable Ht F/n - 50"	6353 lb
1) CASTING - HOE KY-206 F/C (KY TY1)	206 lb
1) 24" x 36" - Conseal CS-102 1.00"	0 lb
2) DOGHOUSE INVRTD (ELLIP) - 74"x52.50"	0 lb
<b>Structure Total:</b>	<b>17334 lb</b>

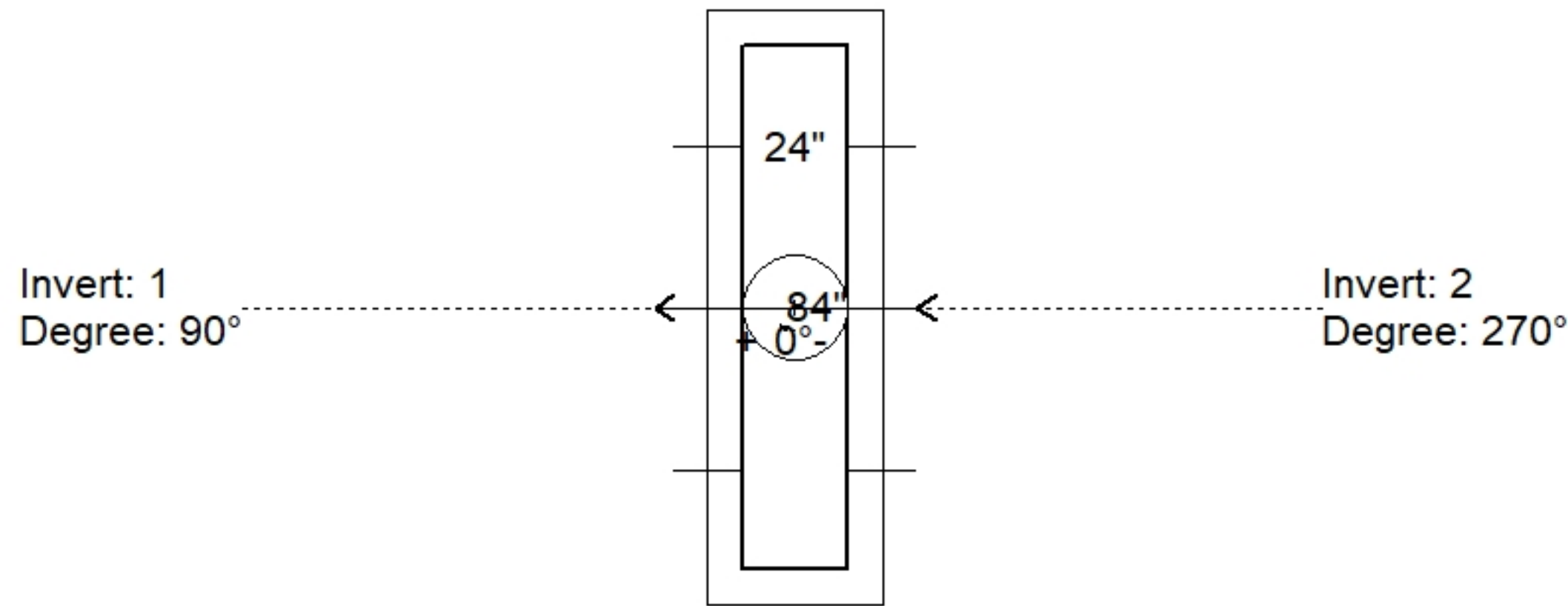

Position	Elev	Angle	Pipe	Pipe OD	Hole	Connector	Up ( )	Ref
Rim	756.17'							
Reducer	753.167'							
Invert 1	749.25'	90°	60" x 38" ELL RCP	71" x 49"	74" x 52.5"	DOGHOUSE INVRTD (ELLIP) 74"x52.50"	-2.5"	P1
Invert 2	749.25'	270°	60" x 38" ELL RCP	71" x 49"	74" x 52.5"	DOGHOUSE INVRTD (ELLIP) 74"x52.50"	-2.5"	P1
Invert 3								
Invert 4								
Invert 5								
Invert 6								
Invert 7								
Invert 8								

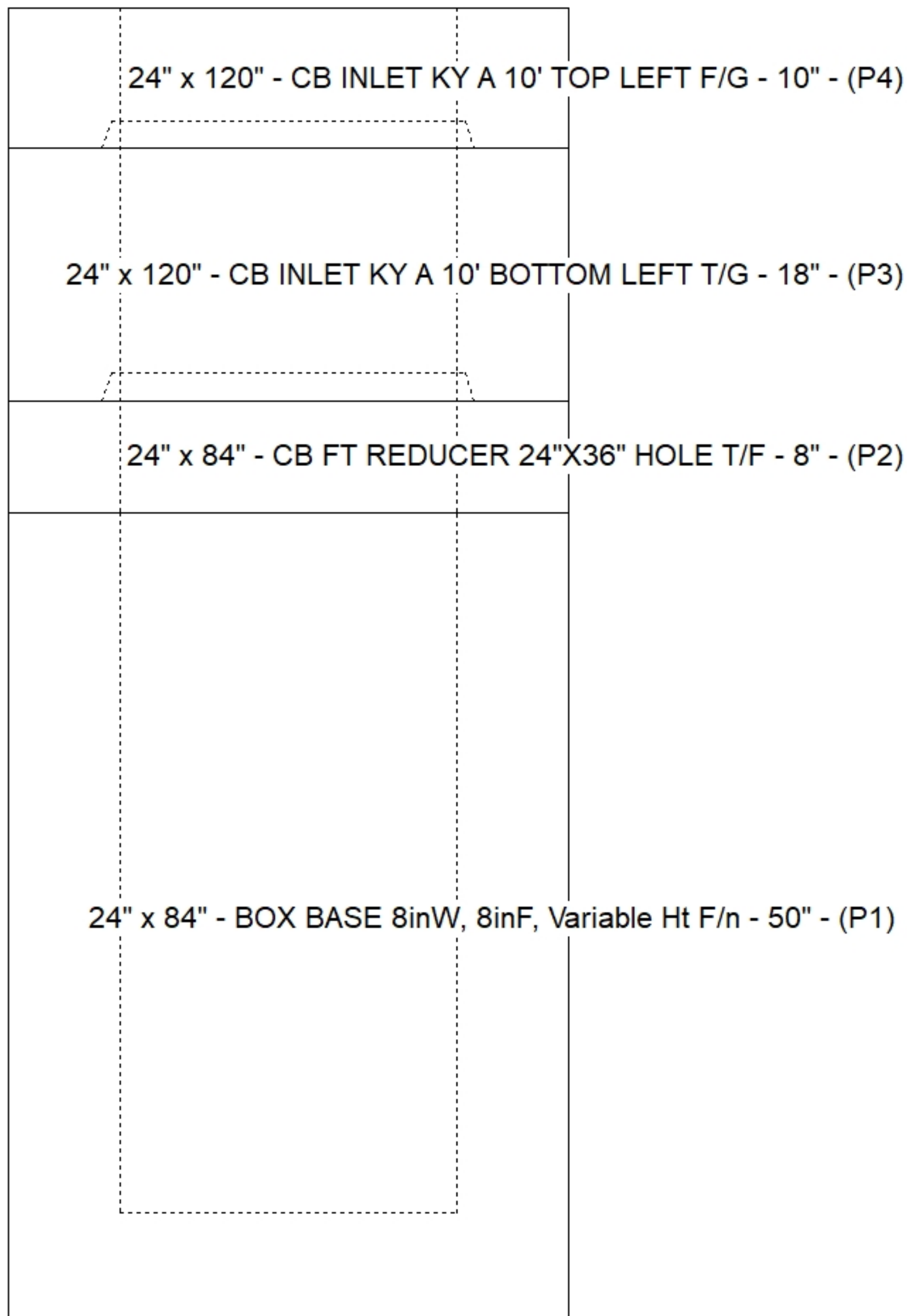

Cast (Int. Dim.) - Interior Dimensions

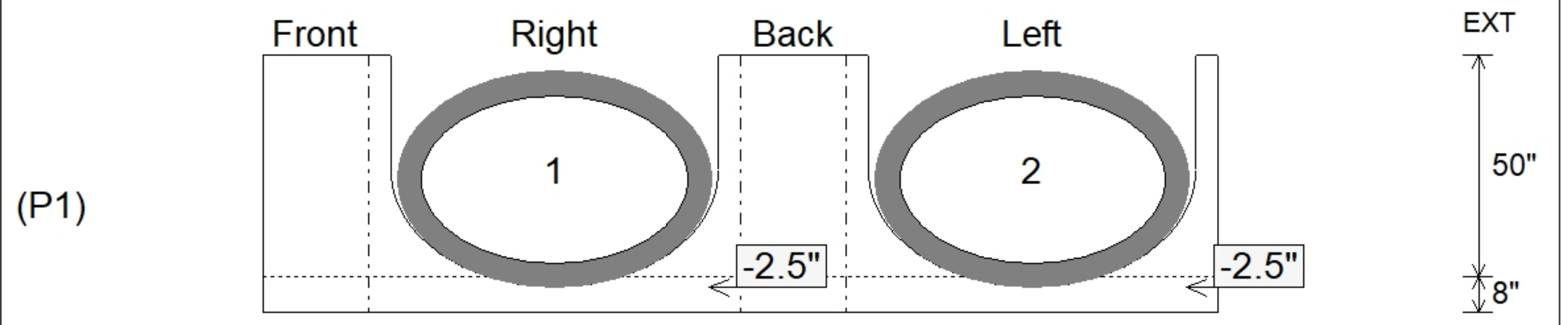

Submittal Drawing  
 10/14/2025 8:43:30 AM

SUBMITTAL  
 APPROVED BY: