

Job Name: 25-2601 Spring Creek Parkway Phase 2 (Storm)
 Job Location: Clarksville, TN
 Contractor: Byard Construction, LLC

Plant: Beaver Dam

Tech: S. Felletter

2/23/2026 8:53:39 AM

PC: A. Chambers



Structure ID: CB-50

P1 BX6262-08BAVF

BOX BASE 8inW, 8inF, Variable Ht T/n

- P5) 28" x 34" - CASTING HEIGHT - 7"
- P4) 62" x 62" - BX FLAT TOP 8"W - TDOT NO 12SC (28"x34" HOLE) F/F - 10"
- P3) 62" x 62" - BOX RISER 8inW, Variable Ht F/G - 35"
- P2) 62" x 62" - BOX RISER 8inW, Variable Ht T/G - 69"
- P1) 62" x 62" - BOX BASE 8inW, 8inF, Variable Ht T/n - 82"
- 3) 62" x 62" - Conseal CS-102 1.00"
- 1) 28" x 34" - Conseal CS-102 1.00"
- 2) Hole - 60
- 1) Hole - 6

	0 lb
	4945 lb
	6560 lb
	12969 lb
	15701 lb
	0 lb
	0 lb
	0 lb
	0 lb
Structure Total:	40175 lb

Structure Notes:

1. PER TDOT D-CB-12SC / ASTM C913 SPEC'S.
2. CONCRETE = 4,000 PSI AT 28 DAYS.
3. NO INVERT CHANNEL.
4. CASTING BY OTHERS (TDOT TY. 12 - JBS 3123 MOD F/G/H)

REINFORCING PER ASTM A615 (GRADE 60).
 ** SEE TDOT STD DRAWING D-CB-12SC **
 - TOP SLAB - DBL MAT #5 BARS.
 - WALLS (As .54) #5 BARS AT 7" C.C.E.W.
 - FLOOR (As .54) #5 BARS AT 7" C.C.E.W.

Rim: 499.62' Rim to Invert: 16.5' Slack: 0" Sump: 5" Step Position:

GENERAL NOTES:

1. MANUFACTURED TO ASTM C-913 (LATEST REVISION).
2. CONCRETE: 4,000 PSI AT 28 DAYS.
3. REINFORCING PER TDOT D-CB-12SC
 WALLS: #5 BAR @ 7" E.W. C.C. (GRADE 60)
 FLOOR: #5 BAR @ 7" E.W. C.C. (GRADE 60)
4. WEIGHT: TOTAL = 15,701 LBS.
 FIRST POUR = 4,225 LBS.
 SECOND POUR = 11,476 LBS.

First Pour Drawing

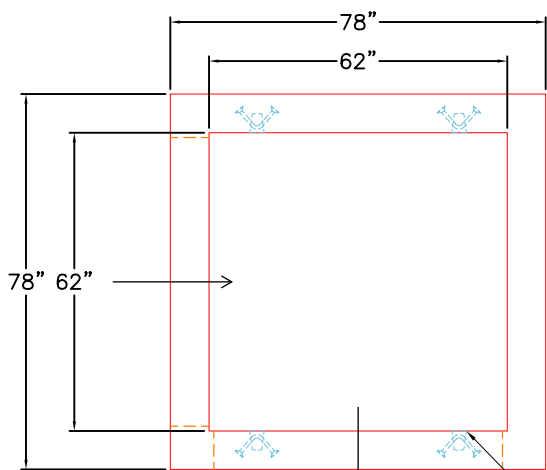

TOP VIEW

4 EA. CONAC 5CA18 ANCHORS FOR PLANT & FIELD HANDLING.

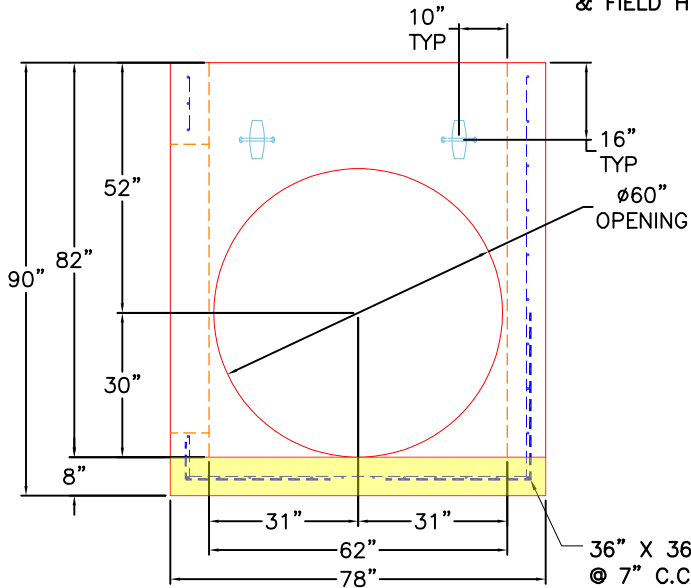

FRONT VIEW

36" X 36" #5 BAR @ 7" C.C. TIED INTO THE MAT

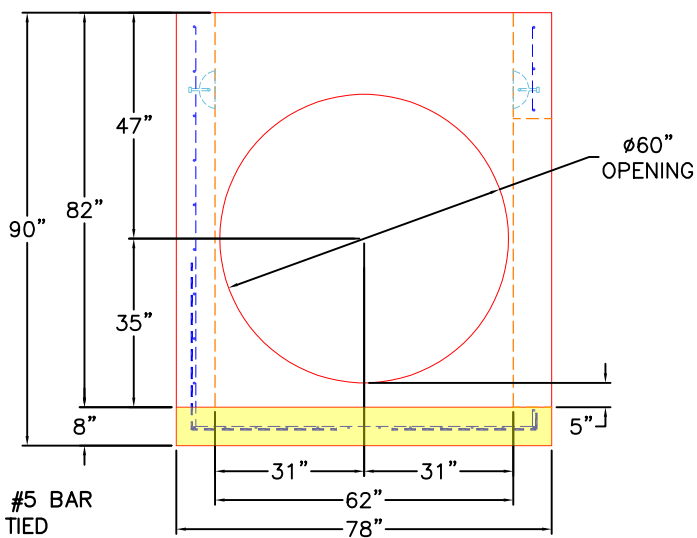

RIGHT VIEW

Coating (Int):
 Coating (Ext):

Seam Up: Tongue
 Seam Dn: n/a

Wall Thickness: 8"
 Floor Height: 8"

Height (Int): 82"
 Height (Ext): 90"

Weight (Net): 15701 lb
 Volume (Net): 4.01cu.yd

Job Name: 25-2601 Spring Creek Parkway Phase 2 (Storm)
 Job Location: Clarksville, TN
 Contractor: Byard Construction, LLC

Plant: Beaver Dam
 2/23/2026 8:53:39 AM

Tech: S. Felletter
 PC: A. Chambers



Structure ID: CB-50

P1 BX6262-08BAVF

BOX BASE 8inW, 8inF, Variable Ht T/n

- P5) 28" x 34" - CASTING HEIGHT - 7"
- P4) 62" x 62" - BX FLAT TOP 8"W - TDOT NO 12SC (28"x34" HOLE) F/F - 10"
- P3) 62" x 62" - BOX RISER 8inW, Variable Ht F/G - 35"
- P2) 62" x 62" - BOX RISER 8inW, Variable Ht T/G - 69"
- P1) 62" x 62" - BOX BASE 8inW, 8inF, Variable Ht T/n - 82"
- 3) 62" x 62" - Conseal CS-102 1.00"
- 1) 28" x 34" - Conseal CS-102 1.00"
- 2) Hole - 60
- 1) Hole - 6

0 lb
 4945 lb
 6560 lb
 12969 lb
 15701 lb
 0 lb
 0 lb
 0 lb
 0 lb

Structure Notes:
 1. PER TDOT D-CB-12SC / ASTM C913 SPEC'S.
 2. CONCRETE = 4,000 PSI AT 28 DAYS.
 3. NO INVERT CHANNEL.
 4. CASTING BY OTHERS (TDOT TY. 12 - JBS 3123 MOD F/G/H)

REINFORCING PER ASTM A615 (GRADE 60).
 ** SEE TDOT STD DRAWING D-CB-12SC **
 - TOP SLAB - DBL MAT #5 BARS.
 - WALLS (As .54) #5 BARS AT 7" C.C.E.W.
 - FLOOR (As .54) #5 BARS AT 7" C.C.E.W.

Structure Total: 40175 lb

Rim: 499.62' Rim to Invert: 16.5' Slack: 0" Sump: 5" Step Position:

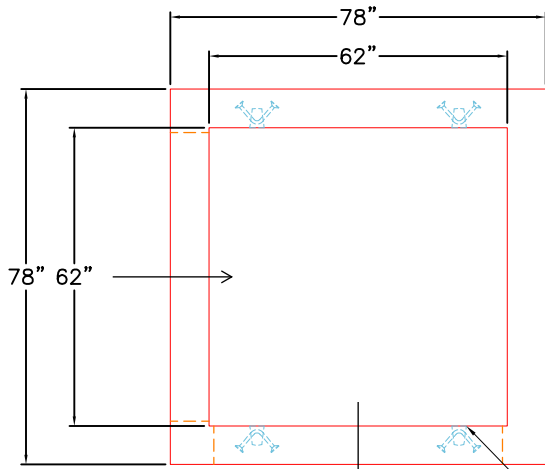

TOP VIEW

4 EA. CONAC 5CA18 ANCHORS FOR PLANT & FIELD HANDLING.

GENERAL NOTES:

1. MANUFACTURED TO ASTM C-913 (LATEST REVISION).
2. CONCRETE: 4,000 PSI AT 28 DAYS.
3. REINFORCING PER TDOT D-CB-12SC
 WALLS: #5 BAR @ 7" E.W. C.C. (GRADE 60)
 FLOOR: #5 BAR @ 7" E.W. C.C. (GRADE 60)
4. WEIGHT: TOTAL = 15,701 LBS.
 FIRST POUR = 4,225 LBS.
 SECOND POUR = 11,476 LBS.

Second Pour Drawing

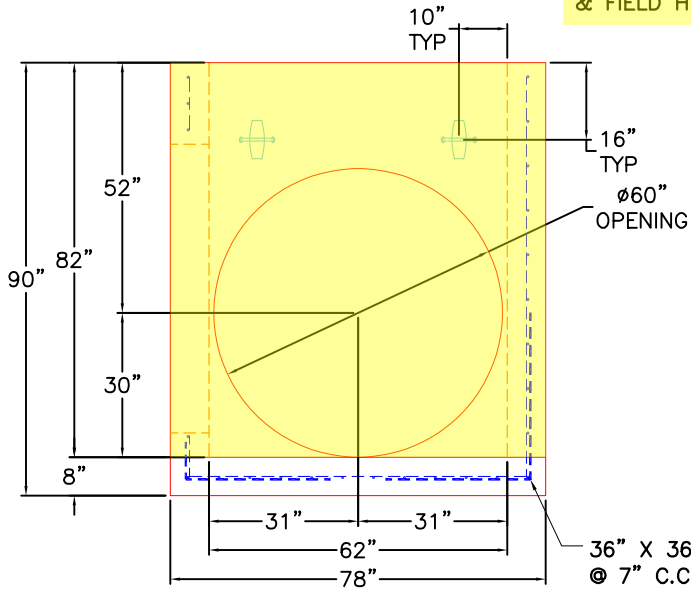

FRONT VIEW

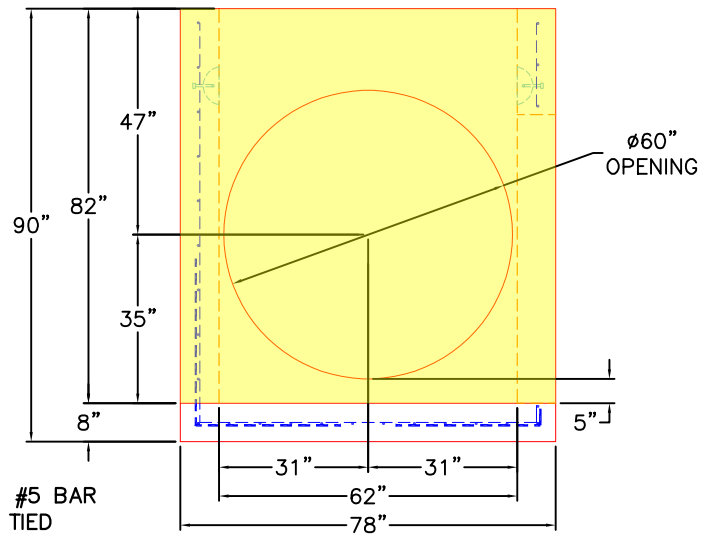

RIGHT VIEW

Coating (Int):
 Coating (Ext):

Seam Up: Tongue
 Seam Dn: n/a

Wall Thickness: 8"
 Floor Height: 8"

Height (Int): 82"
 Height (Ext): 90"

Weight (Net): 15701 lb
 Volume (Net): 4.01cu.yd