

Job Name: 25-2592 - Meadows-Northland Ph 7
 Job Location: Lexington, KY
 Contractor: Delmae LLC

Plant: 100

2/5/2026 2:17:03 PM

Tech: J. Horsley - F

PC: T. Lewis



Structure ID: A1

P1 BX2472-08BAVF

BOX BASE 8inW, 8inF, Variable Ht F/n

- P2) 24" x 72" - CASTING HEIGHT - 6"
- P1) 24" x 72" - BOX BASE 8inW, 8inF, Variable Ht F/n - 29"
- 1) SECONDARY POUR
- 1) 24" x 72" - Conseal CS-102 1.00"
- 1) Hole - 20

0 lb
 6513 lb
 0 lb
 0 lb
 0 lb

 Structure Total: 6513 lb

- Structure Notes:**
1. PER LFUCG CBI TYPE D DOUBLE / ASTM C-913 SPECIFICATIONS
 2. CONCRETE: 4,000 PSI AT 28 DAYS
 3. REINFORCEMENT: #5 BAR @ 12" C.C. E.W. (GRADE 60) - 2" MIN. REBAR CLEARANCE (TYP)
 4. NO STORM INVERT
 5. NO STEPS
 6. 2 EA. HOE 525 FRAMES, L-VANE GRATES, & CURB HOODS SUPPLIED BY OTHERS
 7. WET STICK 14" X 18" #5 L-BAR SPACED @ 12" C.C. (GRADE 60) OUT OF FLOOR FOR WALL POUR TIE-IN (SEE L-BAR DETAIL)

FIRST POUR (FLOOR): 2,363 LBS
SECOND POUR (WALLS): 4,150 LBS

Rim: 965.57' Rim to Invert: 2.93' Slack: 0.16" Sump: 0" Step Position:

Position	Elev	Angle	Ext. (cw)	Pipe	Pipe OD	Connector	Hole	Horz Size	Up ()	Offset
Invert 1	962.64'	270°	26"	15" HDPE	17.6"	Hole 20	20"	20"	-1.3"	-18"
Invert 2										
Invert 3										
Invert 4										
Invert 5										
Invert 6										
Invert 7										
Invert 8										

RIGHT-SIDE UP VIEW (int. dimensions)

UPSIDE-DOWN VIEW (int. dimensions)

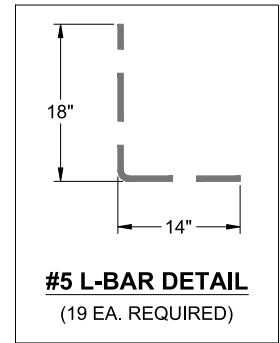
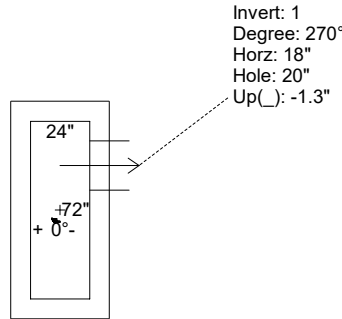
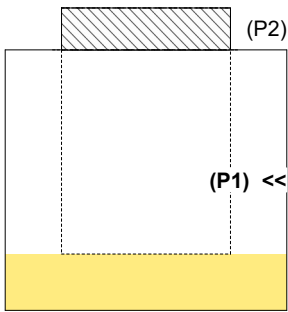

INSIDE WALL DIMENSIONS

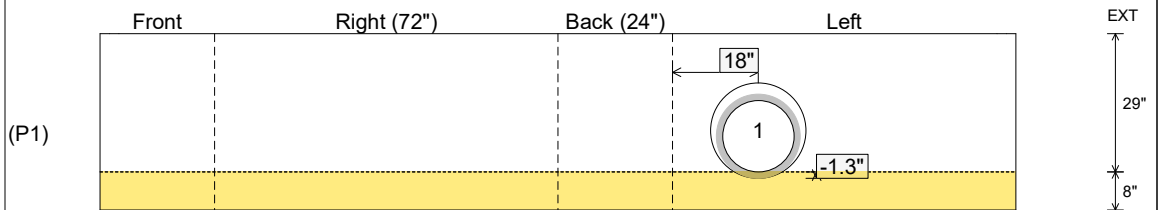

Coating (Int):
 Coating (Ext):

Seam Up: Flat
 Seam Dn: n/a

Wall Thickness: 8"
 Floor Height: 8"

Height (Int): 29"
 Height (Ext): 37"

Weight (Net): 6513 lb
 Volume (Net): 1.66cu.yd

Job Name: 25-2592 - Meadows-Northland Ph 7
 Job Location: Lexington, KY
 Contractor: Delmae LLC

Plant: 100

2/5/2026 2:17:03 PM

Tech: J. Horsley - F

PC: T. Lewis



Structure ID: A1

P1 BX2472-08BAVF

BOX BASE 8inW, 8inF, Variable Ht F/n

- P2) 24" x 72" - CASTING HEIGHT - 6"
- P1) 24" x 72" - BOX BASE 8inW, 8inF, Variable Ht F/n - 29"
- 1) SECONDARY POUR
- 1) 24" x 72" - Conseal CS-102 1.00"
- 1) Hole - 20

0 lb
 6513 lb
 0 lb
 0 lb
 0 lb

 Structure Total: 6513 lb

- Structure Notes:**
1. PER LFUCG CBI TYPE D DOUBLE / ASTM C-913 SPECIFICATIONS
 2. CONCRETE: 4,000 PSI AT 28 DAYS
 3. REINFORCEMENT: #5 BAR @ 12" C.C. E.W. (GRADE 60) - 2" MIN. REBAR CLEARANCE (TYP)
 4. NO STORM INVERT
 5. NO STEPS
 6. 2 EA. HOE 525 FRAMES, L-VANE GRATES, & CURB HOODS SUPPLIED BY OTHERS
 7. LIFTERS: 4 EA. 4CA14 CONAC A-ANCHORS FOR PLANT & FIELD HANDLING - INSTALLED IN 90° & 270° WALLS, MIN. 10" FROM TOP OF WALLS

FIRST POUR (FLOOR): 2,363 LBS
SECOND POUR (WALLS): 4,150 LBS

Rim: 965.57' Rim to Invert: 2.93' Slack: 0.16" Sump: 0" Step Position:

Position	Elev	Angle	Ext. (cw)	Pipe	Pipe OD	Connector	Hole	Horz Size	Up ()	Offset
Invert 1	962.64'	270°	26"	15" HDPE	17.6"	Hole 20	20"	20"	-1.3"	-18"
Invert 2										
Invert 3										
Invert 4										
Invert 5										
Invert 6										
Invert 7										
Invert 8										

RIGHT-SIDE UP VIEW (int. dimensions)

UPSIDE-DOWN VIEW (int. dimensions)

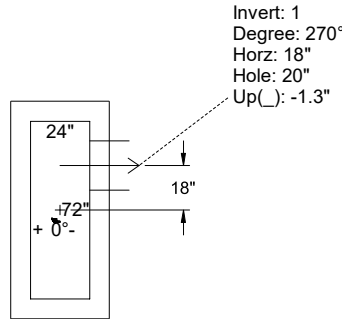
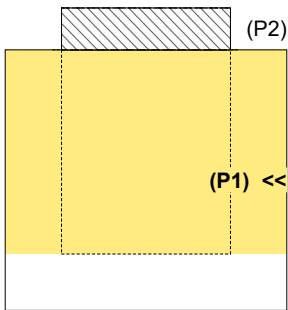

INSIDE WALL DIMENSIONS

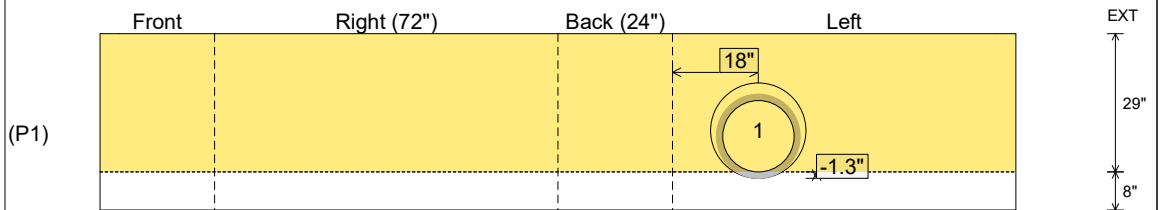

Coating (Int):
 Coating (Ext):

Seam Up: Flat
 Seam Dn: n/a

Wall Thickness: 8"
 Floor Height: 8"

Height (Int): 29"
 Height (Ext): 37"

Weight (Net): 6513 lb
 Volume (Net): 1.66cu.yd