

Job Name: 25-2418 Marvin's Lift Station
 Job Location: Radcliff, KY 40160
 Contractor: Ferguson Waterworks #1491

Plant: Beaver Dam, KY
 12/30/2025 10:47:01 AM

Tech: C. Russ
 PC: C. Goff

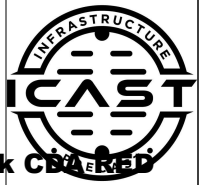

Structure ID: Valve Vault Top Slab

P1 BX072096-08LD08S-CDARED

BX FLAT TOP 8"W w/36"x48" HATCH w/ ConBlock CDA RED

- P2) 36" x 48" - HATCH (CAST FLUSH) - 0"
- P1) 72" x 96" - BX FLAT TOP 8"W w/36"x48" HATCH w/ ConBlock CDA RED - 8"
- 2) PSX - 12-06 NYLO
- 1) PSX - 8QRS-S NYLO
- 57.33 SqFt) Carboline Bitumastic 300M [INT]

100 lb
 5456 lb
 16 lb
 6 lb
 0 lb

 Structure Total: 5579 lb

- Structure Notes:**
1. PER ASTM C478 SPECIFICATIONS.
 2. CONCRETE = 4,000 PSI AT 28 DAYS.
 3. REINFORCING PER ASTM A615 (GRADE 60).
 - TOP SLAB (As .62) #5 BARS AT 6" C.C.E.W..
 - RISER/WALLS (As .12)
 - FLOOR (As .31) #5 BARS AT 12" C.C.E.W.

GENERAL NOTES:

1. MANUFACTURED TO ASTM C-913 (LATEST REVISION).
2. CONCRETE 4,000 PSI AT 28 DAYS.
3. REINFORCING: SEE BELOW PER ASTM A615. (GRADE 60KSI)
4. (USF FAB 36" X 48" HATCH PROVIDED BY OTHERS)
5. HATCH TO BE CAST INTO THE TOP SLAB.

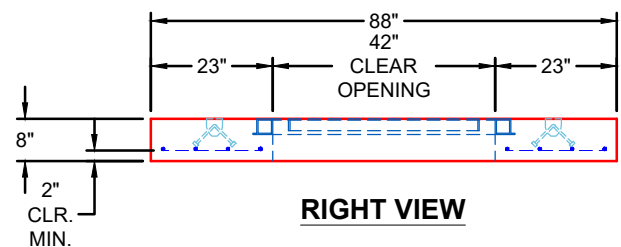
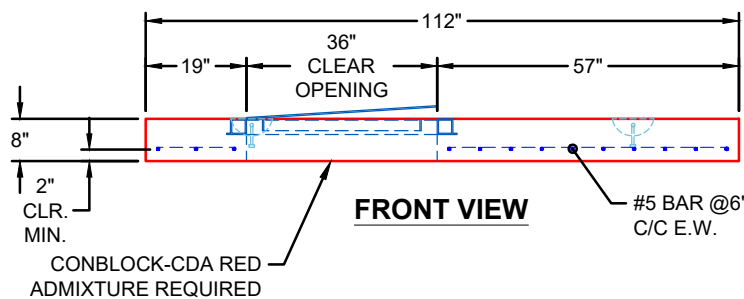
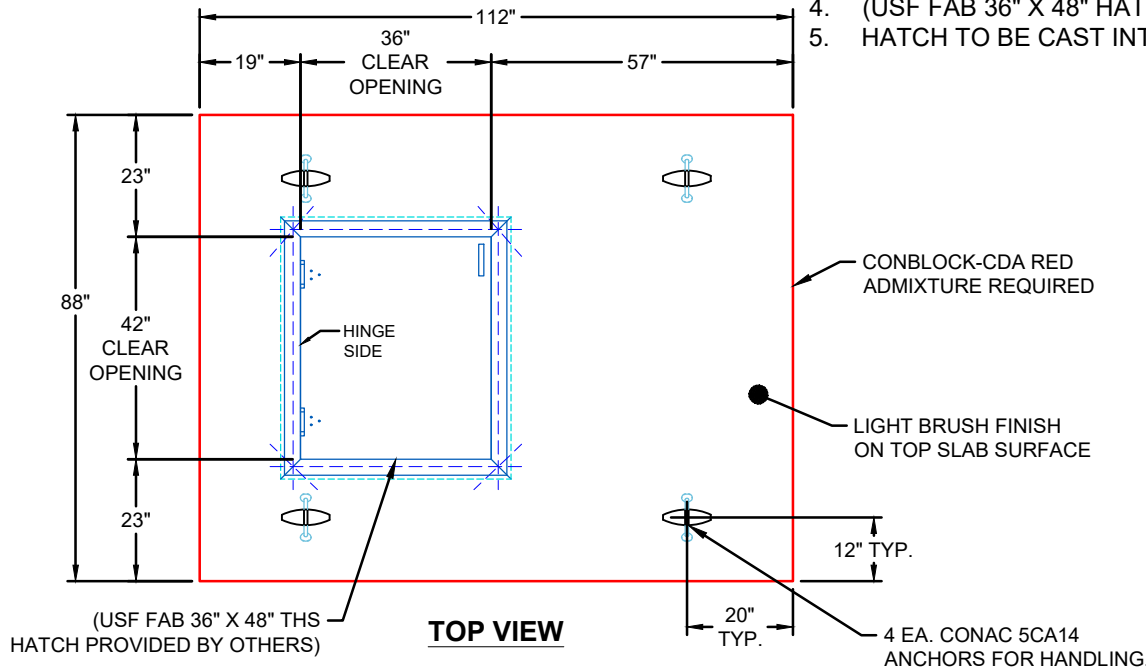

Coating (Int): Carboline Bitumastic 300M
 Coating (Ext):

Seam Up: Flat
 Seam Dn: Flat

Wall Thickness: 8"

Height (Ext): 8"

Weight (Net): 5456 lb
 Volume (Net): 1.39cu.yd