



Structure ID: HW-15

P1 HWA15

15" - HW AW w/FOOTER F/F

DIMENSIONS & QUANTITIES										
TYPE	PIPE Ø	A	B	C	D	E	F	G	WEIGHT W/TOE	WEIGHT
AW	15"	2'-8"	4'-0"	2'-8"	2'-2"	2'-0"	6"	0"	1,630 LBS.	1,380 LBS.

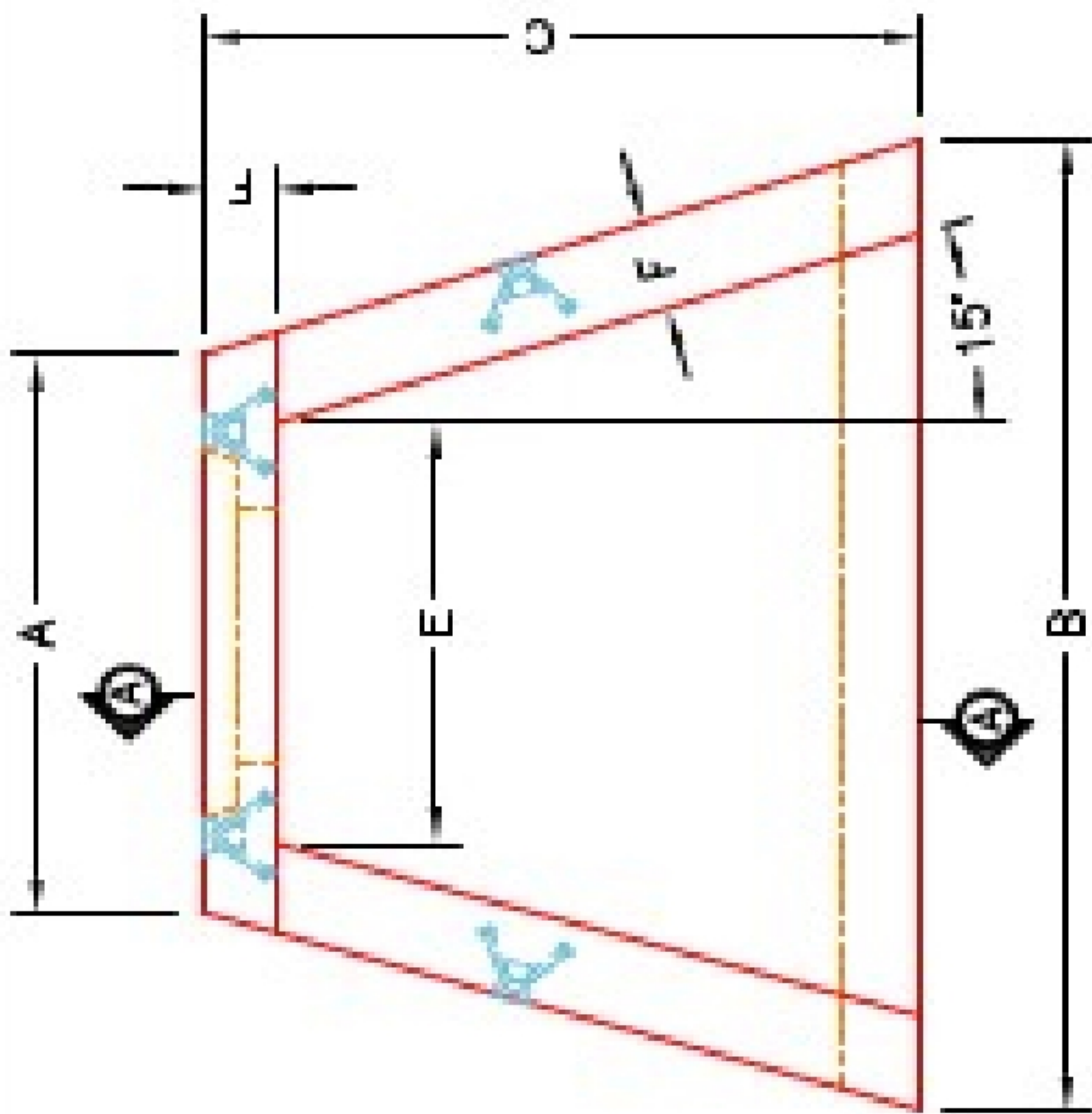

PLAN VIEW

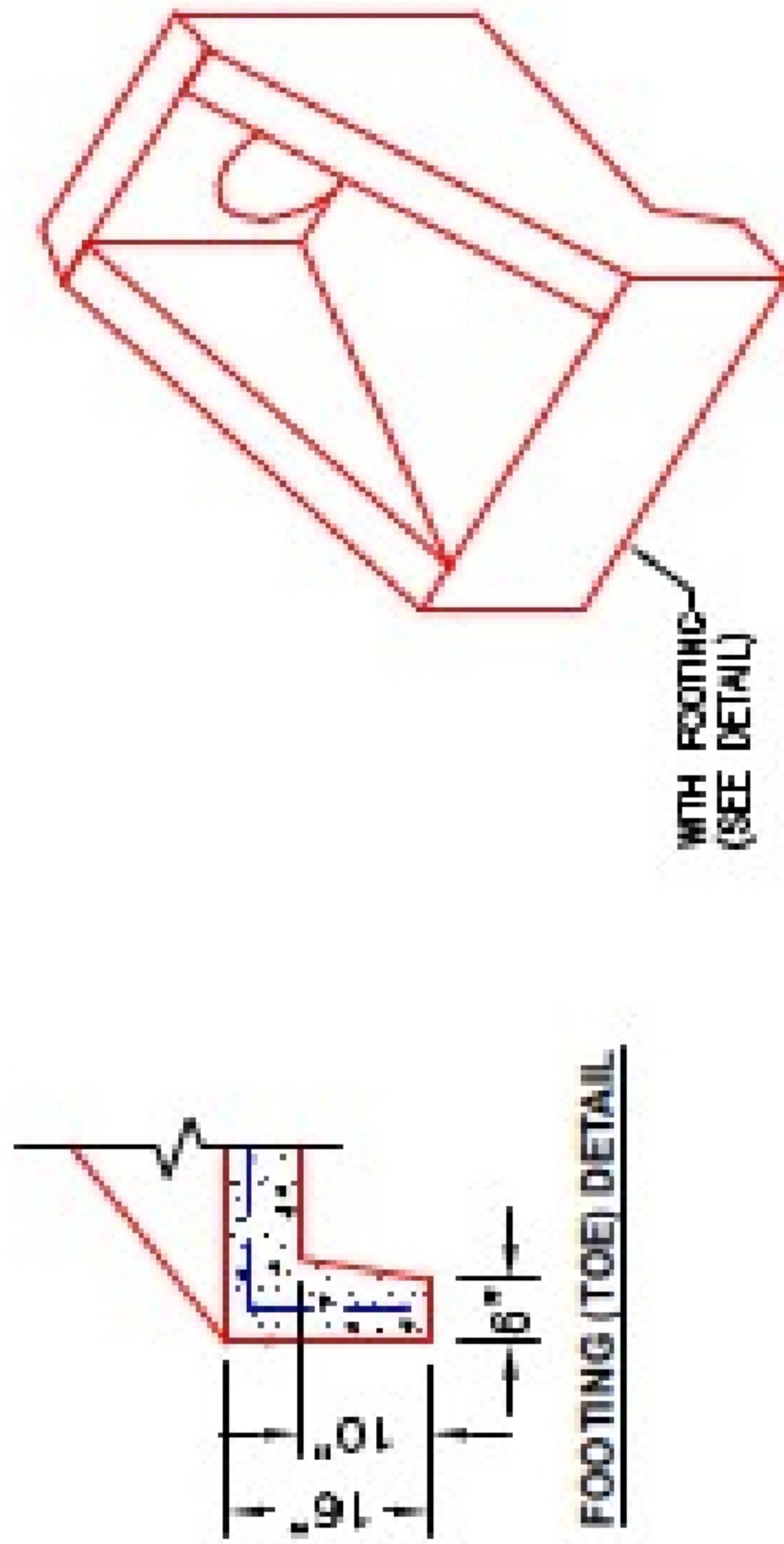

FOOTING (TOE) DETAIL

ISOMETRIC VIEW

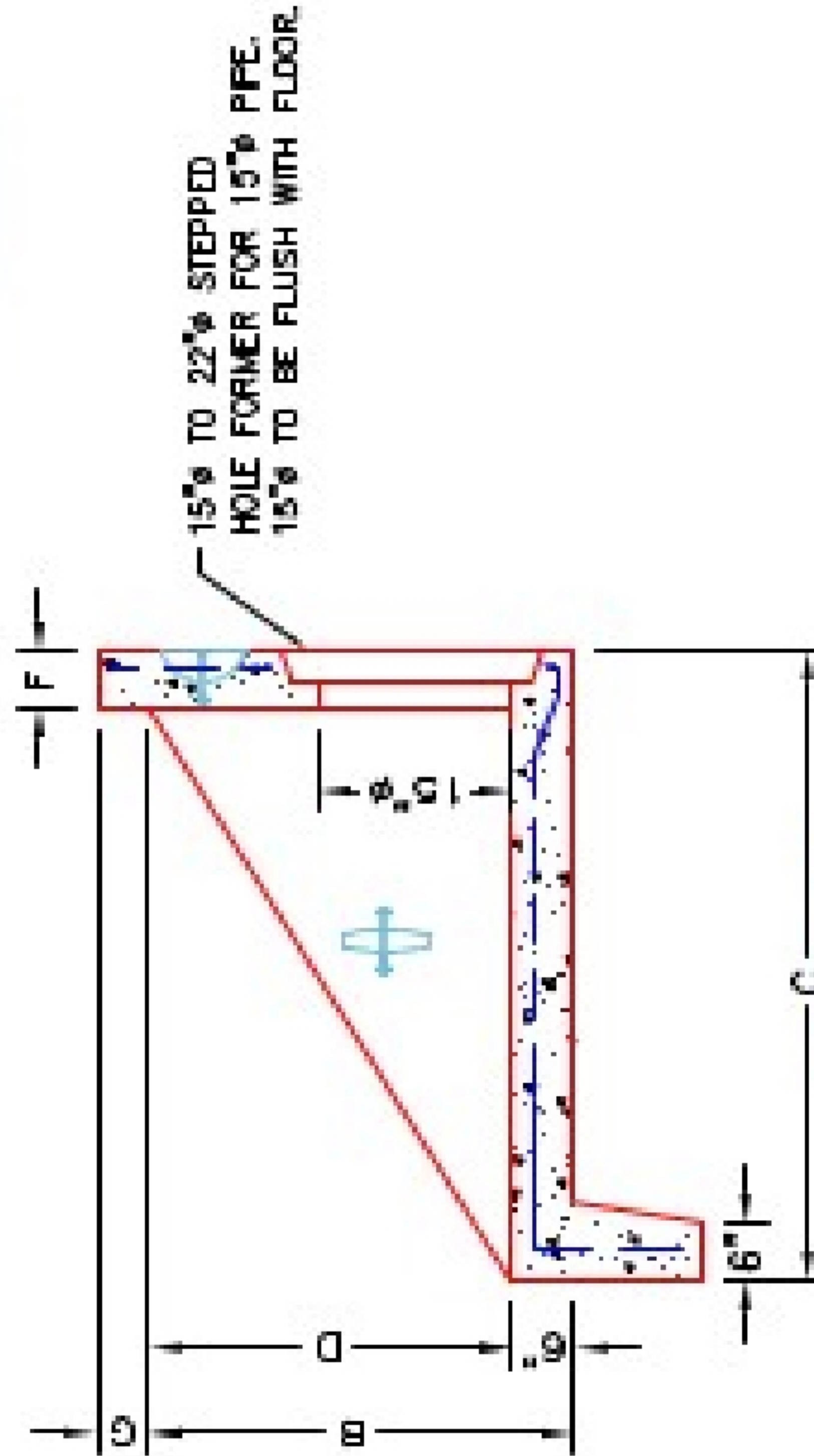

SECTION A-A

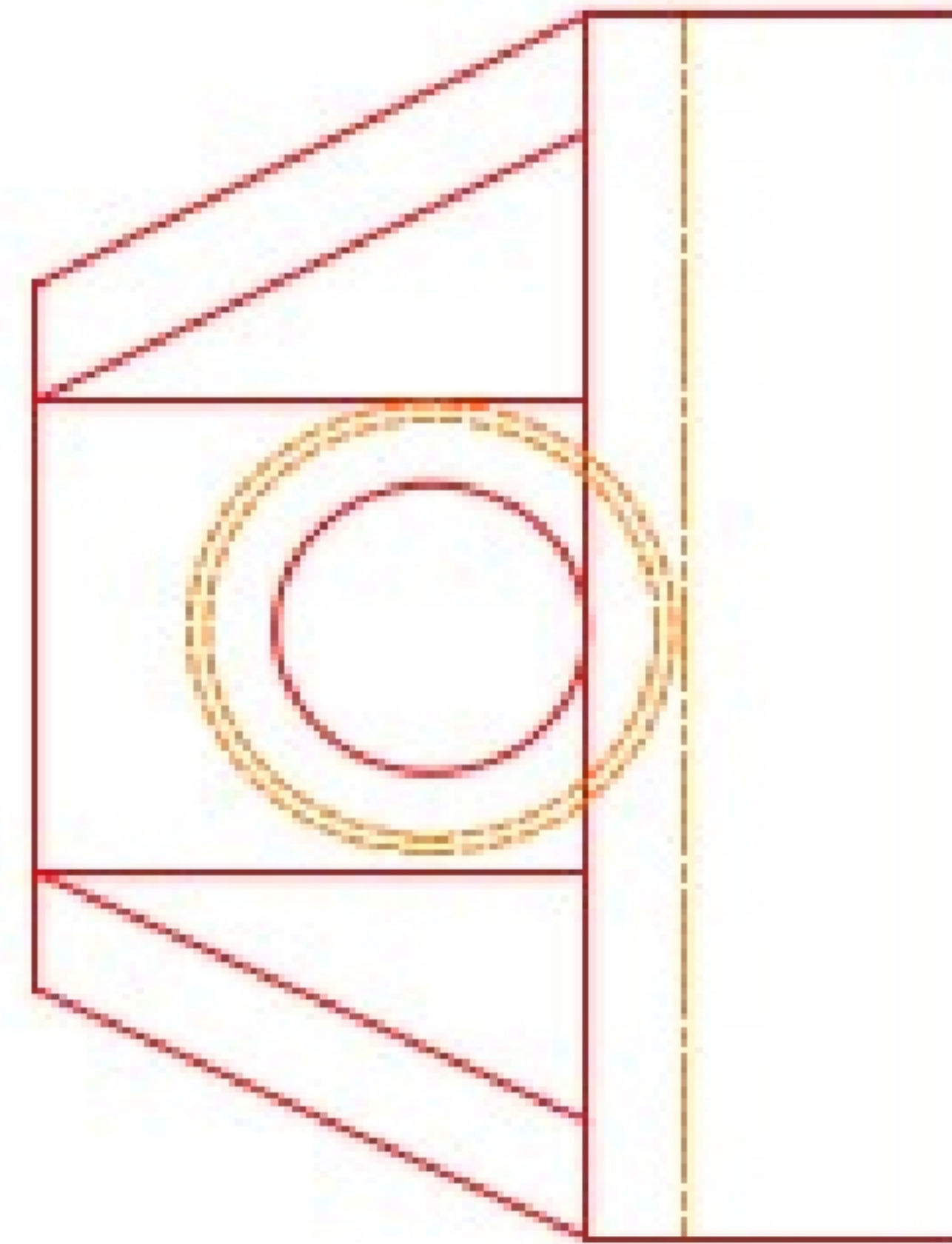

FRONT ELEVATION

~NOTES:

1. CONCRETE: 4500 PSI AT 28 DAYS MIN. STRENGTH.
2. REINFORCING: #4 BAR @ 12" C/C E.W.-GRADE 60, (WITH 2" CONCRETE COVER MINIMUM)
3. REINFORCING BARS TO BE TACK WELDED OR TIED.

PRODUCTION WORK ORDER

PRODUCT I.D.: HWA15	DESCRIPTION: AW WINGED HEADWALL FOR 15" PIPE
PRODUCT VIEW: RIGHT SIDE UP	CUSTOMER: STOCK
PLANT: BEAVER DAM, KY.	PROJECT: STOCK
WEIGHT: 1,630 LBS.	STRUCTURE ID.: STOCK
TOP SECTION JOINT: N/A	SALES ORDER NO: T.B.D.
BASE SECTION JOINT: N/A	CHECK: A. WELLS
QC CHECK INITIALS:	DRAWING: N. RICHARDS
	DATE: 04/06/23
	SCALE: NTS
	PG. 1 of 1

QUALITY CONTROL CHECKLIST

- ALL DIMENSIONS CORRECT.
- LIFTERS INSTALLED.
- STEPPED HF CORRECT SIZE.
- REINFORCING CORRECT.
- CLEARANCE ON REINFORCING CORRECT.
- EDGES CHAMFERED.
- ALL PATCHWORK ACCEPTABLE.

