

Job Name: 25-2310 GOOSE CREEK SUBDIVISION
 Job Location: Hartsville, TN
 Contractor: Hayes Pipe Supply

Plant: Beaver Dam
 2/4/2026 12:36:14 PM

Tech: C.Russ
 PC: A.Chambers



Structure ID: CB-2

P1 BX36960606VF

BOX BASE 6inW, 6inF, Variable Ht F/n

- P3) 28" x 28" - CASTING HEIGHT - 6"
- P2) 36" x 96" - BX FLAT LID 6inW w/(2) 28"x28" HOLES F/F - 6"
- P1) 36" x 96" - BOX BASE 6inW, 6inF, Variable Ht F/n - 51"
- 1) 36" x 96" - Conseal CS-102 1.00"
- 1) 28" x 28" - Conseal CS-102 1.00"
- 4) Hole - 40

0 lb
 1425 lb
 7474 lb
 0 lb
 0 lb
 0 lb

 Structure Total: 8899 lb

Structure Notes:

1. PER ASTM C913 SPECIFICATIONS.
2. CONCRETE = 4,000 PSI AT 28 DAYS.
3. NO STEPS & NO INVERT CHANNEL.
4. CASTING BY OTHERS

REINFORCING PER ASTM A615 (GRADE 60).
 - TOP SLAB (As .62) #5 BARS AT 6" C.C.E.W.
 - WALLS (As .12) #5 BARS AT 12" C.C.E.W.
 - FLOOR (As .12) #5 BARS AT 12" C.C.E.W.

Rim: 477.92' Rim to Invert: 4.99' Slack: 0.38" Sump: 3.5" Step Position:

Position	Elev	Angle	Ext. (cw)	Pipe	Pipe OD	Connector	Hole	Horz Size	Up ()	Offset
Invert 1	472.93'	90°	78"	30" RCP B WALL	37"	Hole 40	40"	40"	0"	24"
Invert 2	472.93'	90°	30"	30" RCP B WALL	37"	Hole 40	40"	40"	0"	-24"
Invert 3	473'	270°	78"	30" RCP B WALL	37"	Hole 40	40"	40"	0.875"	24"
Invert 4	473'	270°	30"	30" RCP B WALL	37"	Hole 40	40"	40"	0.875"	-24"
Invert 5										
Invert 6										
Invert 7										
Invert 8										

RIGHT-SIDE UP VIEW (int. dimensions)

UPSIDE-DOWN VIEW (int. dimenions)

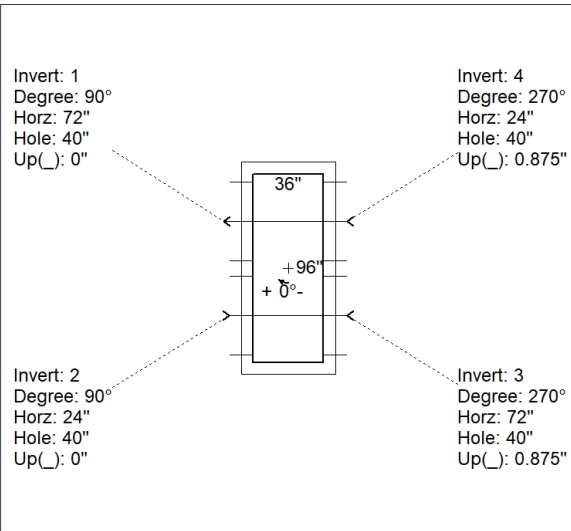

1ST POR (FLOOR) = 2,610 LBS
 2N POUR (WALLS) = 4,864 LBS

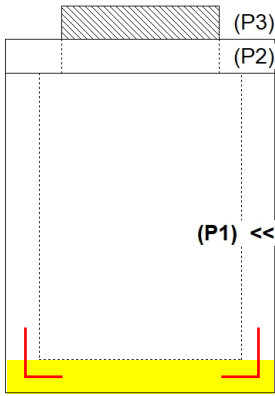

INSIDE WALL DIMENSIONS

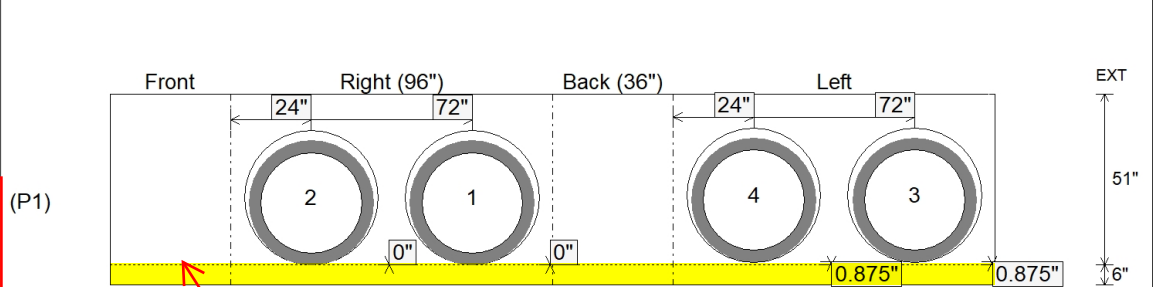

1ST POUR (FLOOR)
 STUB #5 L BARS OUT TOP
 OF FLOOR FOR
 CONNECTING WALLS

CONSEAL CS-231
 BETWEEN FLOOR & WALLS

Coating (Int): Coating (Ext):	Seam Up: Flat Seam Dn: n/a	Wall Thickness: 6" Floor Height: 6"	Height (Int): 51" Height (Ext): 57"	Weight (Net): 7474 lb Volume (Net): 1.91cu.yd
----------------------------------	-------------------------------	--	--	--

Job Name: 25-2310 GOOSE CREEK SUBDIVISION
 Job Location: Hartsville, TN
 Contractor: Hayes Pipe Supply

Plant: Beaver Dam
 2/4/2026 12:36:14 PM

Tech: C.Russ
 PC: A.Chambers



Structure ID: CB-2

P1A BX36960606VF

BOX BASE 6inW, 6inF, Variable Ht F/n

- P3) 28" x 28" - CASTING HEIGHT - 6"
- P2) 36" x 96" - BX FLAT LID 6inW w/(2) 28"x28" HOLES F/F - 6"
- P1) 36" x 96" - BOX BASE 6inW, 6inF, Variable Ht F/n - 51"
- 1) 36" x 96" - Conseal CS-102 1.00"
- 1) 28" x 28" - Conseal CS-102 1.00"
- 4) Hole - 40

0 lb
 1425 lb
 7474 lb
 0 lb
 0 lb
 0 lb

 Structure Total: 8899 lb

Structure Notes:
 1. PER ASTM C913 SPECIFICATIONS.
 2. CONCRETE = 4,000 PSI AT 28 DAYS.
 3. NO STEPS & NO INVERT CHANNEL.
 4. CASTING BY OTHERS

REINFORCING PER ASTM A615 (GRADE 60).
 - TOP SLAB (As .62) #5 BARS AT 6" C.C.E.W.
 - WALLS (As .12) #5 BARS AT 12" C.C.E.W.
 - FLOOR (As .12) #5 BARS AT 12" C.C.E.W.

Rim: 477.92' Rim to Invert: 4.99' Slack: 0.38" Sump: 3.5" Step Position:

Position	Elev	Angle	Ext. (cw)	Pipe	Pipe OD	Connector	Hole	Horz Size	Up ()	Offset
Invert 1	472.93'	90°	78"	30" RCP B WALL	37"	Hole 40	40"	40"	0"	24"
Invert 2	472.93'	90°	30"	30" RCP B WALL	37"	Hole 40	40"	40"	0"	-24"
Invert 3	473'	270°	78"	30" RCP B WALL	37"	Hole 40	40"	40"	0.875"	24"
Invert 4	473'	270°	30"	30" RCP B WALL	37"	Hole 40	40"	40"	0.875"	-24"
Invert 5										
Invert 6										
Invert 7										
Invert 8										

RIGHT-SIDE UP VIEW (int. dimensions)

UPSIDE-DOWN VIEW (int. dimenions)

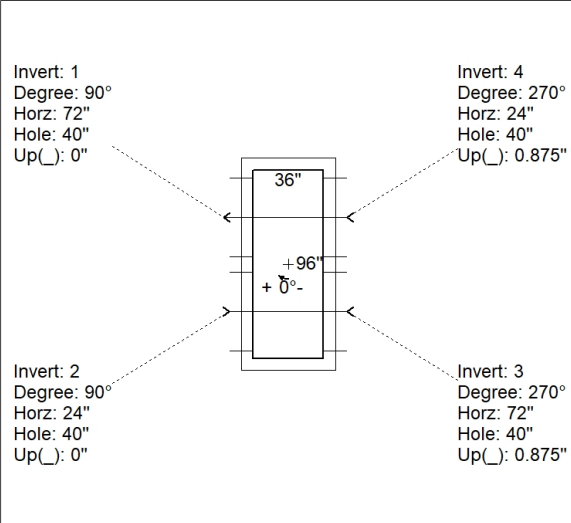

**1ST POR (FLOOR) = 2,610 LBS
 2N POUR (WALLS) = 4,864 LBS**

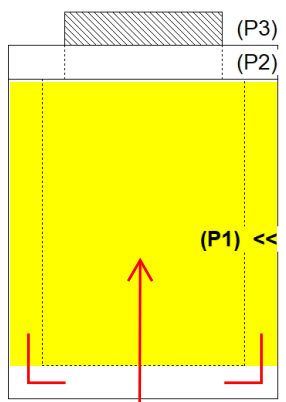

INSIDE WALL DIMENSIONS

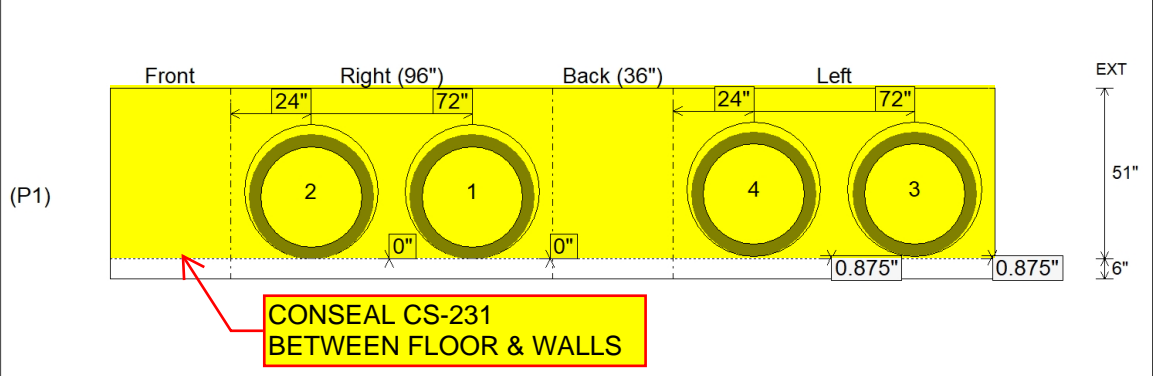

2ND POUR (WALLS)

**CONSEAL CS-231
 BETWEEN FLOOR & WALLS**

Coating (Int): Coating (Ext):	Seam Up: Flat Seam Dn: n/a	Wall Thickness: 6" Floor Height: 6"	Height (Int): 51" Height (Ext): 57"	Weight (Net): 7474 lb Volume (Net): 1.91cu.yd
----------------------------------	-------------------------------	--	--	--