

**FIRST POUR DRAWING  
FLOOR**

Ø2" HOLE IN THE FLOOR FOR GROUNDING ROD

4X CABLE PULLS CAST INTO THE FLOOR

PLASTIC SUMP DISH CAST IN THE CENTER OF THE FLOOR

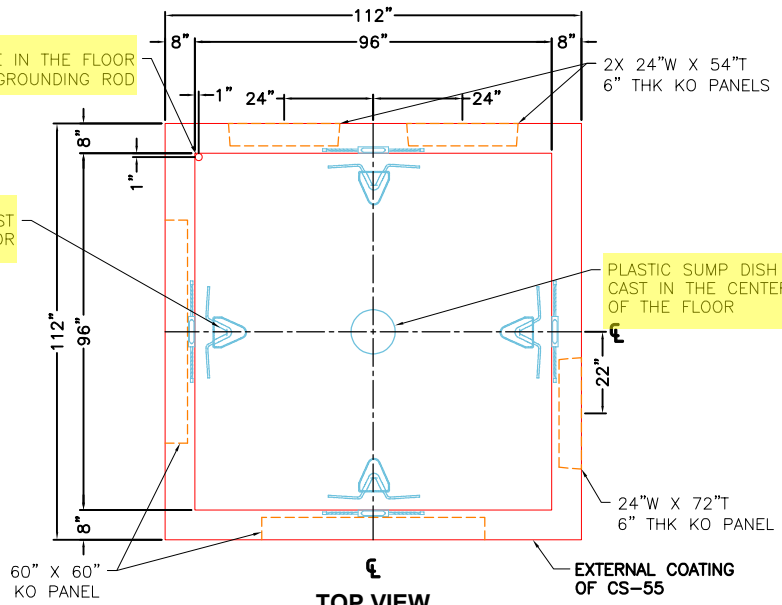

**TOP VIEW**

- GENERAL NOTES:**
1. MANUFACTURED TO ASTM C-913 (LATEST REVISION).
  2. CONCRETE: 5,000 PSI AT 28 DAYS.
  3. REINFORCING: PER ASTM A615 (GRADE 60)  
WALLS - #5 BAR @ 6" C-C E.W.  
FLOOR - #5 BAR @ 10" C-C E.W.
  4. WEIGHT:  
**FIRST POUR = 8,421 LBS**  
SECOND POUR = 23,737 LBS  
THIRD POUR = 1,498 LBS  
TOTAL WEIGHT = 33,656 LBS
  5. CASTING: JR HOE MC-780 PROVIDED BY ICAST.
  6. EXTERNAL COATING OF CS-55 PROVIDED BY ICAST.
  7. 7'-6" AIM TWISTED HOOK LADDER PROVIDED BY ICAST.
  8. FLOOR SLOPE TO DRAIN BY ICAST.
  9. ALL SECTION JOINTS TO BE SEALED W/ CONSEAL CS-102 BUTYL.

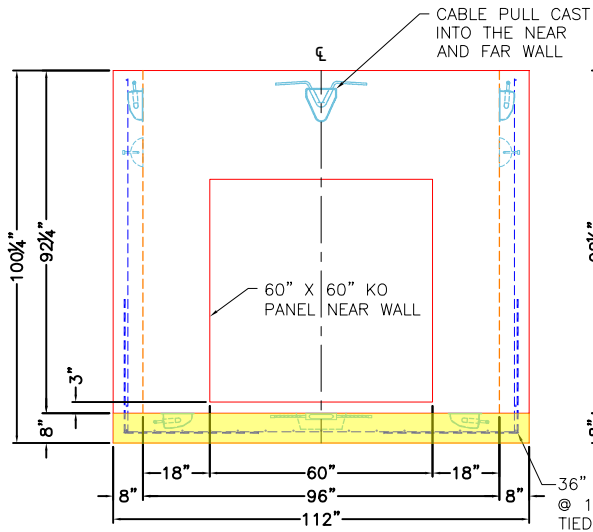

**LEFT VIEW**

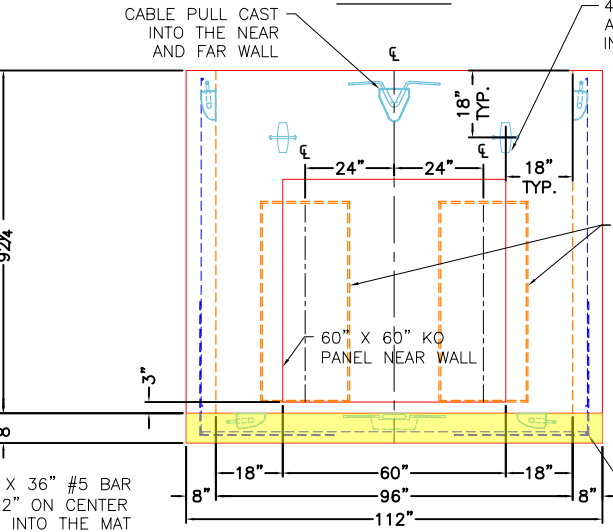

**FRONT VIEW**

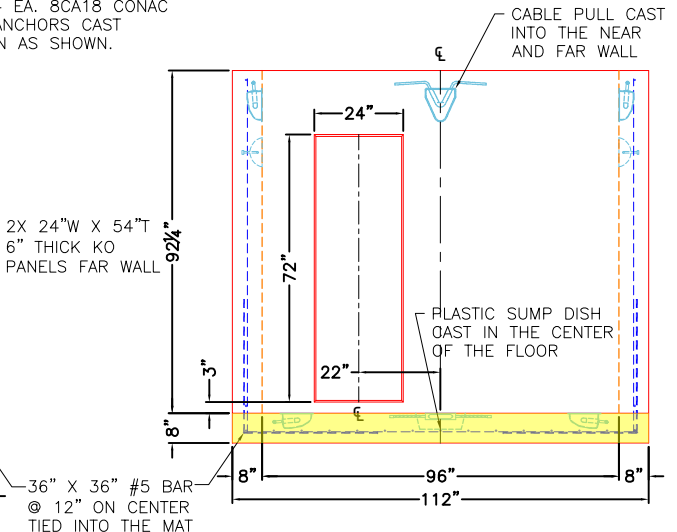

**RIGHT VIEW**

<b>PRODUCTION WORK ORDER</b>		PRODUCT I.D.: BX9696-08BA-VH	DESCRIPTION: 96" X 96" X 92 1/4" TALL VAULT BASE	
	QUALITY CONTROL CHECKLIST	PRODUCT VIEW: RIGHT SIDE UP	CUSTOMER: THE STATE GROUP INDUSTRIAL (USA) LIMITED	
	<input type="checkbox"/> ALL DIMENSIONS CORRECT. <input type="checkbox"/> LIFTERS INSTALLED. <input type="checkbox"/> OPENING CENTERED. <input type="checkbox"/> REINFORCING CORRECT. <input type="checkbox"/> SURFACE QUALITY ACCEPTABLE. <input type="checkbox"/> EDGES CHAMFERED. <input type="checkbox"/> ALL PATCHWORK ACCEPTABLE.	PLANT: BEAVER DAM, KY.	PROJECT: KYMEA CENTER ELECTRICAL MANHOLES	
		WEIGHT: 33,656 LBS.	STRUCTURE: ELECTRICAL MANHOLE 3	
		TOP SECTION JOINT: N/A	ORDER NO: 25-2219	
		BASE SECTION JOINT: N/A	PC: A. CHAMBERS	DRAWING: J. COPPAGE
QC CHECK INITIALS:	DATE: 10/28/25	SCALE: NTS	PG. 1 of 3	

**SECOND POUR DRAWING  
WALLS**

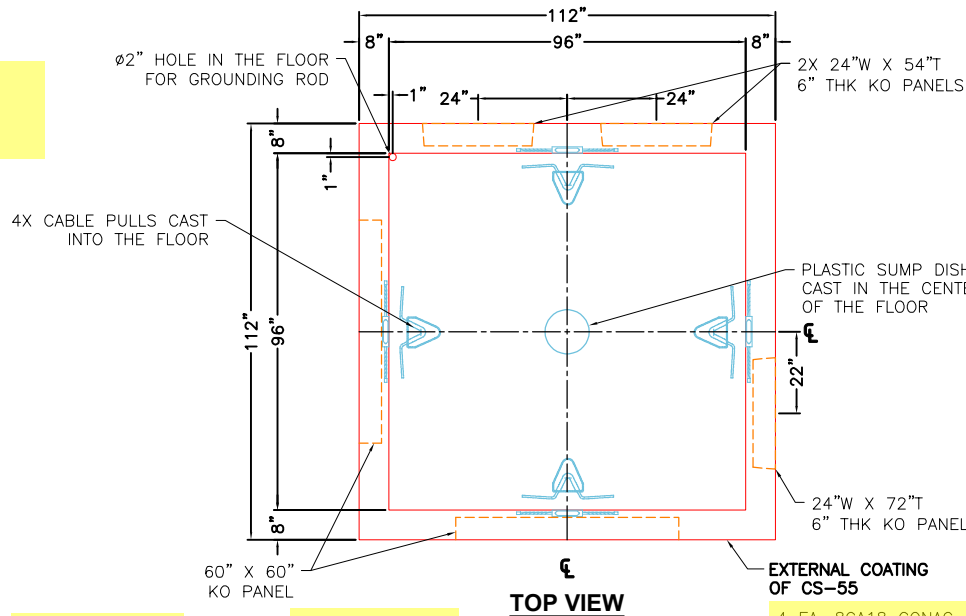

**GENERAL NOTES:**

1. MANUFACTURED TO ASTM C-913 (LATEST REVISION).
2. CONCRETE: 5,000 PSI AT 28 DAYS.
3. REINFORCING: PER ASTM A615 (GRADE 60)  
WALLS - #5 BAR @ 6" C-C E.W.  
FLOOR - #5 BAR @ 10" C-C E.W.
4. WEIGHT:  
FIRST POUR = 8,421 LBS  
**SECOND POUR = 23,737 LBS**  
THIRD POUR = 1,498 LBS  
TOTAL WEIGHT = 33,656 LBS
5. CASTING: JR HOE MC-780 PROVIDED BY ICAST.
6. EXTERNAL COATING OF CS-55 PROVIDED BY ICAST.
7. 7'-6" AIM TWISTED HOOK LADDER PROVIDED BY ICAST.
8. FLOOR SLOPE TO DRAIN BY ICAST.
9. ALL SECTION JOINTS TO BE SEALED W/ CONSEAL CS-102 BUTYL.

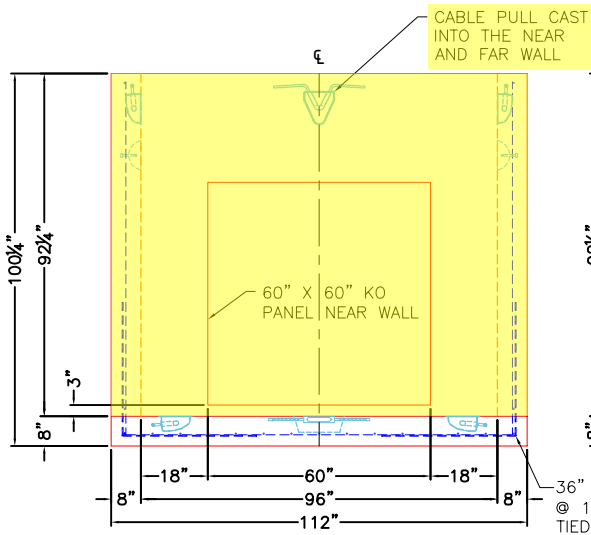

**LEFT VIEW**

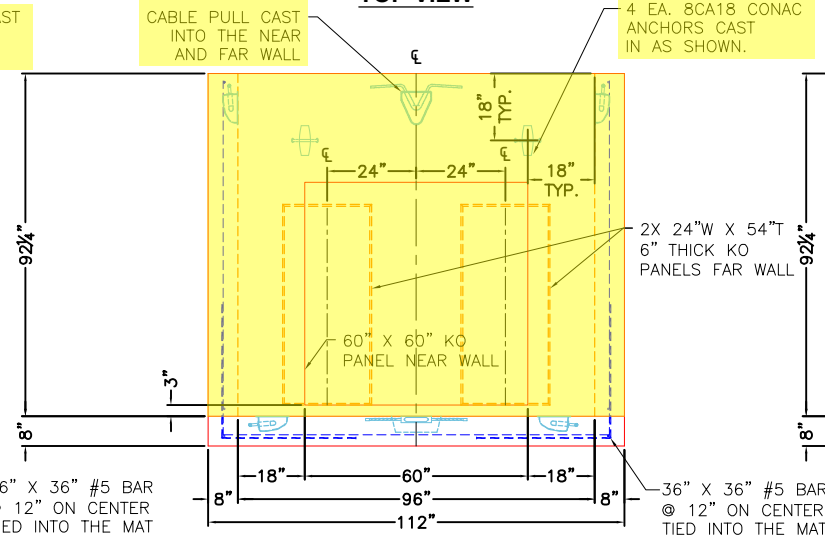

**FRONT VIEW**

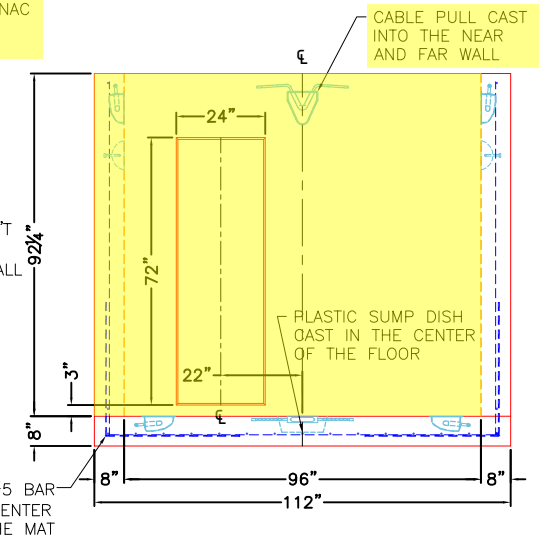

**RIGHT VIEW**

**PRODUCTION WORK ORDER**

PRODUCT I.D.: BX9696-08BA-VH

DESCRIPTION: 96" X 96" X 92 1/4" TALL VAULT BASE



**QUALITY CONTROL CHECKLIST**

- ALL DIMENSIONS CORRECT.
- LIFTERS INSTALLED.
- OPENING CENTERED.
- REINFORCING CORRECT.
- SURFACE QUALITY ACCEPTABLE.
- EDGES CHAMFERED.
- ALL PATCHWORK ACCEPTABLE.

PRODUCT VIEW: RIGHT SIDE UP

CUSTOMER: THE STATE GROUP INDUSTRIAL (USA) LIMITED

PLANT: BEAVER DAM, KY.

PROJECT: KYMEA CENTER ELECTRICAL MANHOLES

WEIGHT: 33,656 LBS.

STRUCTURE: ELECTRICAL MANHOLE 3

TOP SECTION JOINT: N/A

ORDER NO: 25-2219

BASE SECTION JOINT: N/A

PC: A. CHAMBERS

DRAWING: J. COPPAGE

QC CHECK INITIALS:

DATE: 10/28/25

SCALE: NTS

PG. 2 of 3

**THIRD POUR DRAWING**  
**SLOPE TO SUMP PAN**

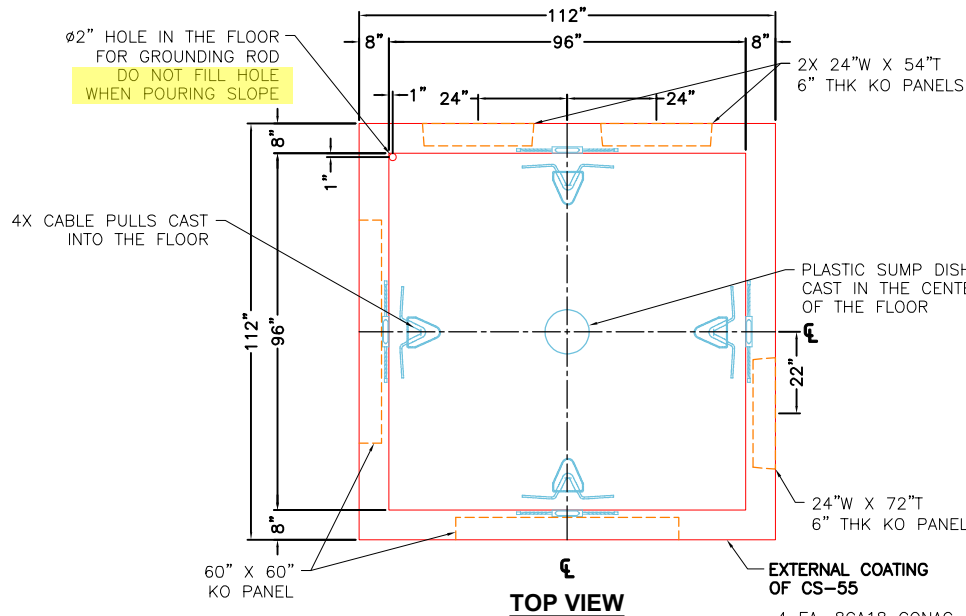

**GENERAL NOTES:**

1. MANUFACTURED TO ASTM C-913 (LATEST REVISION).
2. CONCRETE: 5,000 PSI AT 28 DAYS.
3. REINFORCING: PER ASTM A615 (GRADE 60)  
WALLS - #5 BAR @ 6" C-C E.W.  
FLOOR - #5 BAR @ 10" C-C E.W.
4. WEIGHT:  
FIRST POUR = 8,421 LBS  
SECOND POUR = 23,737 LBS  
THIRD POUR = 1,498 LBS  
TOTAL WEIGHT = 33,656 LBS
5. CASTING: JR HOE MC-780 PROVIDED BY ICAST.
6. EXTERNAL COATING OF CS-55 PROVIDED BY ICAST.
7. 7'-6" AIM TWISTED HOOK LADDER PROVIDED BY ICAST.
8. FLOOR SLOPE TO DRAIN BY ICAST.
9. ALL SECTION JOINTS TO BE SEALED W/ CONSEAL CS-102 BUTYL.

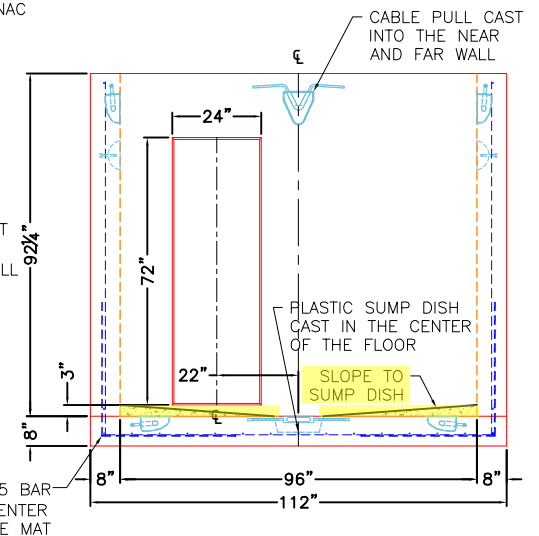
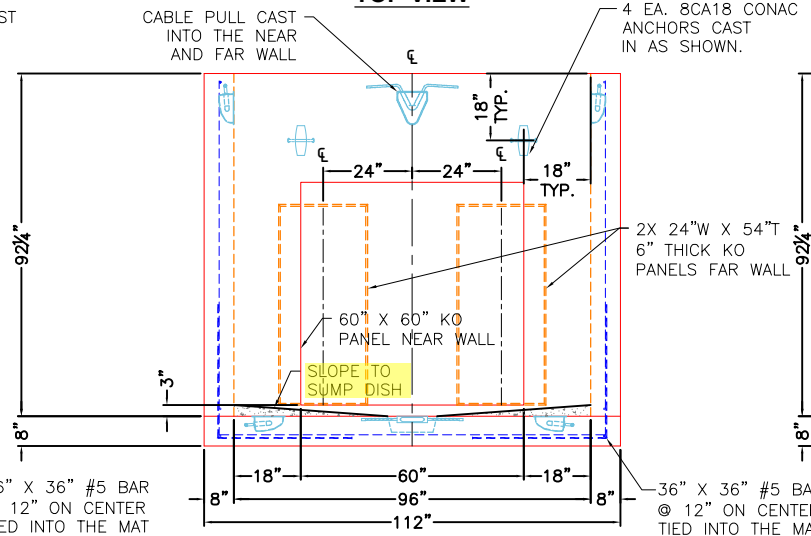
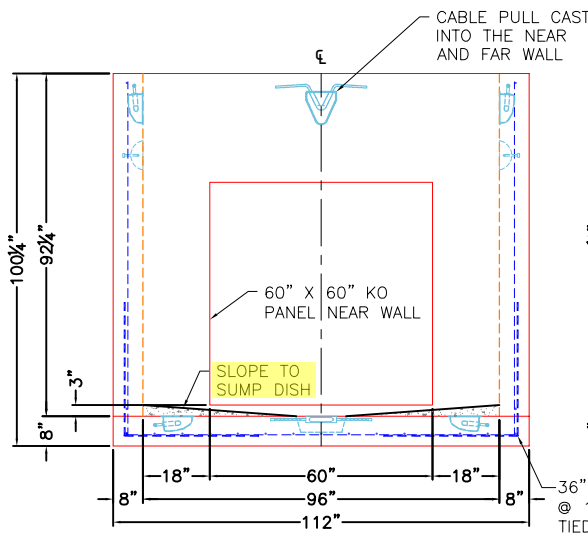

**PRODUCTION WORK ORDER**

PRODUCT I.D.: BX9696-08BA-VH

DESCRIPTION: 96" X 96" X 92 1/4" TALL VAULT BASE



**QUALITY CONTROL CHECKLIST**

- ALL DIMENSIONS CORRECT.
- LIFTERS INSTALLED.
- OPENING CENTERED.
- REINFORCING CORRECT.
- SURFACE QUALITY ACCEPTABLE.
- EDGES CHAMFERED.
- ALL PATCHWORK ACCEPTABLE.

PRODUCT VIEW: RIGHT SIDE UP

CUSTOMER: THE STATE GROUP INDUSTRIAL (USA) LIMITED

PLANT: BEAVER DAM, KY.

PROJECT: KYMEA CENTER ELECTRICAL MANHOLES

WEIGHT: 33,656 LBS.

STRUCTURE: ELECTRICAL MANHOLE 3

TOP SECTION JOINT: N/A

ORDER NO: 25-2219

BASE SECTION JOINT: N/A

PC: A. CHAMBERS

DRAWING: J. COPPAGE

QC CHECK INITIALS:

DATE: 10/28/25

SCALE: NTS

PG. 3 of 3