

Job Name: 25-2216 Lock 4 Road Sewer Addition
 Job Location: Gallatin, TN
 Contractor: Endesol, Inc.

Plant: Beaver Dam
 11/19/2025 11:46:34 AM

Tech: J. Coppage
 PC: E. Bradley



Structure ID: Wet Well

P1 MH072BAEVF-CDARED

MH BASE EF Cust. Ht. 12"F (8"EF =102"OD) w/ ConBlock CDA RED

- P3) 72" - MH RISER Custom Ht, w/ConBlock-CDA Red - 30" 4373 lb
- P2) 72" - MH RISER Custom Ht, w/ConBlock-CDA Red - 84" 12087 lb
- P1) 72" - MH BASE EF Cust. Ht. 12"F (8"EF =102"OD) w/ ConBlock CDA RED - 74" 19016 lb
- 1) JOINT WRAP - 0.065"x6"x50" CONSEAL CS212 0 lb
- 1) JOINT WRAP PRIMER - CONSEAL CS-75 (1 gal.) 0 lb
- 1) This Structure Includes a Cast-in Item 0 lb
- 1) SECONDARY POUR 0 lb
- 3) 72" - Conseal CS-102 1.00" (Double) 0 lb
- 2) Hole - 8 0 lb
- 1) PSX - 8QRS-S NYLO 6 lb
- 1) PSX - 12-08 NYLO 8 lb
- 11) MH Step ML-10-TDS-NCR - 10" 0 lb

Structure Notes:
 1. PER ASTM C478 SPECIFICATIONS.
 2. CONCRETE = 4,000 PSI AT 28 DAYS.
 3. REINFORCING PER ASTM A615 (GRADE 60).
 - TOP SLAB (As .31) #5 BARS AT 6" C.C.E.W.
 - RISER/WALLS (As .12)
 - FLOOR (As .37) #5 BARS AT 10" C.C.E.W.

FIRST POUR DRAWING

Structure Total: 35491 lb

WEIGHTS:
FIRST POUR - 16,637 LBS.
SECOND POUR - 2,379 LBS.
TOTAL - 19,016 LBS.

Rim: 452' Rim to Invert: 8.74' Slack: 10" Sump: 93.12" Step Position: 90

Position	Elev	Angle	Ext. (cw)	Pipe	Pipe OD	Connector	Hole	Horz Size	Up (L)	Offset
Invert 1										
Invert 2										
Invert 3										
Invert 4										
Invert 5										
Invert 6										
Invert 7										
Invert 8										

RIGHT-SIDE UP VIEW (int. dimensions)

UPSIDE-DOWN VIEW (int. dimenions)

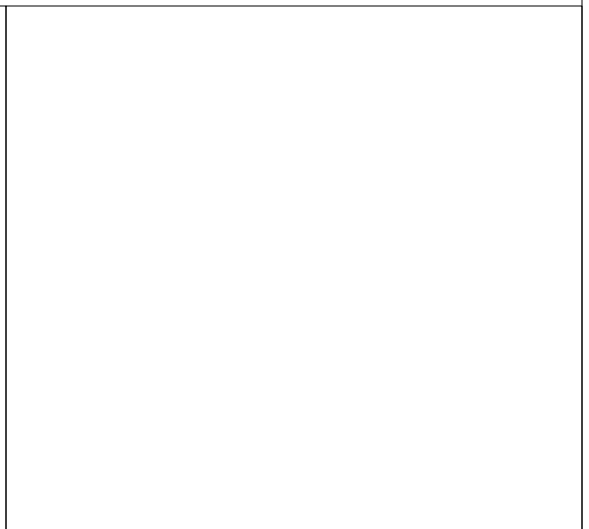
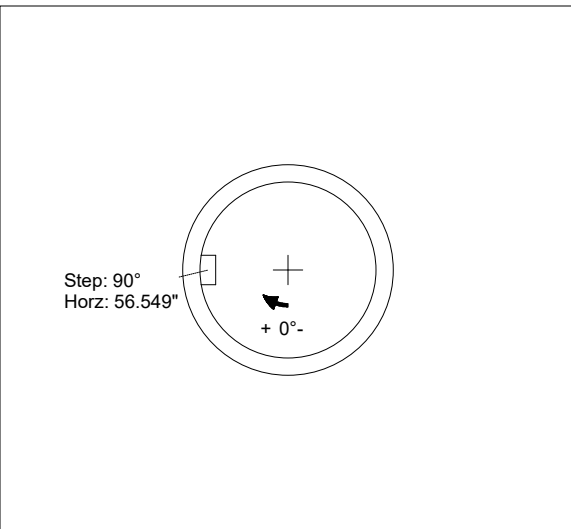
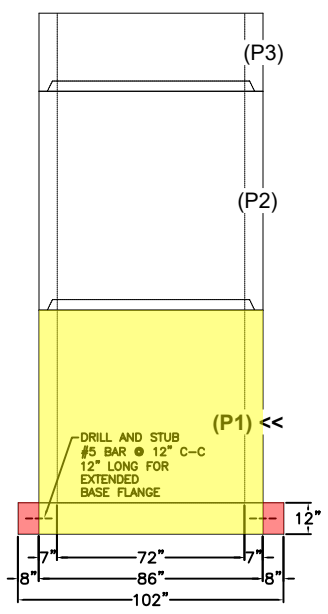

INSIDE WALL DIMENSIONS

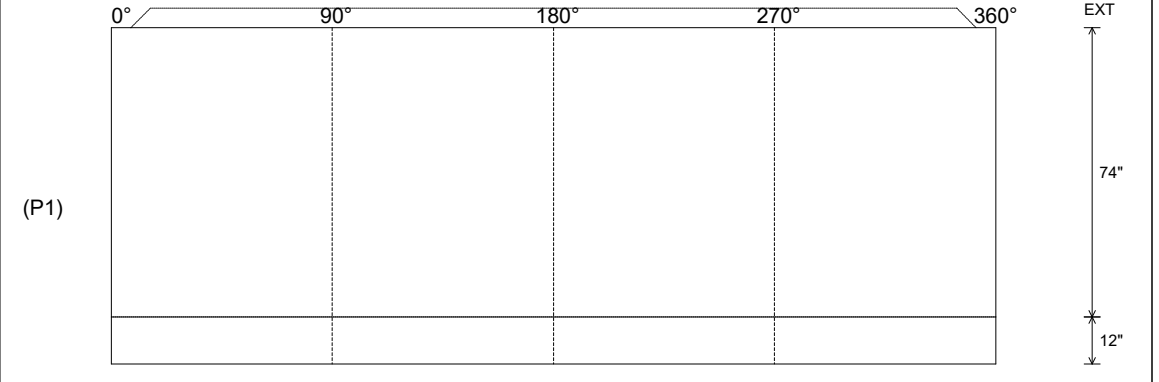

Coating (Int): Coating (Ext):	Seam Up: Tongue Seam Dn: n/a	Wall Thickness: 7" Floor Height: 12"	Height (Int): 74" Height (Ext): 86"	Weight (Net): 19016 lb Volume (Net): 4.86cu.yd
----------------------------------	---------------------------------	---	--	---

Job Name: 25-2216 Lock 4 Road Sewer Addition
 Job Location: Gallatin, TN
 Contractor: Endesol, Inc.

Plant: Beaver Dam
 11/19/2025 11:46:34 AM

Tech: J. Coppage
 PC: E. Bradley



Structure ID: Wet Well

P1 MH072BAEVF-CDARED

MH BASE EF Cust. Ht. 12"F (8"EF =102"OD) w/ ConBlock CDA RED

- P3) 72" - MH RISER Custom Ht, w/ConBlock-CDA Red - 30" 4373 lb
- P2) 72" - MH RISER Custom Ht, w/ConBlock-CDA Red - 84" 12087 lb
- P1) 72" - MH BASE EF Cust. Ht. 12"F (8"EF =102"OD) w/ ConBlock CDA RED - 74" 19016 lb
- 1) JOINT WRAP - 0.065"x6"x50" CONSEAL CS212 0 lb
- 1) JOINT WRAP PRIMER - CONSEAL CS-75 (1 gal.) 0 lb
- 1) This Structure Includes a Cast-in Item 0 lb
- 1) SECONDARY POUR 0 lb
- 3) 72" - Conseal CS-102 1.00" (Double) 0 lb
- 2) Hole - 8 0 lb
- 1) PSX - 8QRS-S NYLO 6 lb
- 1) PSX - 12-08 NYLO 8 lb
- 11) MH Step ML-10-TDS-NCR - 10" 0 lb

Structure Total: 35491 lb

Structure Notes:

1. PER ASTM C478 SPECIFICATIONS.
2. CONCRETE = 4,000 PSI AT 28 DAYS.
3. REINFORCING PER ASTM A615 (GRADE 60).
 - TOP SLAB (As .31) #5 BARS AT 6" C.C.E.W.
 - RISER/WALLS (As .12)
 - FLOOR (As .37) #5 BARS AT 10" C.C.E.W.

SECOND POUR DRAWING

WEIGHTS:

FIRST POUR - 16,637 LBS.

SECOND POUR - 2,379 LBS.

TOTAL - 19,016 LBS.

Rim: 452' Rim to Invert: 8.74' Slack: 10" Sump: 93.12" Step Position: 90

Position	Elev	Angle	Ext. (cw)	Pipe	Pipe OD	Connector	Hole	Horz Size	Up (L)	Offset
Invert 1										
Invert 2										
Invert 3										
Invert 4										
Invert 5										
Invert 6										
Invert 7										
Invert 8										

RIGHT-SIDE UP VIEW (int. dimensions)

UPSIDE-DOWN VIEW (int. dimenions)

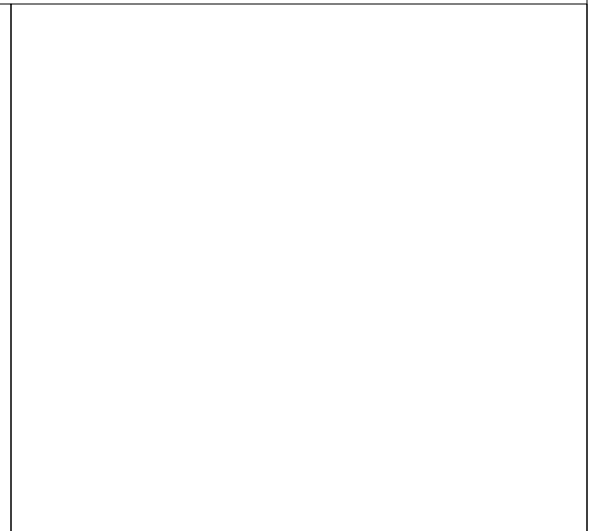
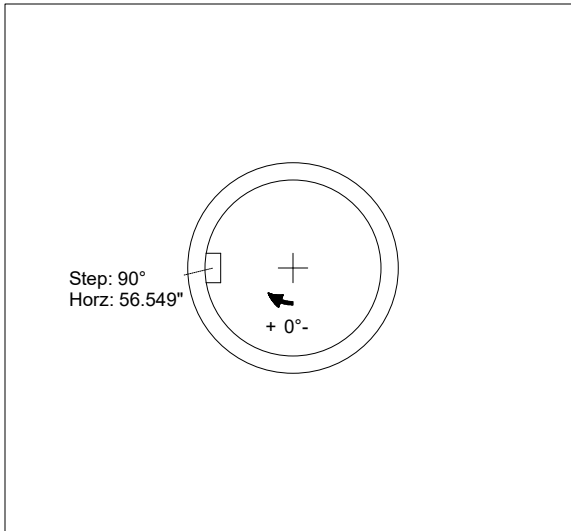
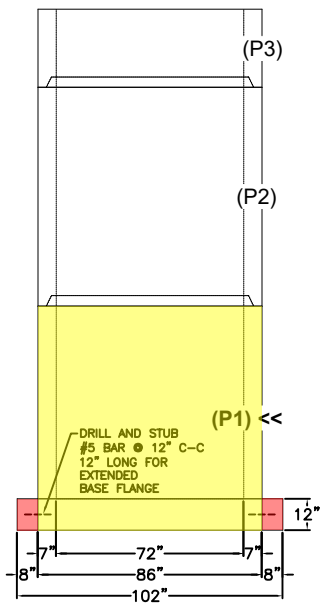

INSIDE WALL DIMENSIONS

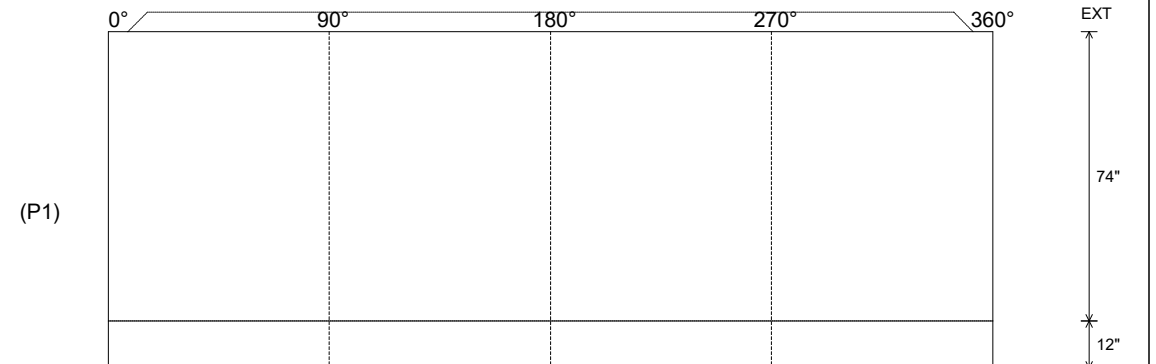

Coating (Int):
 Coating (Ext):

Seam Up: Tongue
 Seam Dn: n/a

Wall Thickness: 7"
 Floor Height: 12"

Height (Int): 74"
 Height (Ext): 86"

Weight (Net): 19016 lb
 Volume (Net): 4.86cu.yd