

Job Name: 25-2059 New Vista Expansion
Job Location: Danville, KY
Contractor: Louisville Paving and Construction

PC: J. Jarvis
 TECH: J. Coppage
 Plant: Beaver Dam



Structure ID: **OCS**
 Spec: Storm
 Type: BX 8inW, 8inF
 Size: 24" x 24"

Rim: 967.7'
 Invert: 964'
 Rim to Invert: 3.7'

Sump: 0"
 Floor (Top): 964'
 Floor Height: 8"

Floor (Bot): 963.333'
 Overall Height: 4.333'
 Slack: 0.4"

Structure Notes:

- TRASHRACK LFS-2424 PROVIDED BY ICAST.
- PER ASTM C913 SPECIFICATIONS.
- CONCRETE = 4,000 PSI AT 28 DAYS.
- REINFORCING PER ASTM A615 (GRADE 60).
 - TOP SLAB (As .62) #5 BARS AT 6" C.C.E.W.
 - WALLS (As .12) #5 BARS AT 12" C.C.E.W.
 - FLOOR (As .12) #5 BARS AT 12" C.C.E.W.

STRUCTURE SUMMARY:

P2) 24" x 24" - CASTING HEIGHT - 0"	0 lb
P1) 24" x 24" - BOX BASE 8inW, 8inF, Variable Ht - 44"	4463 lb
1) CASTING - TRASHRACKS LFS-2424-P SQ. Flush Mount Grate	59 lb
1) 24" x 24" - SGL 1"x14.5' Butyl	0 lb
1) Hole - 22	0 lb
1) Hole - 8	0 lb
1) Weir - 11"x14.4"	0 lb
Structure Total:	4522 lb

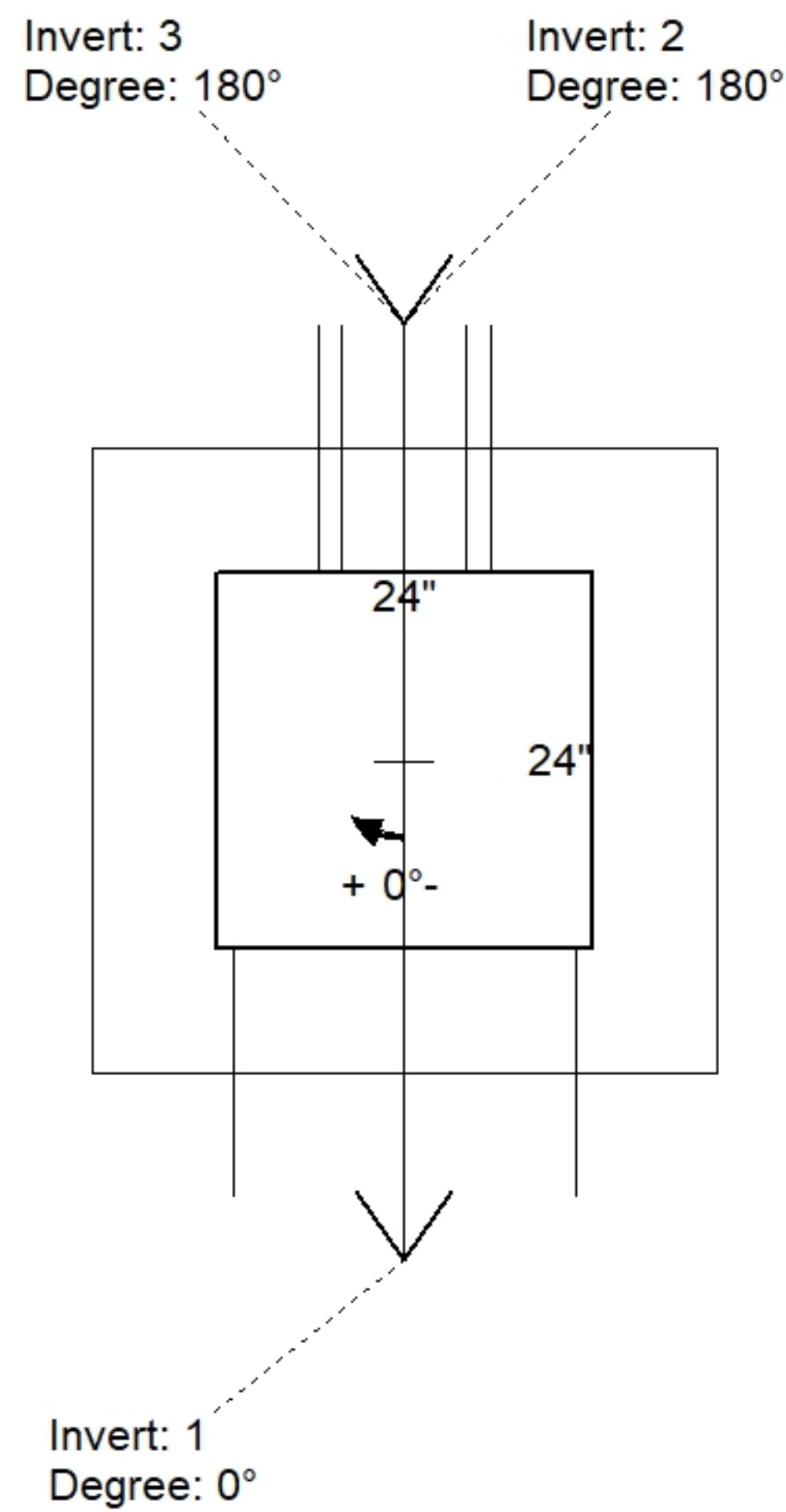

Position	Elev	Angle	Pipe	Pipe OD	Hole	Connector	Up (")	Ref
Rim	967.7'							
Reducer								
Invert 1	964'	0°	15" RCP B WALL	19.5"	22"	Hole 22	-2.25"	P1
Invert 2	964'	180°	6" PVC SCH40	6.625"	8"	Hole 8	-0.297"	P1
Invert 3	966.5'	180°	11" x 14.4" Weir	11" x 14.4"	11" x 14.4"	Weir 11"x14.4"	30"	P1
Invert 4								
Invert 5								
Invert 6								
Invert 7								
Invert 8								

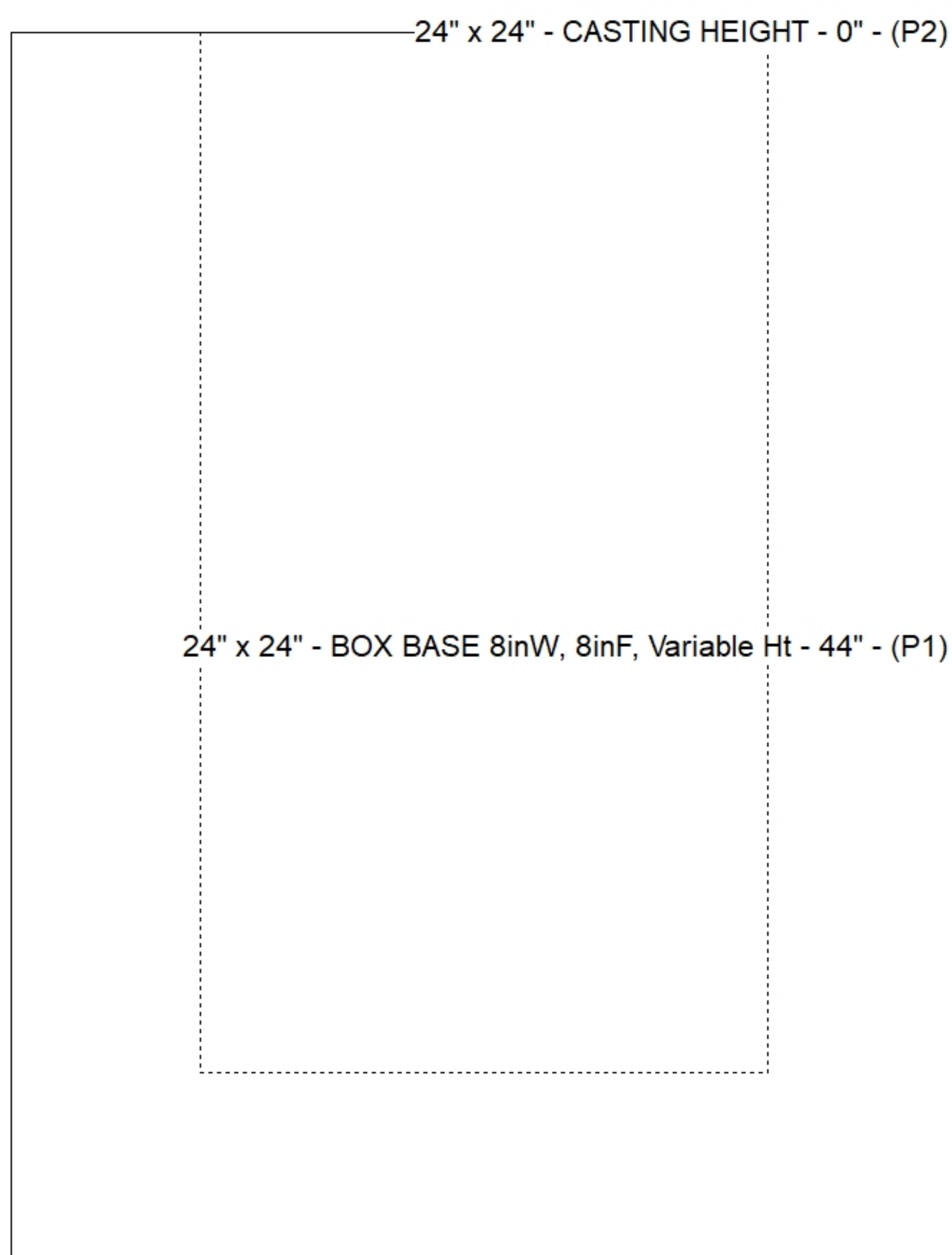

Default - Interior Dimensions

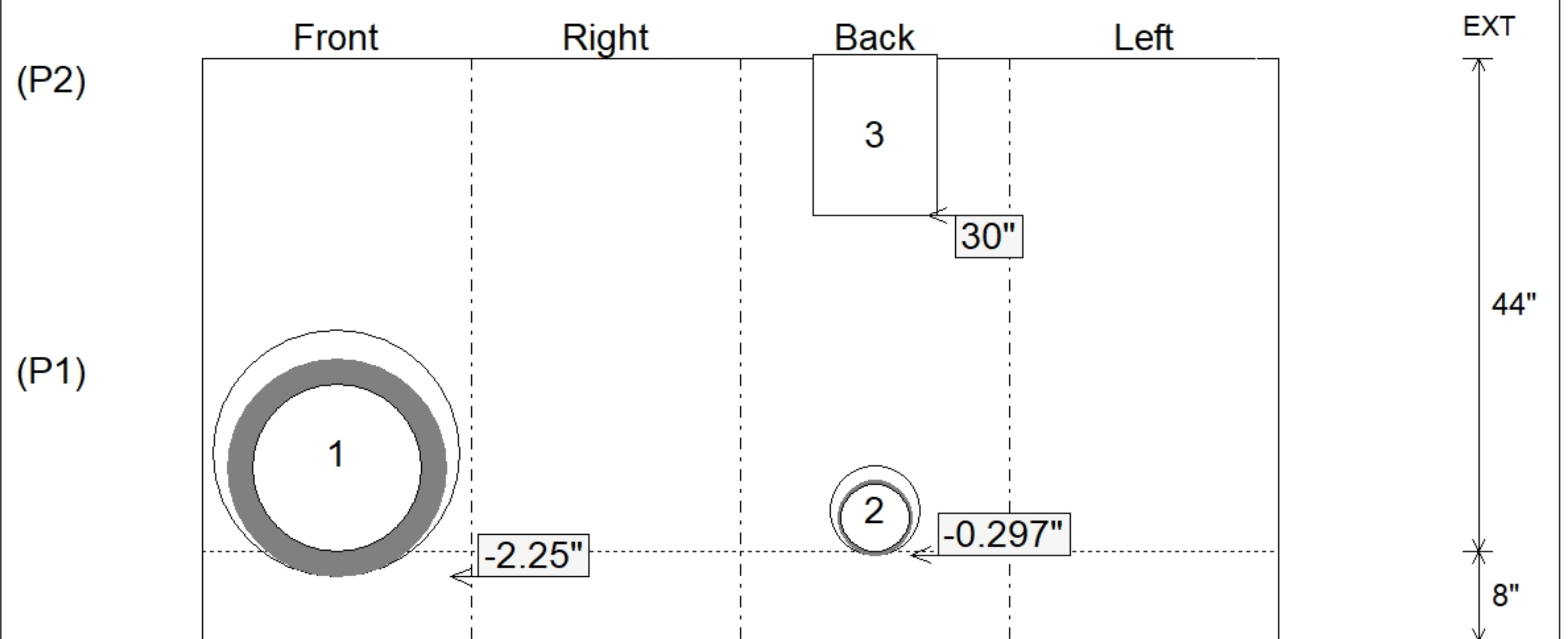

Submittal Drawing
 10/27/2025 7:55:51 AM

SUBMITTAL
 APPROVED BY: