

Job Name: 25-1719 2nd St Sanitary Sewer
 Job Location: Nashville, TN
 Contractor: Garney Companies, Inc.

Plant: Beaver Dam, KY
 12/18/2025 7:56:37 AM

Tech: Evan Niles
 PC: Jay Jarvis



Structure ID: SSMH-9 (Base Rev)

P1 MH072BAVFCDARED

MH BASE Custom Ht, w/ConBlock-CDA Red T/n

- P6) 24" - CASTING HEIGHT - 7"
- P5) 72" - MH FLAT TOP w/24" Hole ECC w/ConBlock-CDA Red F/G - 15"
- P4) 72" - MH RISER Custom Ht, w/ConBlock-CDA Red T/G - 22"
- P3) 72" - MH RISER Custom Ht, w/ConBlock-CDA Red T/G - 72"
- P2) 72" - MH RISER Custom Ht, w/ConBlock-CDA Red T/G - 72"
- P1) 72" - MH BASE Custom Ht, w/ConBlock-CDA Red T/n - 81"
- 1) JOINT WRAP - 0.065"x6"x50' CONSEAL CS212
- 1) JOINT WRAP PRIMER - CONSEAL CS-75 (1 gal.)
- 1) ADMIXTURE CONBLOCK CDA RED
- 1) 72" - MH INVERT CHANNEL w/ConBlock-CDA Red - FULL HEIGHT
- 1) CASTING - JBS 1150 F/C SANITARY
- 4) 72" - Conseal CS-102 1.00" (Double)
- 1) A-Lok - 1430
- 1) PSX - 16M NYLO
- 1) A-Lok - 1235
- 21) MH Step ML-10-TDS-NCR - 10"

0 lb
 5097 lb
 3207 lb
 10496 lb
 10496 lb
 13774 lb
 0 lb
 0 lb
 0 lb
 5422 lb
 250 lb
 0 lb
 1 lb
 8 lb
 1 lb
 0 lb
 Structure Total: 48753 lb

- Structure Notes:**
1. PER ASTM C-478 SPECS
 2. CONCRETE: 4,000 PSI AT 28 DAYS
 3. REINFORCEMENT: PER ASTM A615
 4. INVERT CHANNEL REQUIRED
 5. CONBLOCK CDA RED ADMIXTURE REQUIRED
 6. STEPS AT 270 DEGREES
 7. CASTING: JBS 1150 "SANITARY" BY ICAST (ALREADY ON SITE)

NOTE: BASE REMAKE PER 12-17-25 REVISIONS

Rim: 423.11' Rim to Invert: 22.33' Slack: 0.96" Sump: 2" Step Position: 270°

Position	Elev	Angle	Ext. (cw)	Pipe	Pipe OD	Connector	Hole	Horz Size	Up ()	Offset
Invert 1	400.78'	0°	0"	42" DI	44.5"	A-Lok 1430	46"	49.9"	0"	0"
Invert 2	403.95'	92°	69.045"	12" DI	13"	PSX 16M NYLO	16"	16.135"	38.04"	0"
Invert 3	400.95'	179°	134.338"	36" DI	38.5"	A-Lok 1235	39.88"	42.266"	2.1"	0"
Invert 4										
Invert 5										
Invert 6										
Invert 7										
Invert 8										

RIGHT-SIDE UP VIEW (int. dimensions)

UPSIDE-DOWN VIEW (int. dimensions)

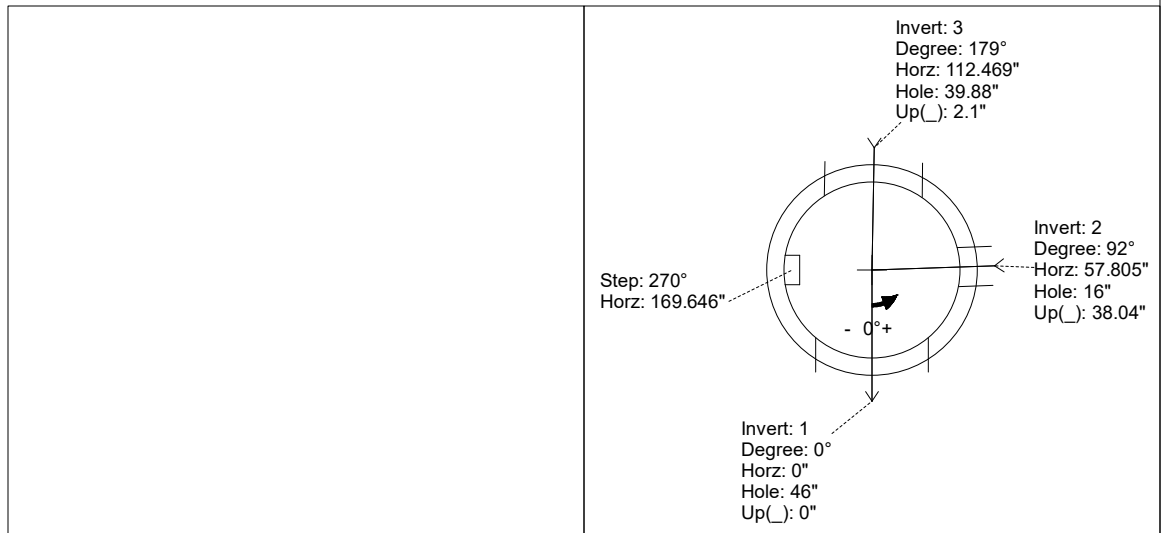
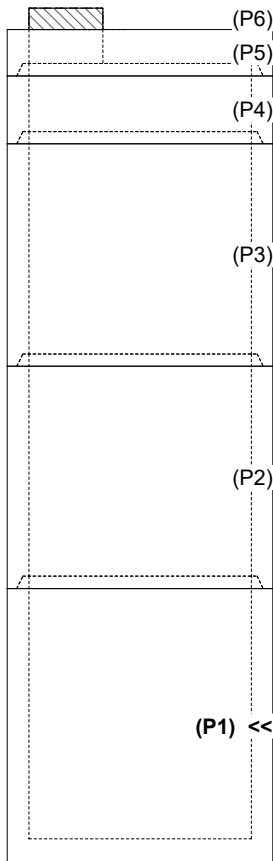

INSIDE WALL DIMENSIONS

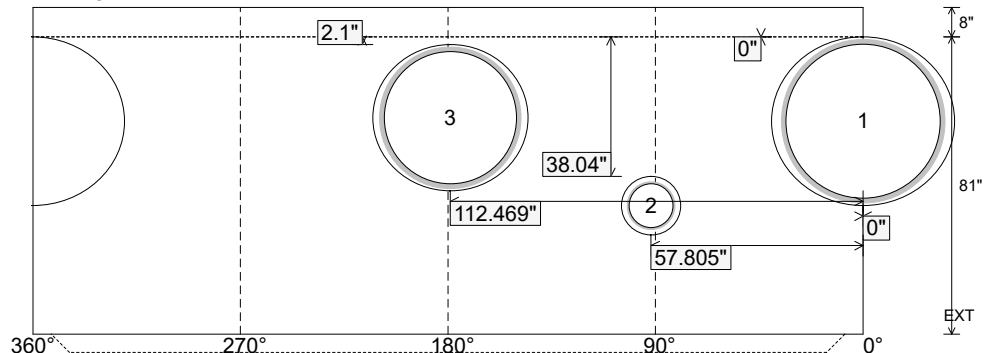

Coating (Int):
 Coating (Ext):

Seam Up: Tongue
 Seam Dn: n/a

Wall Thickness: 7"
 Floor Height: 8"

Height (Int): 81"
 Height (Ext): 89"

Weight (Net): 13774 lb
 Volume (Net): 3.52cu.yd

Job Name: 25-1719 2nd St Sanitary Sewer
 Job Location: Nashville, TN
 Contractor: Garney Companies, Inc.

Plant: Beaver Dam, KY
 12/18/2025 7:56:37 AM

Tech: Evan Niles
 PC: Jay Jarvis



Structure ID: SSMH-9 (Base Rev)

P1 MH072BAVFCDARED

MH BASE Custom Ht, w/ConBlock-CDA Red T/n

- P6) 24" - CASTING HEIGHT - 7"
- P5) 72" - MH FLAT TOP w/24" Hole ECC w/ConBlock-CDA Red F/G - 15"
- P4) 72" - MH RISER Custom Ht, w/ConBlock-CDA Red T/G - 22"
- P3) 72" - MH RISER Custom Ht, w/ConBlock-CDA Red T/G - 72"
- P2) 72" - MH RISER Custom Ht, w/ConBlock-CDA Red T/G - 72"
- P1) 72" - MH BASE Custom Ht, w/ConBlock-CDA Red T/n - 81"
- 1) JOINT WRAP - 0.065"x6"x50' CONSEAL CS212
- 1) JOINT WRAP PRIMER - CONSEAL CS-75 (1 gal.)
- 1) ADMIXTURE CONBLOCK CDA RED
- 1) 72" - MH INVERT CHANNEL w/ConBlock-CDA Red - FULL HEIGHT
- 1) CASTING - JBS 1150 F/C SANITARY
- 4) 72" - Conseal CS-102 1.00" (Double)
- 1) A-Lok - 1430
- 1) PSX - 16M NYLO
- 1) A-Lok - 1235
- 21) MH Step ML-10-TDS-NCR - 10"

0 lb
 5097 lb
 3207 lb
 10496 lb
 10496 lb
 13774 lb
 0 lb
 0 lb
 0 lb
 5422 lb
 250 lb
 0 lb
 1 lb
 8 lb
 1 lb
 0 lb
 Structure Total: 48753 lb

- Structure Notes:**
1. PER ASTM C-478 SPECS
 2. CONCRETE: 4,000 PSI AT 28 DAYS
 3. REINFORCEMENT: PER ASTM A615
 4. INVERT CHANNEL REQUIRED
 5. CONBLOCK CDA RED ADMIXTURE REQUIRED
 6. STEPS AT 270 DEGREES
 7. CASTING: JBS 1150 "SANITARY" BY ICAST (ALREADY ON SITE)

NOTE: BASE REMAKE PER 12-17-25 REVISIONS

Rim: 423.11' Rim to Invert: 22.33' Slack: 0.96" Sump: 2" Step Position: 270°

Position	Elev	Angle	Ext. (cw)	Pipe	Pipe OD	Connector	Hole	Horz Size	Up ()	Offset
Invert 1	400.78'	0°	0"	42" DI	44.5"	A-Lok 1430	46"	49.9"	0"	0"
Invert 2	403.95'	92°	69.045"	12" DI	13"	PSX 16M NYLO	16"	16.135"	38.04"	0"
Invert 3	400.95'	179°	134.338"	36" DI	38.5"	A-Lok 1235	39.88"	42.266"	2.1"	0"
Invert 4										
Invert 5										
Invert 6										
Invert 7										
Invert 8										

RIGHT-SIDE UP VIEW (int. dimensions)

UPSIDE-DOWN VIEW (int. dimensions)

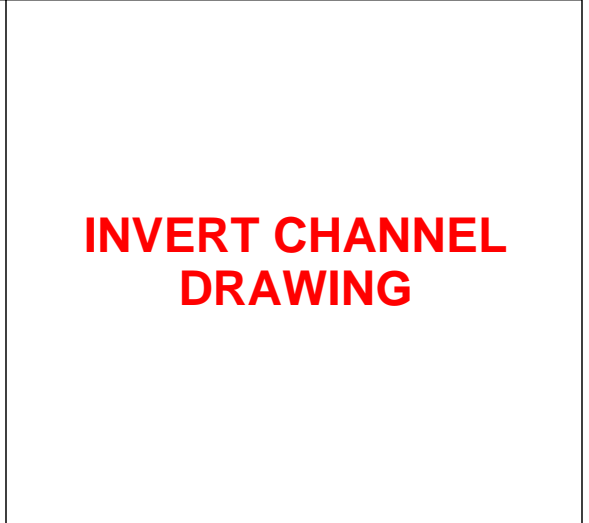
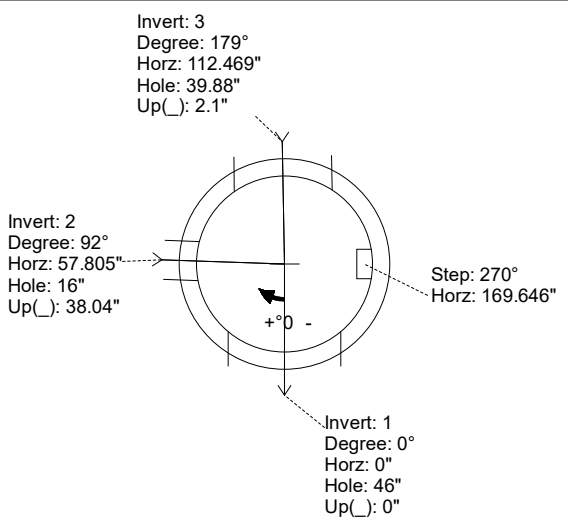
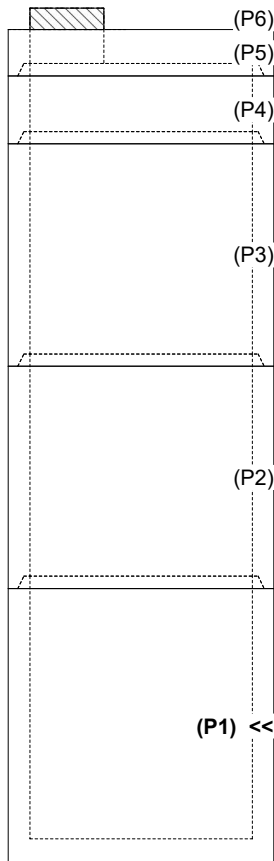

INSIDE WALL DIMENSIONS

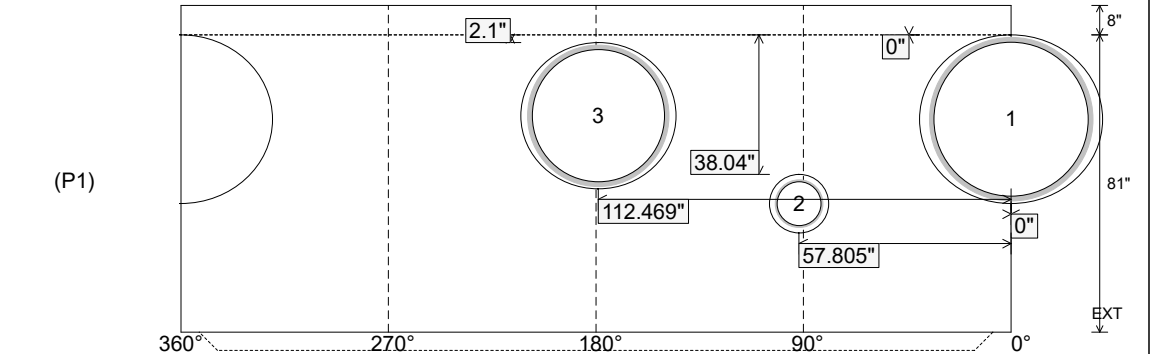

Coating (Int): Coating (Ext):	Seam Up: Tongue Seam Dn: n/a	Wall Thickness: 7" Floor Height: 8"	Height (Int): 81" Height (Ext): 89"	Weight (Net): 13774 lb Volume (Net): 3.52cu.yd
----------------------------------	---------------------------------	--	--	---