

Job Name: 25-1684 P3 KYTC Jefferson Co. Call 200 (251007)
 Job Location: I-264 Louisville, Ky.
 Contractor: Cleary Construction, Inc.

Plant: Beaver Dam, Ky.
 2/6/2026 10:14:11 AM

Tech: J. Coppage
 PC: J. Jarvis



Structure ID: 5127+55 JB-A

P2 BXLD2436FL8-S

BX FLAT LID 8inW SOLID

- P2) 24" x 36" - BX FLAT LID 8inW SOLID - 8"
- P1) 24" x 36" - BOX BASE 8inW, 8inF - 36"
- 1) 24" x 36" - Conseal CS-102 1.00"
- 1) Hole - 28
- 1) Hole - 34

1396 lb
 4032 lb
 0 lb
 0 lb
 0 lb

 Structure Total: 5429 lb

Structure Notes:
 -KYTC STATE PROJECT 251007
 -REINFORCING: #5 BAR @ 12" C/C E.W. (TYP.)
 -CS-102 BUTYL REQUIRED (SUPPLIED BY ICAST).
 -KYTC CERTIFICATIONS REQUIRED.

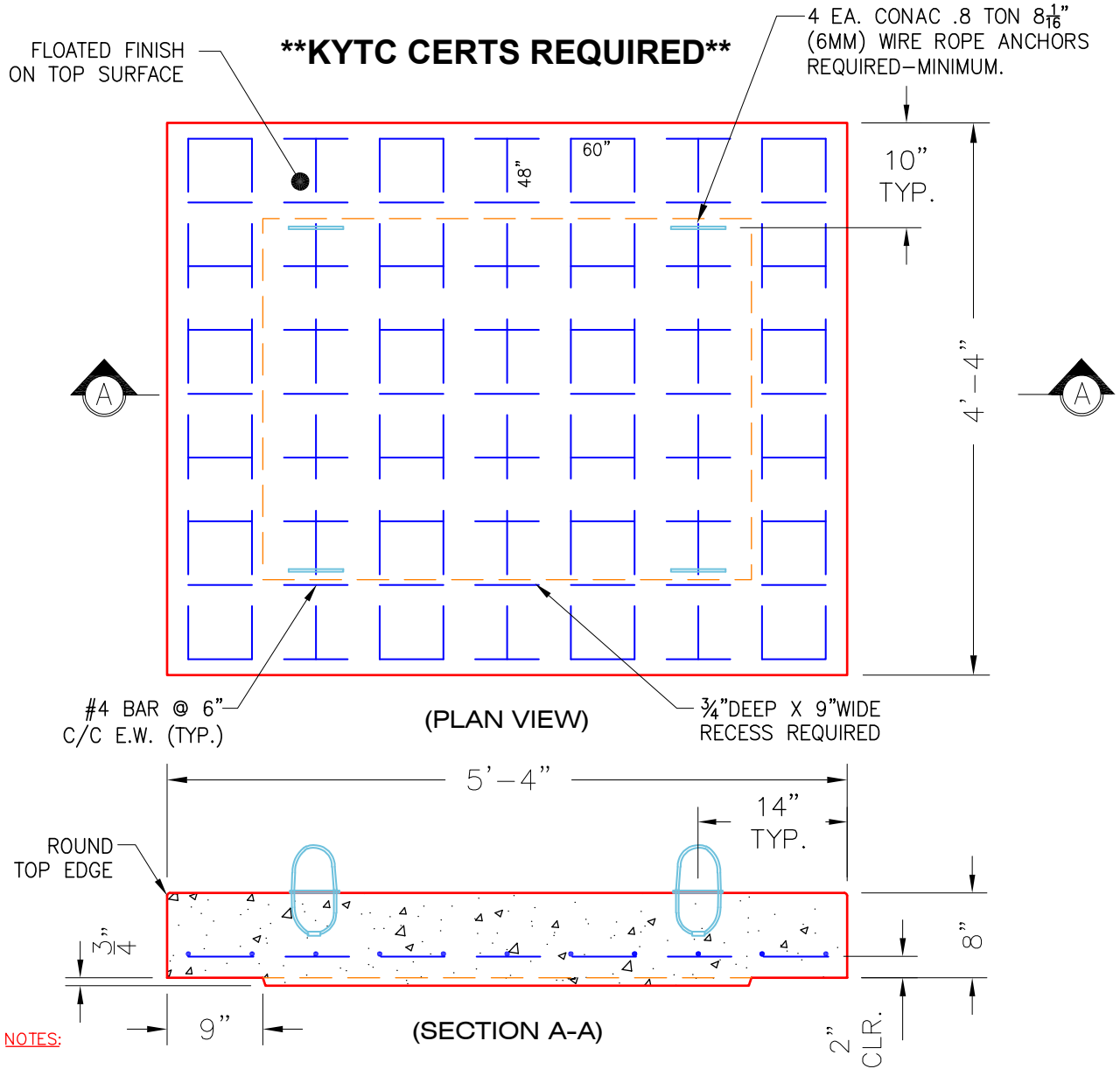

#4 BAR CUT LIST
 9 EA. @ 60"
 11 EA. @ 48"

Coating (Int): Coating (Ext):	Seam Up: Flat Seam Dn: Flat	Wall Thickness: 8"	Height (Ext): 8"	Weight (Net): 1396 lb Volume (Net): 0.36cu.yd
----------------------------------	--------------------------------	--------------------	------------------	--