

Job Name: 25-1675 - Campbellsville Middle School Ph 2
 Job Location: Campbellsville, KY 72718
 Contractor: Rising Sun Development Company

Plant: Beaver Dam, KY
 4/23/2026 3:19:44 PM

Tech: J. Coppage
 PC: J. Jarvis



Structure ID: 8

P1 MH060BA54

MH BASE T/n

- P5) 24" - CASTING HEIGHT - 7"
- P4) 24" - GRADE RING F/F - 3"
- P3) 60" - MH FLAT TOP w/ 24" ECC Hole F/G - 13"
- P2) 60" - MH RISER T/G - 24"
- P1) 60" - MH BASE T/n - 54"
- 1) CASTING - HOE MCB-315-B Fr./Bar Grate
- 2) 60" - Conseal CS-102 1.00"
- 2) Hole - 38
- 6) MH Step ML-10-TDS-NCR - 10"

0 lb
 202 lb
 2869 lb
 2505 lb
 7151 lb
 255 lb
 0 lb
 0 lb
 0 lb

 Structure Total: 12982 lb

- Structure Notes:**
1. PER ASTM C-478 SPECIFICATIONS
 2. CONCRETE: 4,500 PSI AT 28 DAYS
 3. REINFORCEMENT: PER ASTM A615
 4. NO STORM INVERT
 5. STEPS AT 269 DEGREES
 6. HOE MCB-315-B FRAME & BAR GRATE SUPPLIED BY ICAST

Rim: 807.33' Rim to Invert: 8.26' Slack: 0.67' Sump: 2.55' Step Position: 269°

Position	Elev	Angle	Ext. (cw)	Pipe	Pipe OD	Connector	Hole	Horz Size	Up ()	Offset
Invert 1	799.07'	0°	0"	30" ADS N-12	35.1"	Hole 38	38"	41.151"	0"	0"
Invert 2	799.07'	178°	111.875"	30" ADS N-12	35.1"	Hole 38	38"	41.151"	0"	0"
Invert 3										
Invert 4										
Invert 5										
Invert 6										
Invert 7										
Invert 8										

RIGHT-SIDE UP VIEW (int. dimensions)

UPSIDE-DOWN VIEW (int. dimensions)

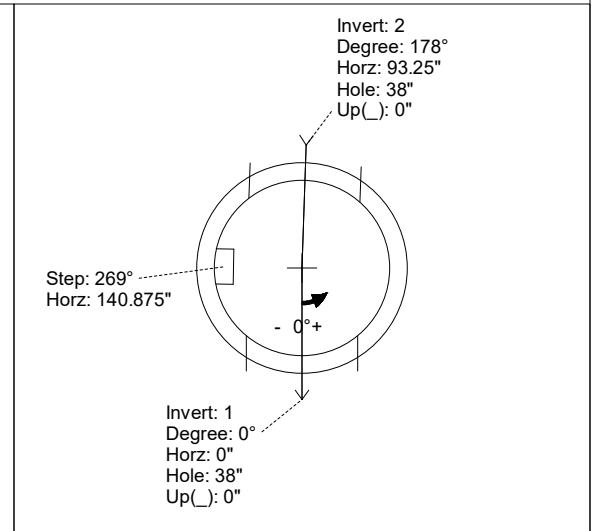
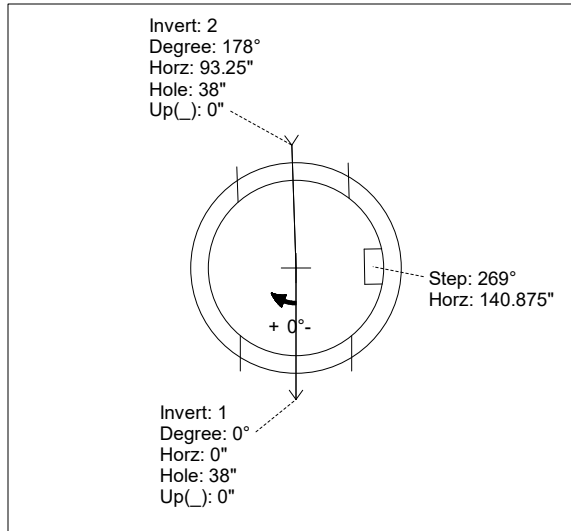
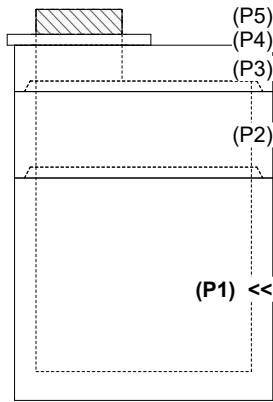

INSIDE WALL DIMENSIONS

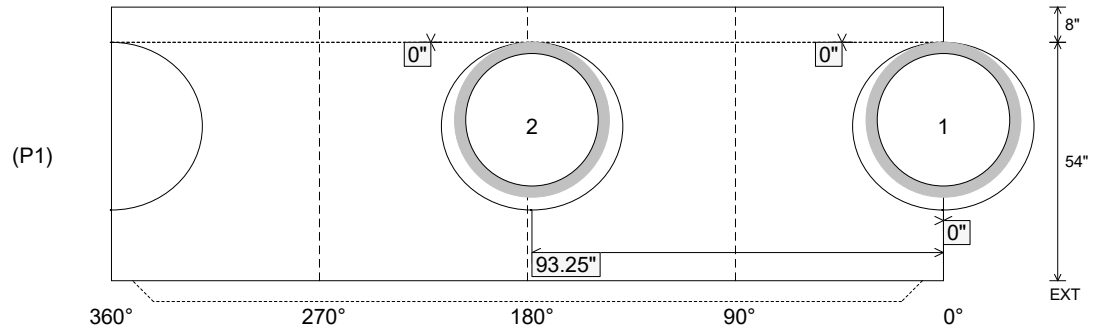

Coating (Int):
 Coating (Ext):

Seam Up: Tongue
 Seam Dn: n/a

Wall Thickness: 6"
 Floor Height: 8"

Height (Int): 54"
 Height (Ext): 62"

Weight (Net): 7151 lb
 Volume (Net): 1.83cu.yd