

Job Name: 25-1431 - Georgetown Commons
 Job Location: Georgetown, KY
 Contractor: Winwater Hartford KY Co.

Plant: Beaver Dam

Tech: J. Coppage

4/9/2026 10:01:00 AM

PC: A. Chambers



Structure ID: MH 36

P2 MH096LD17ECC

MH FLAT TOP w/ 24" ECC Hole

- P4) 24" - CASTING HEIGHT - 7"
- P3) 24" - GRADE RING - 3"
- P2) 96" - MH FLAT TOP w/ 24" ECC Hole - 17"
- P1) 96" - MH BASE - 96"
- 1) CASTING - HOE MC-420 F/C Storm LOU-MSD
- 2) Hole - 56
- 2) Hole - 44
- 8) MH Step ML-10-TDS-NCR - 10"

0 lb	Structure Notes:
202 lb	1. JR HOE MC-420 PROVIDED BY ICAST.
10472 lb	2. PER ASTM C478 SPECIFICATIONS.
24465 lb	3. CONCRETE = 4,000 PSI AT 28 DAYS.
340 lb	4. REINFORCING PER ASTM A615 (GRADE 60).
0 lb	- TOP SLAB AS NOTED BELOW
0 lb	- RISER/WALLS (As .18)
0 lb	- FLOOR (As .37) #5 BARS AT 10" C.C.E.W.

Structure Total:	35480 lb

GENERAL NOTES:

1. MANUFACTURED TO ASTM C-478 (LATEST REVISION).
2. CONCRETE 5,000 PSI AT 28 DAYS.
3. WEIGHT: 10,472 LBS.
4. REINFORCING: TOP MAT: #4 BAR @ 18" C/C E.W.
 BOTTOM MAT: #5 BAR @ 12" C/C E.W.
 PER ASTM A615 (GRADE 60)

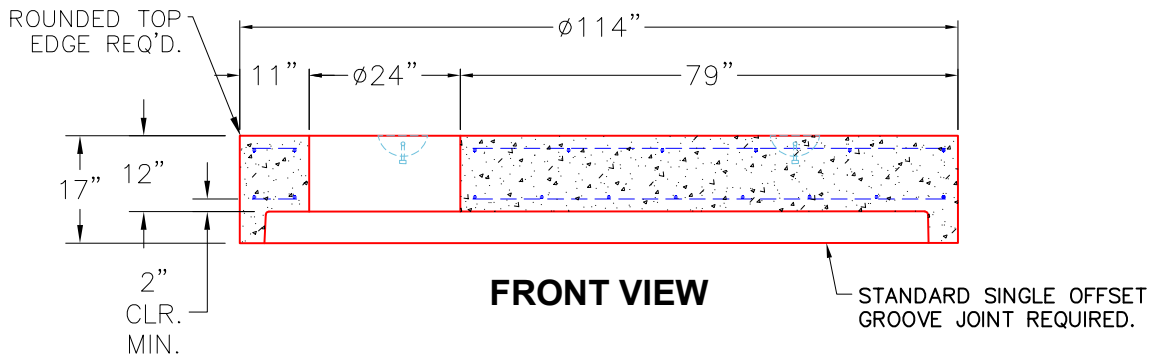
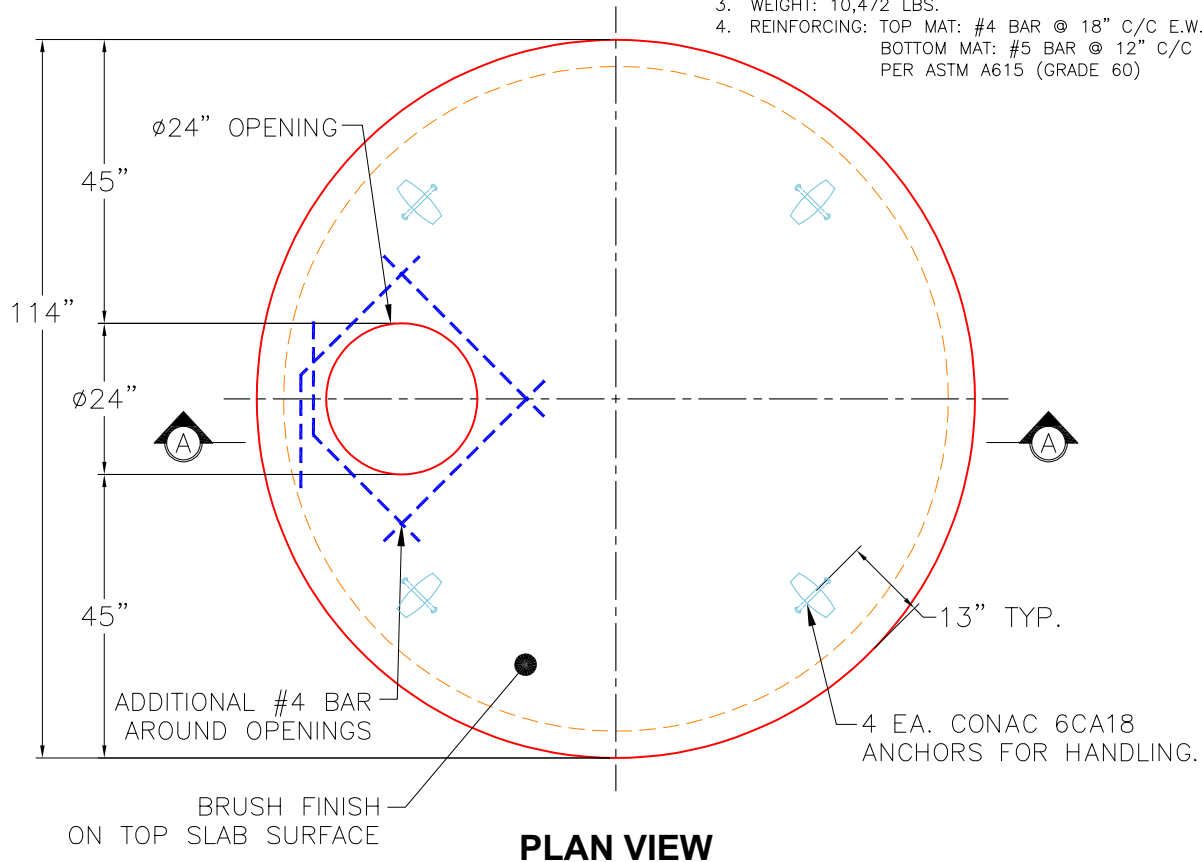

Coating (Int):	Seam Up: Flat	Wall Thickness: 9"	Height (Ext): 17"	Weight (Net): 10472 lb
Coating (Ext):	Seam Dn: Groove			Volume (Net): 2.68cu.yd