

Job Name: 25-1431 - Georgetown Commons
 Job Location: Georgetown, KY
 Contractor: Winwater Hartford KY Co.

Plant: Beaver Dam

4/9/2026 10:01:06 AM

Tech: J. Coppage

PC: A. Chambers



Structure ID: MH 329

P3 MH096LD17ECC

MH FLAT TOP w/ 24" ECC Hole

- P4) 24" - CASTING HEIGHT - 7"
- P3) 96" - MH FLAT TOP w/ 24" ECC Hole - 17"
- P2) 96" - MH RISER - 36"
- P1) 96" - MH BASE - 96"
- 1) CASTING - HOE MC-420 F/C Storm LOU-MSD
- 2) 96" - Conseal CS-102 1.00"
- 1) Hole - 75
- 1) Hole - 30
- 1) Hole - 40
- 1) Hole - 68
- 11) MH Step ML-10-TDS-NCR - 10"

- 0 lb Structure Notes:
1. JR HOE MC-420 PROVIDED BY ICAST.
 2. PER ASTM C478 SPECIFICATIONS.
 3. CONCRETE = 4,000 PSI AT 28 DAYS.
 4. REINFORCING PER ASTM A615 (GRADE 60).
 - TOP SLAB (As .62) #5 BARS AT 6" C.C.E.W..
 - RISER/WALLS (As .18)
 - FLOOR (As .37) #5 BARS AT 10" C.C.E.W.

Structure Total: 42303 lb

GENERAL NOTES:

1. MANUFACTURED TO ASTM C-478 (LATEST REVISION).
2. CONCRETE 5,000 PSI AT 28 DAYS.
3. WEIGHT: 10,472 LBS.
4. REINFORCING: TOP MAT: #4 BAR @ 18" C/C E.W.
 BOTTOM MAT: #5 BAR @ 12" C/C E.W.
 PER ASTM A615 (GRADE 60)

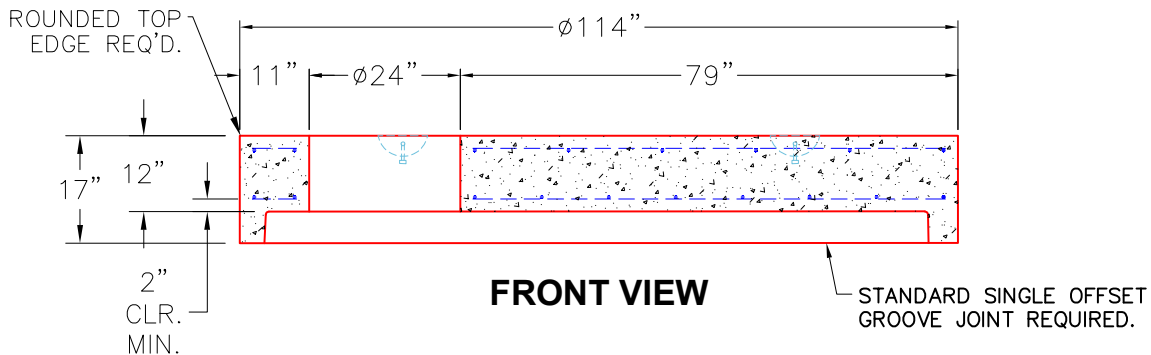
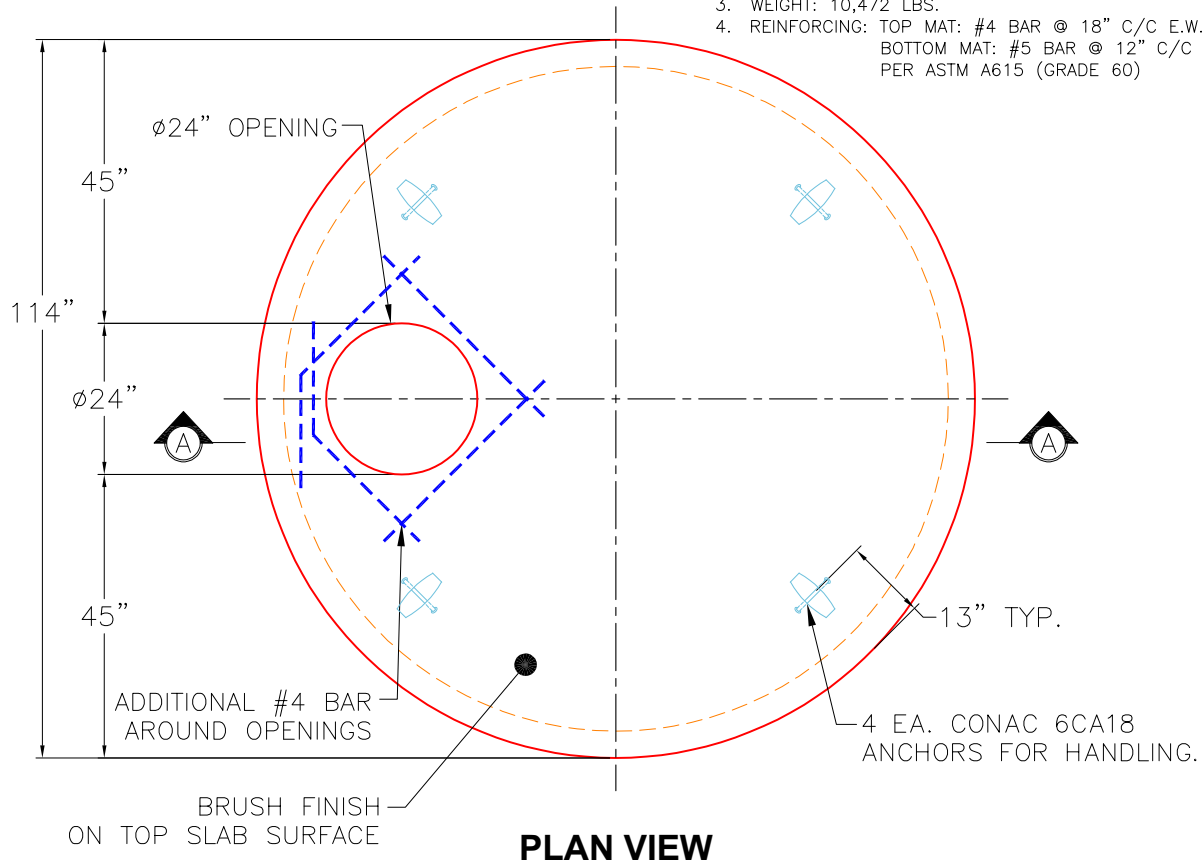

Coating (Int): Coating (Ext):	Seam Up: Flat Seam Dn: Groove	Wall Thickness: 9"	Height (Ext): 17"	Weight (Net): 10472 lb Volume (Net): 2.68cu.yd
----------------------------------	----------------------------------	--------------------	-------------------	---