

Job Name: 25-1431 - Georgetown Commons  
 Job Location: Georgetown, KY  
 Contractor: Winwater Hartford KY Co.

Plant: Beaver Dam

4/9/2026 10:01:05 AM

Tech: J. Coppage

PC: A. Chambers



**Structure ID: MH 327**

**P3 MH084LD15-24ECC**

**MH FLAT TOP w/24" ECC Hole**

- P5) 24" - CASTING HEIGHT - 7"
- P4) 24" - GRADE RING - 3"
- P3) 84" - MH FLAT TOP w/24" ECC Hole - 15"
- P2) 84" - MH RISER - 48"
- P1) 84" - MH BASE - 84"
- 1) CASTING - HOE MC-420 F/C Storm LOU-MSD
- 2) 84" - Conseal CS-102 1.00"
- 2) Hole - 68
- 1) Hole - 20
- 11) MH Step ML-10-TDS-NCR - 10"

- Structure Notes:**
1. JR HOE MC-420 PROVIDED BY ICAST.
  2. PER ASTM C478 SPECIFICATIONS.
  3. CONCRETE = 4,000 PSI AT 28 DAYS.
  4. REINFORCING PER ASTM A615 (GRADE 60).
    - TOP SLAB AS NOTED BELOW.
    - RISER/WALLS (As .18)
    - FLOOR (As .37) #5 BARS AT 10" C.C.E.W.

Structure Total: 35008 lb

**GENERAL NOTES:**

1. MANUFACTURED TO ASTM C-478 (LATEST REVISION).
2. CONCRETE 5,000 PSI AT 28 DAYS.
3. REINFORCING: TOP MAT #4 @ 18" O.C. E.W.  
 BOTTOM MAT #4 @ 9" O.C. E.W.  
 (GRADE 60)

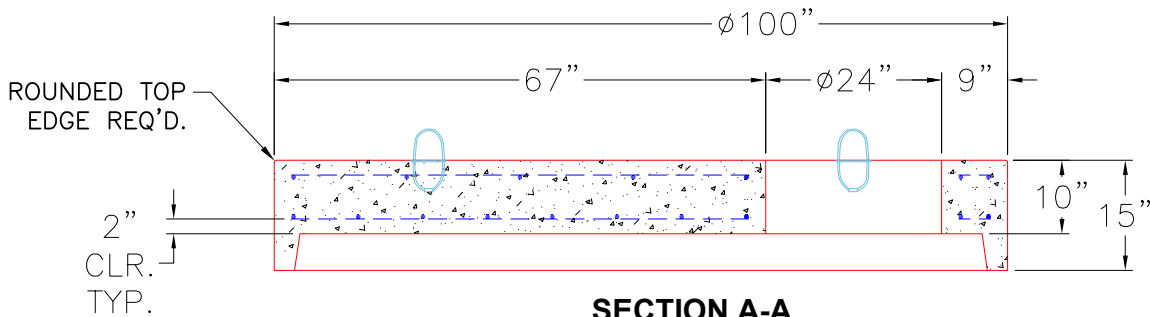
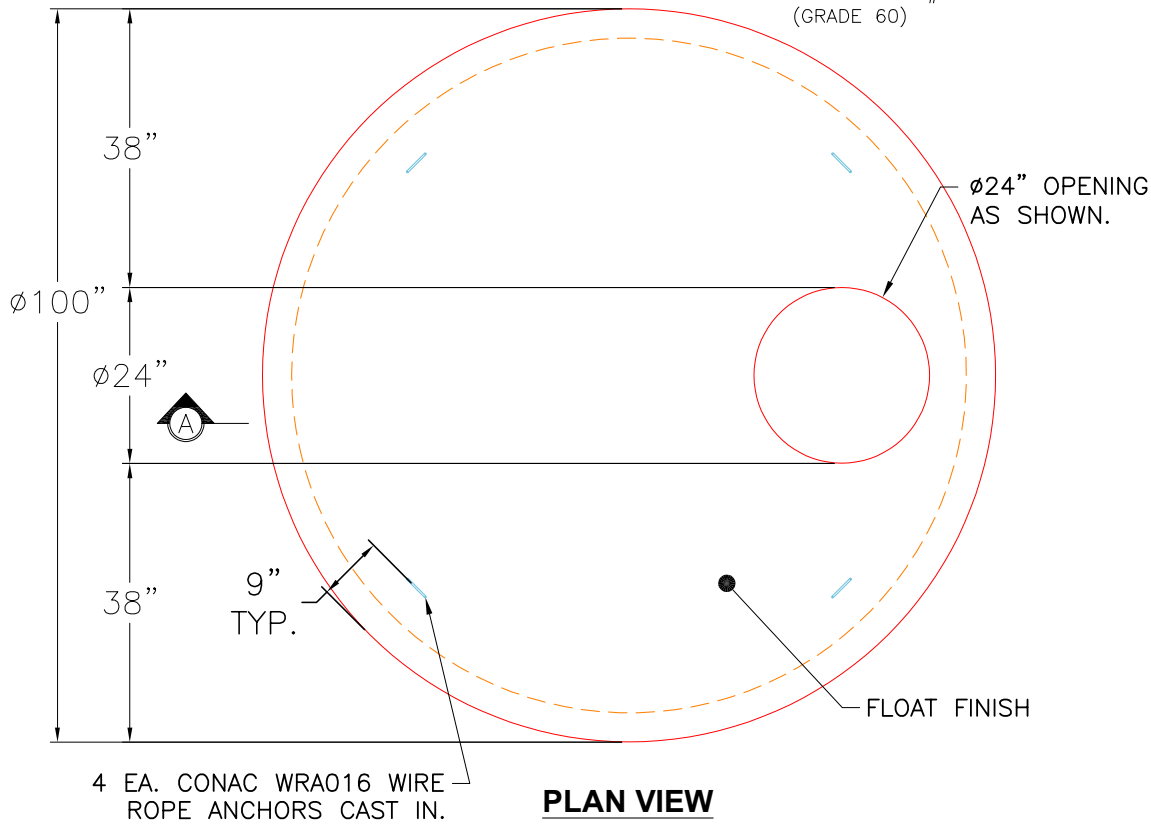

Coating (Int): Coating (Ext):	Seam Up: Flat Seam Dn: Groove	Wall Thickness: 8"	Height (Ext): 15"	Weight (Net): 9316 lb Volume (Net): 2.38cu.yd
----------------------------------	----------------------------------	--------------------	-------------------	--