

Job Name: 25-1431 - Georgetown Commons  
 Job Location: Georgetown, KY  
 Contractor: Winwater Hartford KY Co.

Plant: Beaver Dam

4/23/2026 11:30:33 AM

Tech: J. Coppage

PC: A. Chambers



**Structure ID: DCI 32**

**P2 MH084LD17-24x36**

**MH FLAT TOP w/24"x36" Hole**

- P3) 24" x 36" - CASTING HEIGHT - 6"
- P2) 84" - MH FLAT TOP w/24"x36" Hole - 17"
- P1) 84" - MH BASE Custom Ht - 71"
- 1) CASTING - HOE 470 SET (F/G/H)
- 1) 84" - Conseal CS-102 1.00"
- 1) 24" x 36" - Conseal CS-102 1.00"
- 2) Hole - 50
- 1) Hole - 32
- 6) MH Step ML-10-TDS-NCR - 10"

- 0 lb Structure Notes:
1. JR HOE HOE-470 PROVIDED BY ICAST.
  2. PER ASTM C478 SPECIFICATIONS.
  3. CONCRETE = 4,000 PSI AT 28 DAYS.
  4. REINFORCING PER ASTM A615 (GRADE 60).
    - TOP SLAB (As .62) #5 BARS AT 6" C.C.E.W..
    - RISER/WALLS (As .18)
    - FLOOR (As .37) #5 BARS AT 10" C.C.E.W.

Structure Total: 22092 lb

GENERAL NOTES:

1. MANUFACTURED TO ASTM C-478 (LATEST REVISION).
2. CONCRETE 4,000 PSI AT 28 DAYS.
3. REINFORCING: TOP MAT #4 @ 18" O.C. E.W.  
 BOTTOM MAT #4 @ 9" O.C. E.W.  
 (GRADE 60)

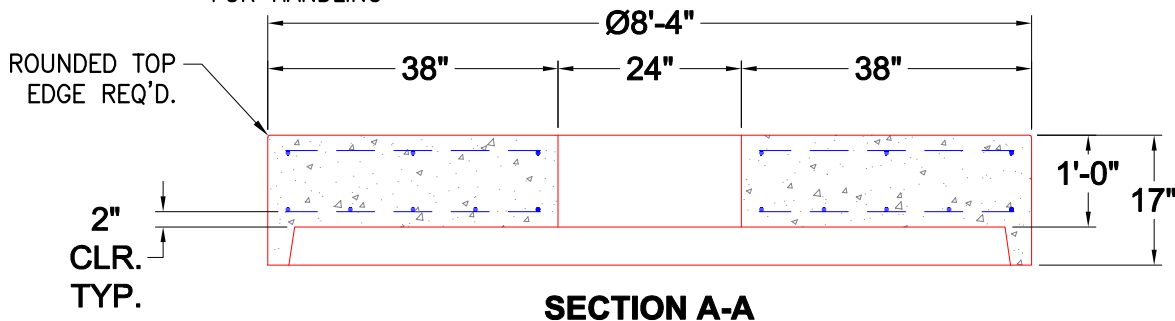
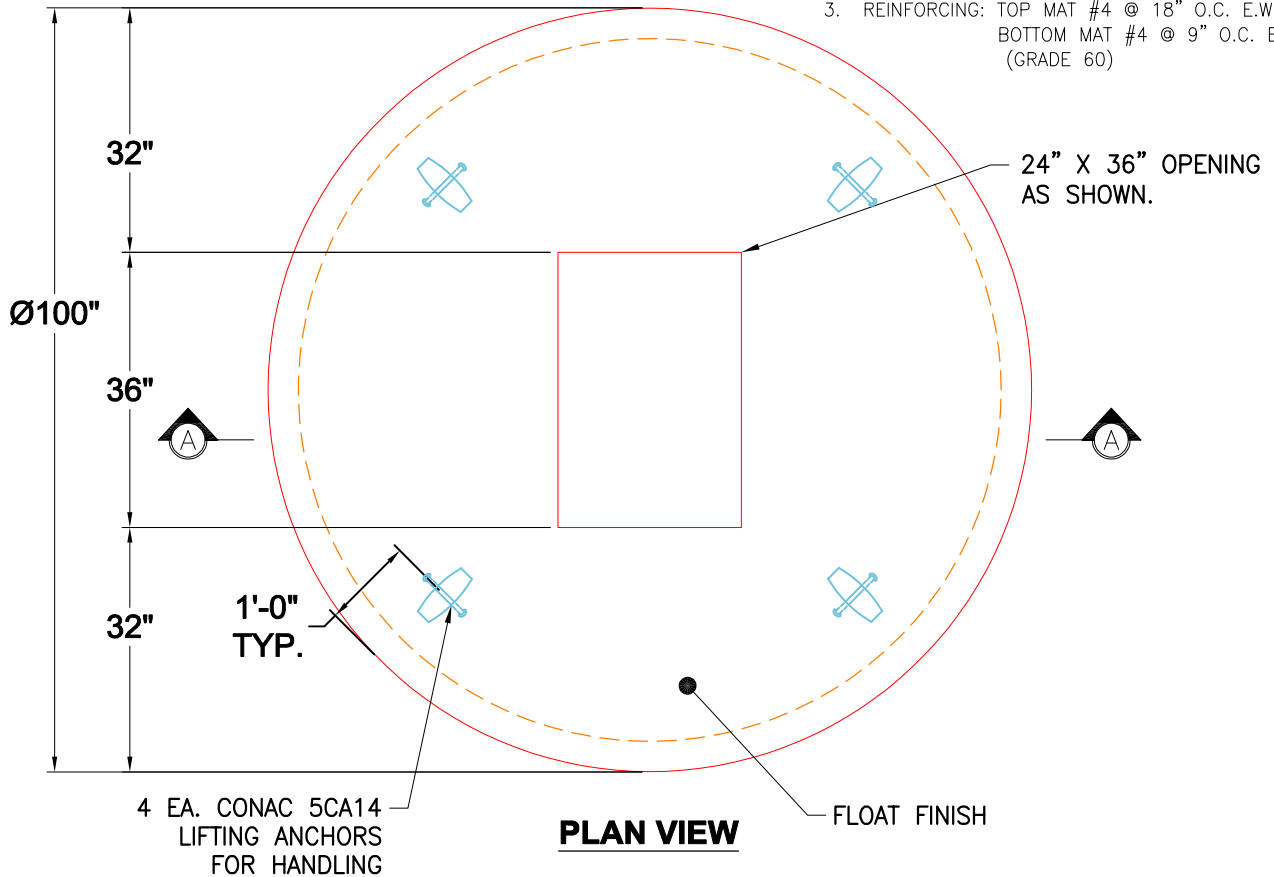

Coating (Int):  
 Coating (Ext):

Seam Up: Flat  
 Seam Dn: Groove

Wall Thickness: 8"

Height (Ext): 17"

Weight (Net): 5994 lb  
 Volume (Net): 1.53cu.yd