

Job Name: 25-1431 - Georgetown Commons  
 Job Location: Georgetown, KY  
 Contractor: Winwater Hartford KY Co.

Plant: Beaver Dam

4/23/2026 11:30:50 AM

Tech: J. Coppage

PC: A. Chambers



**Structure ID: CB 120**

**P2 MH048LD12S**

**MH FLAT TOP w/34"x34" Hole**

- P3) 34" x 34" - CASTING HEIGHT - 3"
- P2) 48" - MH FLAT TOP w/34"x34" Hole - 12"
- P1) 48" - MH BASE Custom Ht - 56"
- 1) CASTING - HOE 595 F/G
- 1) Hole - 20
- 1) Hole - 18
- 5) MH Step ML-10-TDS-NCR - 10"

- Structure Notes:**
1. JR HOE HOE-595 PROVIDED BY ICAST.
  2. PER ASTM C478 SPECIFICATIONS.
  3. CONCRETE = 4,000 PSI AT 28 DAYS.
  4. REINFORCING PER ASTM A615 (GRADE 60).
    - TOP SLAB (As .62) #5 BARS AT 6" C.C.E.W..
    - RISER/WALLS (As .12)
    - FLOOR (As .31) #5 BARS AT 12" C.C.E.W.

	0 lb
	1194 lb
	4998 lb
	376 lb
	0 lb
	0 lb
	0 lb
Structure Total:	6568 lb

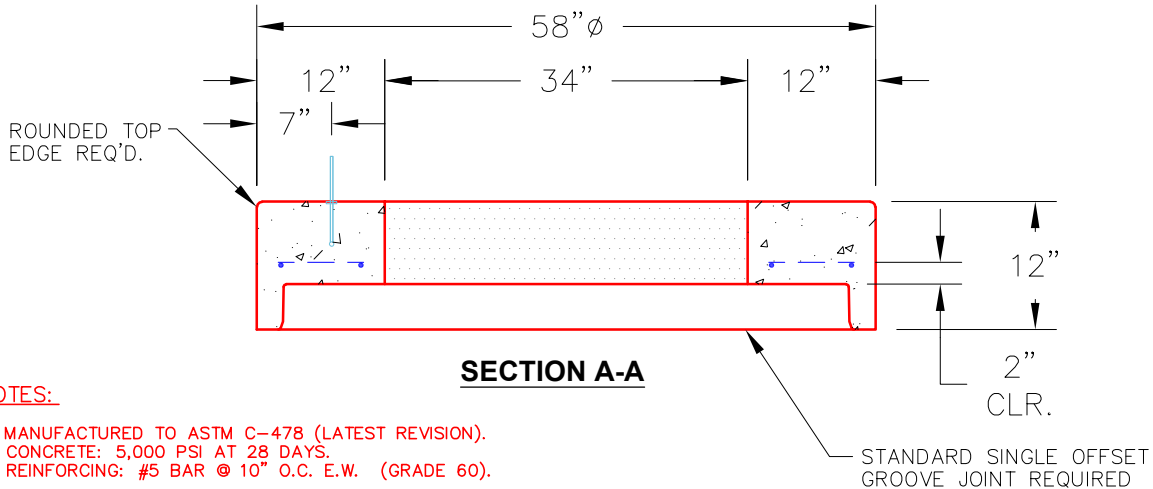
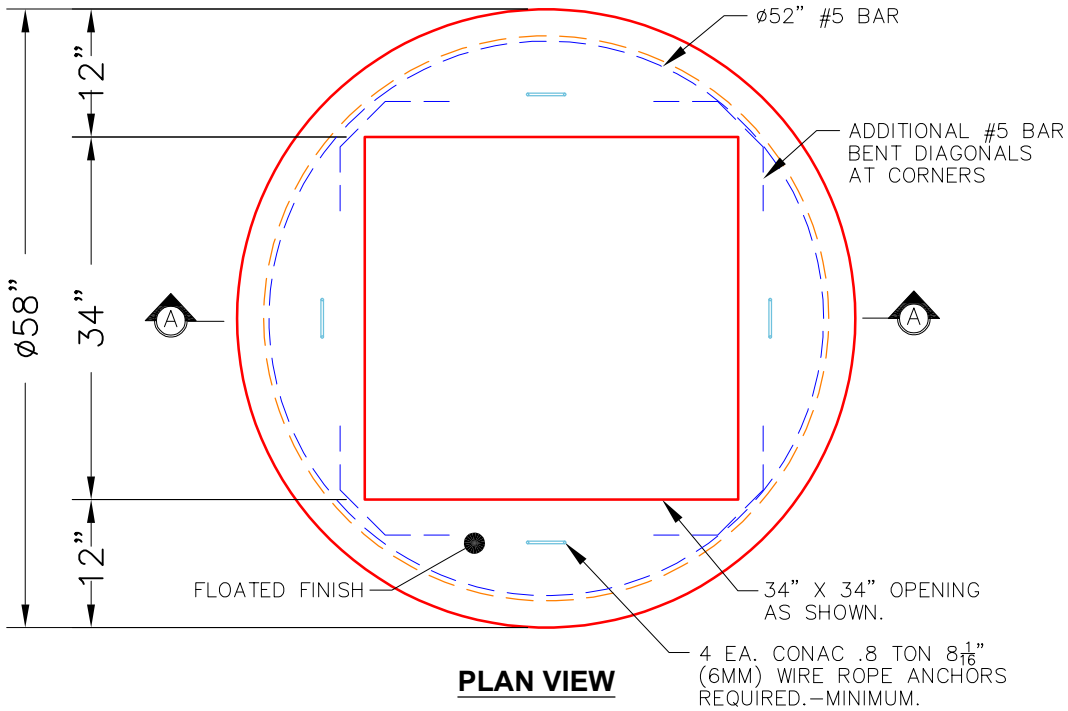

- NOTES:**
1. MANUFACTURED TO ASTM C-478 (LATEST REVISION).
  2. CONCRETE: 5,000 PSI AT 28 DAYS.
  3. REINFORCING: #5 BAR @ 10" O.C. E.W. (GRADE 60).

Coating (Int):	Seam Up: Flat Seam Dn: Groove	Wall Thickness: 5"	Height (Ext): 12"	Weight (Net): 1194 lb Volume (Net): 0.3cu.yd
----------------	----------------------------------	--------------------	-------------------	---