

**Job Name: 25-1385C W6 Ph.II-A Force Main Improvements**  
**Job Location: Burlington, KY**  
**Contractor: Lawrence Construction & Leasing, Inc.**

PC: J. Jarvis  
 TECH: J. Coppage  
 Plant: Beaver Dam



Structure ID: **1030163-A Remake 3**  
 Spec: Sanitary Rim: 902.39' Sump: 2.5" Floor (Bot): 890.412'  
 Type: SAN.MH Invert: 891.12' Floor (Top): 890.912' Overall Height: 11.917'  
 Size: 48" Rim to Invert: 11.27' Floor Height: 6" Slack: 0.74"

**Structure Notes:**

1. PER ASTM C-478 SPECS
2. CONCRETE: 4,000 PSI AT 28 DAYS
3. REINFORCEMENT: PER ASTM A615
4. INVERT CHANNEL REQUIRED
5. A-LOK DURA-PLATE 100 LINER REQUIRED
6. STEPS AT 90 DEGREES
7. HOE MC-375 SANITARY BY ICAST

**STRUCTURE SUMMARY:**

- P4) 24" - CASTING HEIGHT - 7" 0 lb
  - P3) 48" - MH FLAT TOP w/ 24" ECC Hole F/G - 12" 1561 lb
  - P2) 48" - MH RISER T/G - 72" 5030 lb
  - P1) 48" - MH BASE Custom Ht T/n - 46" 4077 lb
  - 1) A-LOK DURA-PLATE 100 LINER - PSSPEC-EA 0 lb
  - 1) 48" - MH INVERT CHANNEL - FULL HEIGHT 1440 lb
  - 1) CASTING - HOE MC-375 F/C Sanitary 271 lb
  - 1) 48" - Conseal CS-102 1.00" (Double) 0 lb
  - 1) 48" - Conseal CS-202 1.00" (Double) 0 lb
  - 2) Kor-N-Seal2 - S206-26 12 lb
  - 8) MH Step ML-10-TDS-NCR - 10" 0 lb
- Structure Total: 12391 lb

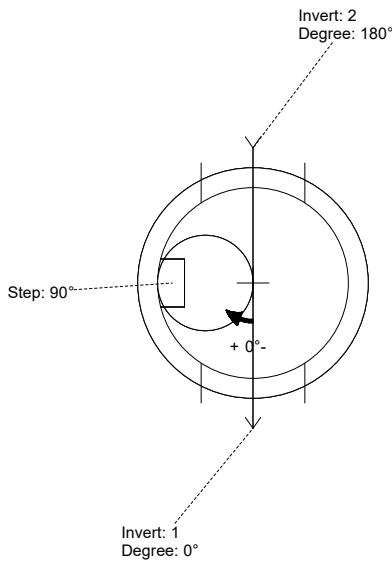

Position	Elev	Angle	Pipe	Pipe OD	Hole	Connector	Up (L)	Ref
Rim	902.39'							
Reducer								
Invert 1	891.12'	0°	21" PVC F679	22.047"	26"	Kor-N-Seal2 S206-26	0"	P1
Invert 2	891.22'	180°	21" PVC F679	22.047"	26"	Kor-N-Seal2 S206-26	1.2"	P1
Invert 3								
Invert 4								
Invert 5								
Invert 6								
Invert 7								
Invert 8								

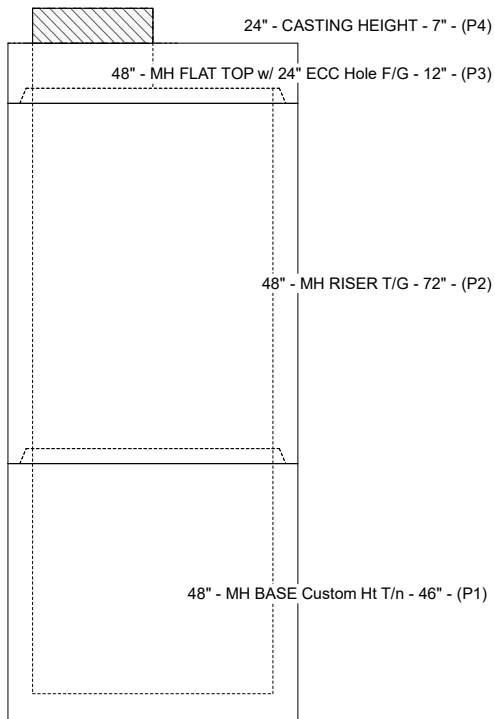

**Cast (Int. Dim.) - Interior Dimensions**

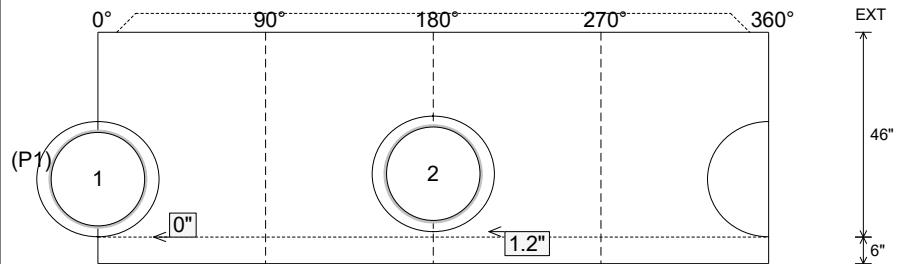

Submittal Drawing  
 11/26/2025 1:01:58 PM

SUBMITTAL  
 APPROVED BY: