

Structure ID: 1030163-A Remake 3

P1 MH048BAVF

MH BASE Custom Ht T/n

P4) 24" - CASTING HEIGHT - 7" P3) 48" - MH FLAT TOP w/ 24" ECC Hole F/G - 12" P2) 48" - MH RISER T/G - 72" P1) 48" - MH BASE Custom Ht T/n - 46" 1) A-LOK DURA-PLATE 100 LINER - PSSPEC-EA 1) 48" - MH INVERT CHANNEL - FULL HEIGHT 1) CASTING - HOE MC-375 F/C Sanitary 1) 48" - Conseal CS-102 1.00" (Double) 1) 48" - Conseal CS-202 1.00" (Double) 2) Kor-N-Seal2 - S206-26 8) MH Step ML-10-TDS-NCR - 10"	0 lb 1561 lb 5030 lb 4077 lb 0 lb 1440 lb 271 lb 0 lb 0 lb 0 lb 12 lb 0 lb <hr style="width: 50px; margin-left: 0;"/> Structure Total: 12391 lb	Structure Notes: 1. PER ASTM C-478 SPECS 2. CONCRETE: 4,000 PSI AT 28 DAYS 3. REINFORCEMENT: PER ASTM A615 4. INVERT CHANNEL REQUIRED 5. A-LOK DURA-PLATE 100 LINER REQUIRED 6. STEPS AT 90 DEGREES 7. HOE MC-375 SANITARY BY ICAST
--	---	---

Rim: 902.39' Rim to Invert: 11.27' Slack: 0.74" Sump: 2.5" Step Position: 90

Position	Elev	Angle	Ext. (cw)	Pipe	Pipe OD	Connector	Hole	Horz Size	Up ()	Offset
Invert 1	891.12'	0°	0"	21" PVC F679	22.047"	Kor-N-Seal2 S206-26	26"	27.476"	0"	0"
Invert 2	891.22'	180°	91.106"	21" PVC F679	22.047"	Kor-N-Seal2 S206-26	26"	27.476"	1.2"	0"
Invert 3										
Invert 4										
Invert 5										
Invert 6										
Invert 7										
Invert 8										

RIGHT-SIDE UP VIEW (int. dimensions)

UPSIDE-DOWN VIEW (int. dimensions)

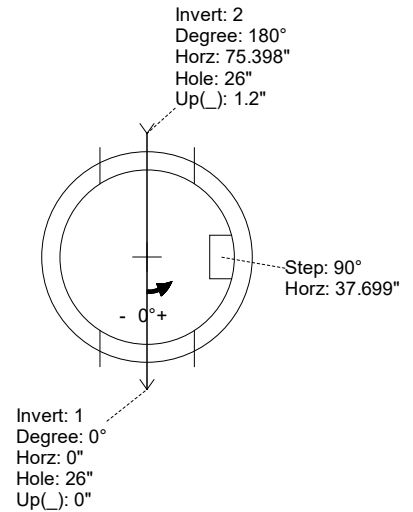
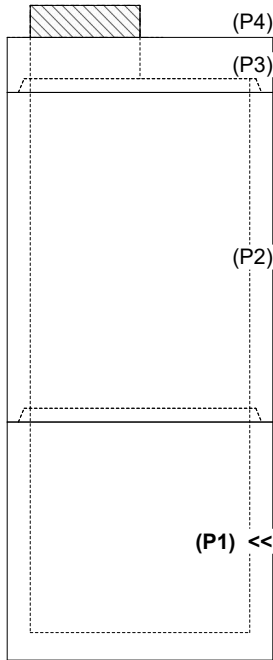

INSIDE WALL DIMENSIONS

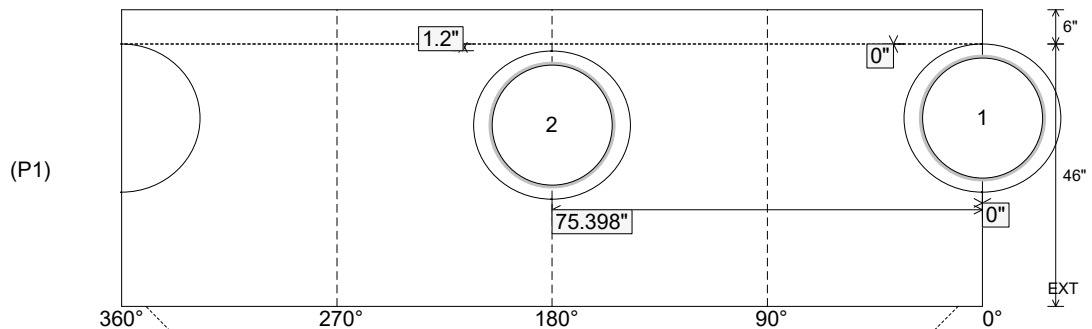

Coating (Int): Coating (Ext):	Seam Up: Tongue Seam Dn: n/a	Wall Thickness: 5" Floor Height: 6"	Height (Int): 46" Height (Ext): 52"	Weight (Net): 4077 lb Volume (Net): 1.04cu.yd
----------------------------------	---------------------------------	--	--	--

Job Name: 25-1385C W6 Ph.II-A Force Main Improvements
 Job Location: Burlington, KY
 Contractor: Lawrence Construction & Leasing, Inc.

Plant: Beaver Dam

Tech: J. Coppage

11/26/2025 1:05:43 PM

PC: J. Jarvis



Structure ID: 1030163-A Remake 3

P1 MH048BAVF

MH BASE Custom Ht T/n

- P4) 24" - CASTING HEIGHT - 7" 0 lb
 - P3) 48" - MH FLAT TOP w/ 24" ECC Hole F/G - 12" 1561 lb
 - P2) 48" - MH RISER T/G - 72" 5030 lb
 - P1) 48" - MH BASE Custom Ht T/n - 46" 4077 lb
 - 1) A-LOK DURA-PLATE 100 LINER - PSSPEC-EA 0 lb
 - 1) 48" - MH INVERT CHANNEL - FULL HEIGHT 1440 lb
 - 1) CASTING - HOE MC-375 F/C Sanitary 271 lb
 - 1) 48" - Conseal CS-102 1.00" (Double) 0 lb
 - 1) 48" - Conseal CS-202 1.00" (Double) 0 lb
 - 2) Kor-N-Seal2 - S206-26 12 lb
 - 8) MH Step ML-10-TDS-NCR - 10" 0 lb
- Structure Total: 12391 lb

- Structure Notes:**
1. PER ASTM C-478 SPECS
 2. CONCRETE: 4,000 PSI AT 28 DAYS
 3. REINFORCEMENT: PER ASTM A615
 4. INVERT CHANNEL REQUIRED
 5. A-LOK DURA-PLATE 100 LINER REQUIRED
 6. STEPS AT 90 DEGREES
 7. HOE MC-375 SANITARY BY ICAST

Rim: 902.39' Rim to Invert: 11.27' Slack: 0.74" Sump: 2.5" Step Position: 90

Position	Elev	Angle	Ext. (cw)	Pipe	Pipe OD	Connector	Hole	Horz Size	Up ()	Offset
Invert 1	891.12'	0°	0"	21" PVC F679	22.047"	Kor-N-Seal2 S206-26	26"	27.476"	0"	0"
Invert 2	891.22'	180°	91.106"	21" PVC F679	22.047"	Kor-N-Seal2 S206-26	26"	27.476"	1.2"	0"
Invert 3										
Invert 4										
Invert 5										
Invert 6										
Invert 7										
Invert 8										

RIGHT-SIDE UP VIEW (int. dimensions)

UPSIDE-DOWN VIEW (int. dimensions)

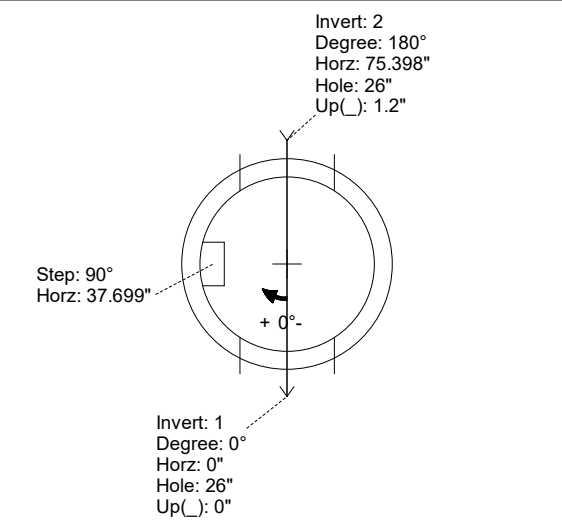
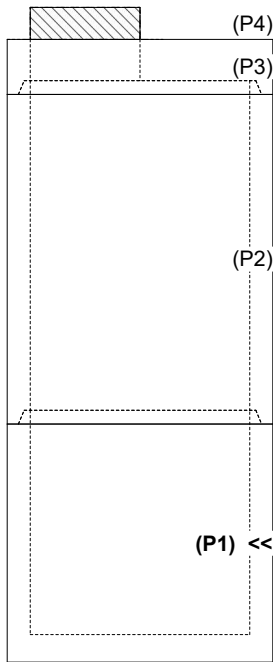

INVERT CHANNEL DRAWING

INSIDE WALL DIMENSIONS

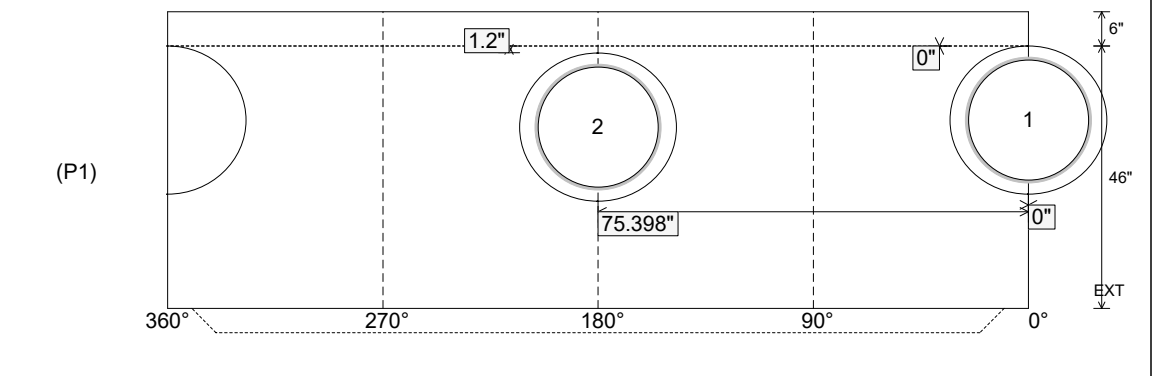

Coating (Int): Coating (Ext):	Seam Up: Tongue Seam Dn: n/a	Wall Thickness: 5" Floor Height: 6"	Height (Int): 46" Height (Ext): 52"	Weight (Net): 4077 lb Volume (Net): 1.04cu.yd
----------------------------------	---------------------------------	--	--	--