

Job Name: 25-1145 - 7959 Poplar Creek
Job Location: Nashville, TN 37221
Contractor: Elite Constructors, Inc.

PC: A. Chambers
 TECH: K. Cardwell
 Plant: Beaver Dam, KY



Structure ID: **A3.2**

Spec: Storm
 Type: BX 6inW, 6inF
 Size: 28" x 96"

Rim: 601.55'
 Invert: 597'
 Rim to Invert: 4.55'

Sump: 0"
 Floor (Top): 597'
 Floor Height: 6"

Floor (Bot): 596.5'
 Overall Height: 5'
 Slack: 0.6"

Structure Notes:

- STATION: 10+84.89
- 1. PER ASTM C-913 SPECS
- 2. CONCRETE: 4,500 PSI AT 28 DAYS
- 3. REINFORCEMENT: #4 BAR @ 12" C.C. E.W. (GRADE 60)
- 4. 3 EA. JBS 3101-V FRAMES, L-VANE GRATES, & CURB HOODS SUPPLIED BY ICAST
- 5. LINTEL BAR SLOTS OFFSET 16" FROM CENTER BOTH WAYS IN EACH LONG WALL REQUIRED (7" LONG X 1" DEEP X FULL WIDTH OF WALL)
- 7. INVERT 2 OFFSET 32" FROM CENTER

STRUCTURE SUMMARY:

- P2) 28" x 96" - CASTING HEIGHT - 6" 0 lb
 - P1) 28" x 96" - BOX BASE 6inW, 6inF, Variable Ht F/n - 48" 8258 lb
 - 1) SECONDARY POUR 0 lb
 - 1) CASTING - JBS 3101V Triple Set (F/G/H) 1857 lb
 - 1) 28" x 96" - Conseal CS-102 1.00" 0 lb
 - 1) Hole - 26 0 lb
 - 1) Hole - 22 0 lb
 - 4) LINTEL BAR SLOT n/n - 7"x1" 0 lb
- Structure Total: **10115 lb**

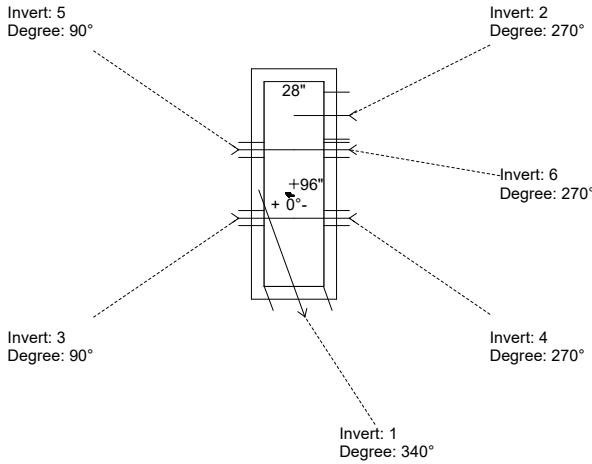

Position	Elev	Angle	Pipe	Pipe OD	Hole	Connector	Up (")	Ref
Rim	601.55'							
Reducer								
Invert 1	597'	340°	18" RCP B WALL	23"	26"	Hole 26	-2.5"	P1
Invert 2	597'	270°	15" RCP B WALL	19.5"	22"	Hole 22	-2.25"	P1
Invert 3	600.916'	90°	7" x 1" LINTEL BAR SLOT	7" x 1"	7" x 1"	LINTEL BAR SLOT 7"x1"	47"	P1
Invert 4	600.916'	270°	7" x 1" LINTEL BAR SLOT	7" x 1"	7" x 1"	LINTEL BAR SLOT 7"x1"	47"	P1
Invert 5	600.916'	90°	7" x 1" LINTEL BAR SLOT	7" x 1"	7" x 1"	LINTEL BAR SLOT 7"x1"	47"	P1
Invert 6	600.916'	270°	7" x 1" LINTEL BAR SLOT	7" x 1"	7" x 1"	LINTEL BAR SLOT 7"x1"	47"	P1
Invert 7								
Invert 8								

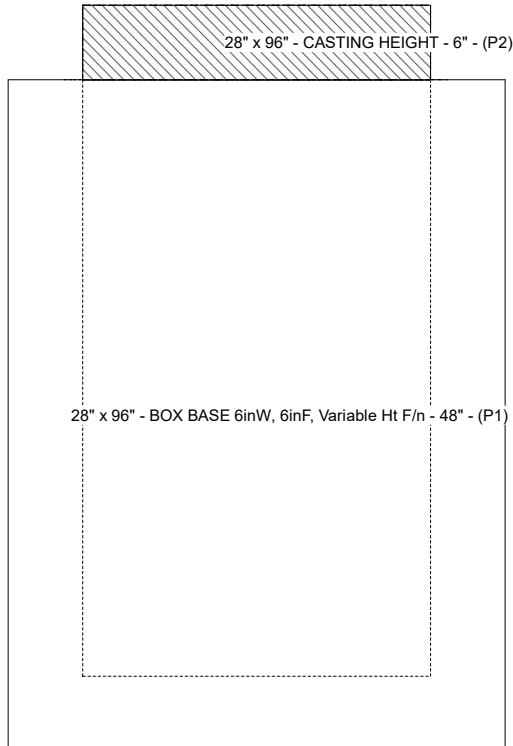

Cast (Int. Dim.) - Interior Dimensions

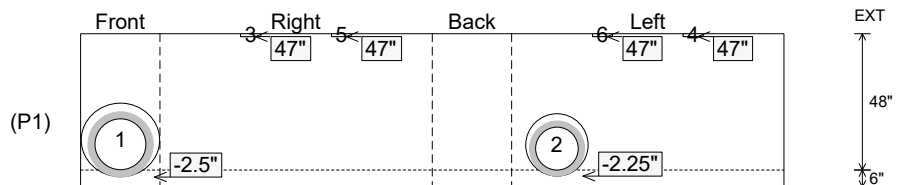

Submittal Drawing
 11/17/2025 2:03:23 PM

SUBMITTAL
 APPROVED BY: