

Job Name: 25-1137 - East Bank Regional Pump Station
 Job Location: Nashville, TN
 Contractor: Garney Companies, Inc.

Plant: Beaver Dam
 4/8/2025 8:25:56 AM

Tech: M. Biliter
 PC: J. Jarvis



Structure ID: MH 003 3+50

P2 MH072TS15X

XYPEX MH FT REDUCER 48" HOLE T/G

- P7) 24" - CASTING HEIGHT - 7.50"
- P6) 24" - XYPEX GRADE RING F/F - 4"
- P5) 48" - ECC XYPEX CONE w/ 24" HOLE F/G - 30"
- P4) 48" - MH RISER w/XYPEX T/G - 72"
- P3) 48" - MH RISER w/XYPEX T/G - 72"
- P2) 72" - XYPEX MH FT REDUCER 48" HOLE T/G - 15"
- P1) 72" - MH BASE w/XYPEX T/h - 72"
- 1) JOINT WRAP PRIMER - CONSEAL CS-75 (1 gal.)
- 1) JOINT WRAP - 0.065"x6"x50' CONSEAL CS212
- 1) 72" - SAN. INV. CHANNEL - FULL HEIGHT
- 1) 72" - DBL 1"x14.5' Butyl (2x)
- 3) 48" - DBL 1"x14.5' Butyl (2x)
- 2) A-Lok - 1630
- 22) MH Step - 12"

0 lb
270 lb
2050 lb
5030 lb
5030 lb
3864 lb
11633 lb
0 lb
0 lb
5422 lb
0 lb
0 lb
2 lb
0 lb

33300 lb

- Structure Notes:**
1. PER ASTM C478 SPECIFICATIONS.
 2. CONCRETE = 4,500 PSI AT 28 DAYS.
 3. REINFORCING PER ASTM A615 (GRADE 60)
 - TOP (As .62) #4 & #5 BAR AS SHOWN.
 - WALLS (As .18) WWF OR EQUIV.
 - FLOOR (As .20) #4 BAR AT 12" C/C E.W. DOUBLE MAT
 4. CASTING - JBS 1123 WT F/G "SANITARY" BY ICAST.

Structure Total: 33300 lb

THIS DRAWING IS INTENDED TO BE PRINTED IN COLOR.

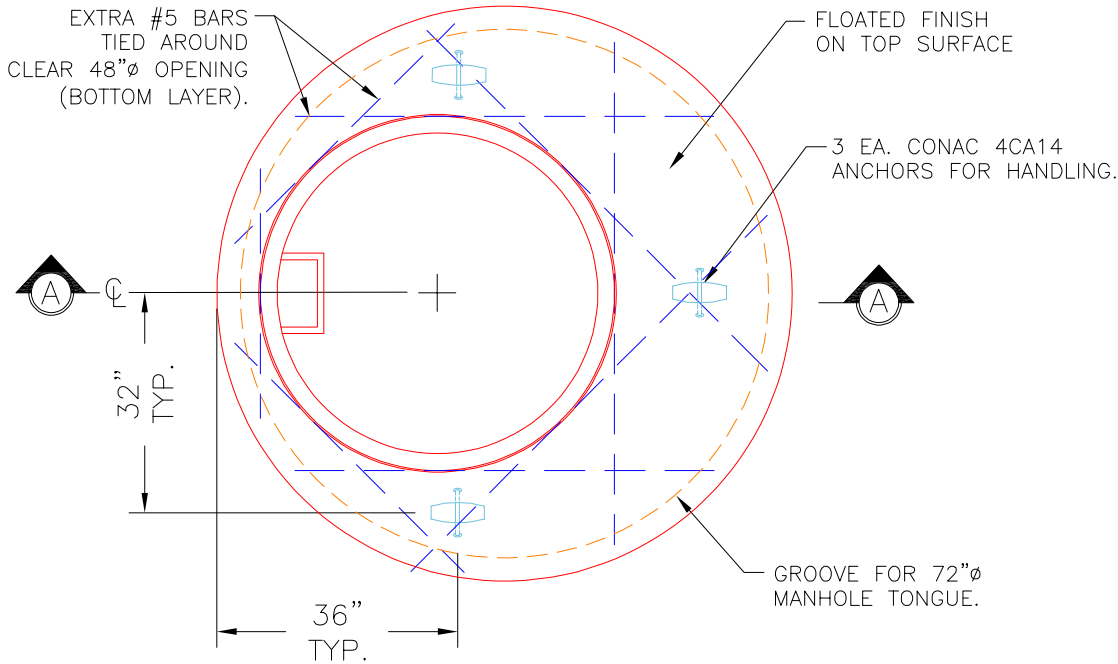

PLAN VIEW

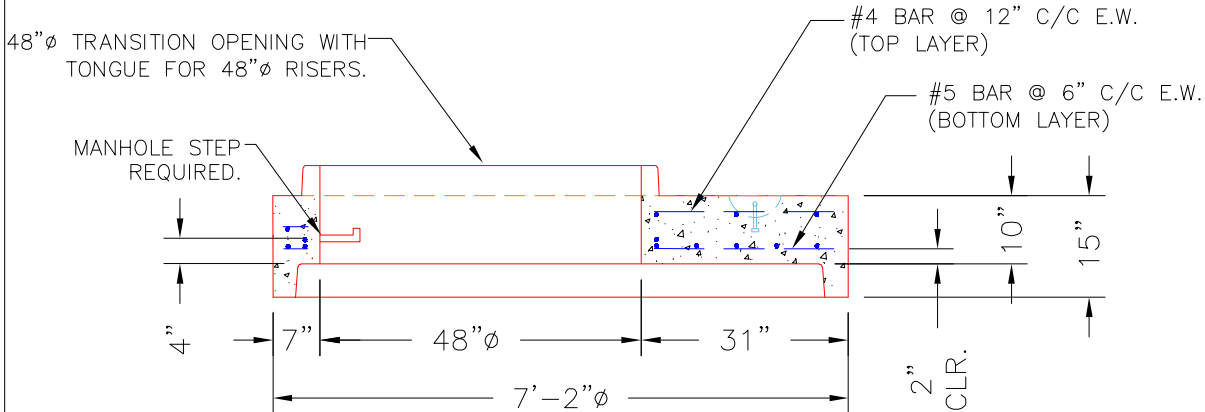

SECTION A-A

Coating (Int):
 Coating (Ext):

Seam Up: Tongue
 Seam Dn: Groove

Wall Thickness: 7"

Height (Ext): 15"

Weight (Net): 3864 lb
 Volume (Net): 0.99cu.yd