



Structure ID: MIT-R - MIT Modular Wall/Footing Right

P3 CVBS

32" x 234" MIT Section C - 32" x 234" MIT Section C - 32" x 234"

- GENERAL NOTES:**
1. MANUFACTURED TO ASTM C-913 (LATEST REVISION).
 2. CONCRETE: 4,000 PSI AT 28 DAYS.
 3. REINFORCING: #5 BAR @ 12" C-C E.W. SEE REINFORCEMENT CUT SHEET FOR ADDITIONAL INFORMATION.
 4. PER ASTM A615 (GRADE 60).
 5. 1/2" CHAMFER ON ALL EXPOSED EDGES.
 6. WEIGHT:
 FIRST POUR - 7,069 LBS
 SECOND POUR - 3,054 LBS
 TOTAL - 10,123 LBS EACH
 96 TOTAL REQUIRED

FIRST POUR DRAWING

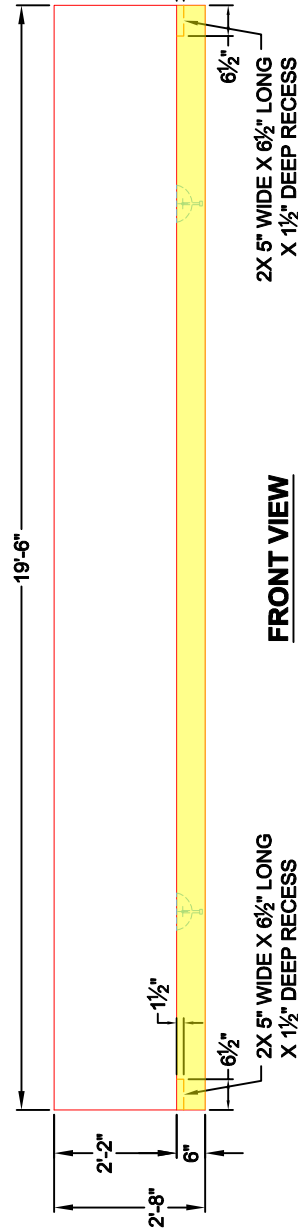
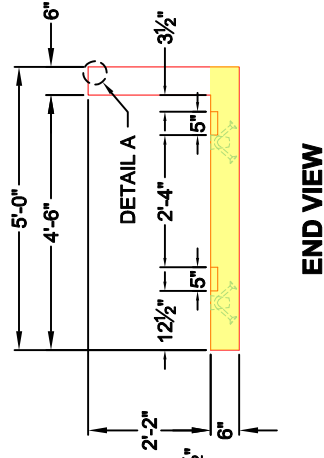
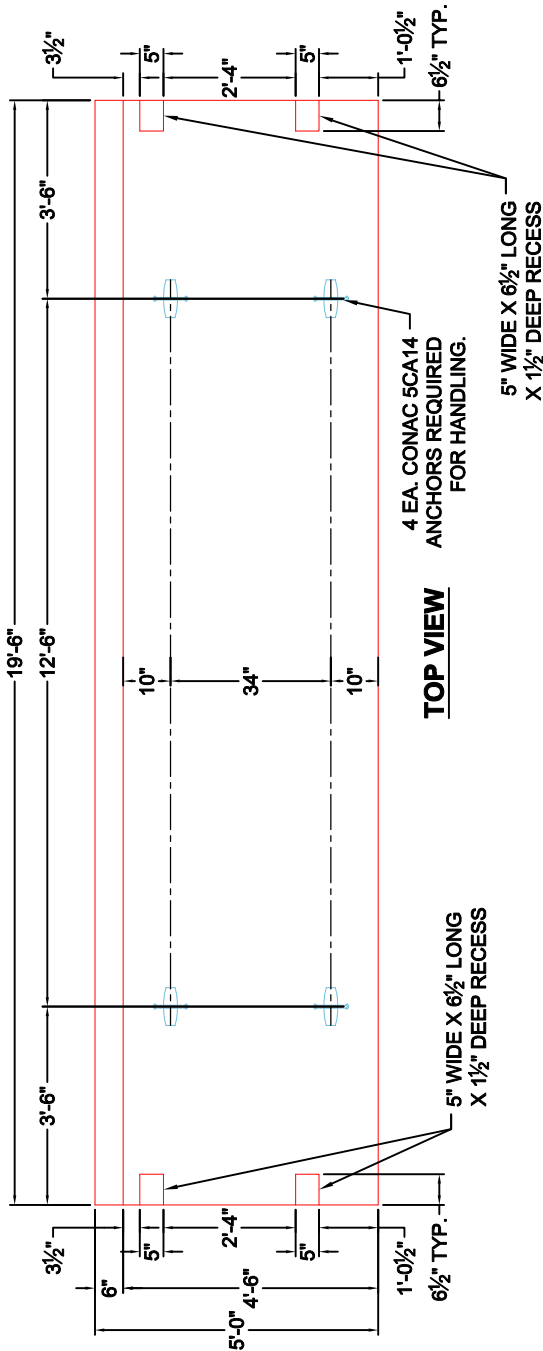
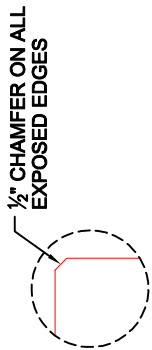



Structure ID: MIT-R - MIT Modular Wall/Footing Right

P3 CVBS

32" x 234" MIT Section C - 32" x 234" MIT Section C - 32" x 234"

REINFORCEMENT CUT SHEET

- GENERAL NOTES:**
1. MANUFACTURED TO ASTM C-913 (LATEST REVISION).
 2. CONCRETE: 4,000 PSI AT 28 DAYS.
 3. REINFORCING: #5 BAR @ 12" C-C E.W. SEE REINFORCEMENT CUT SHEET FOR ADDITIONAL INFORMATION.
 4. 1/2" CHAMFER ON ALL EXPOSED EDGES.
 5. WEIGHT:
 6. FIRST POUR - 7,069 LBS
 SECOND POUR - 3,054 LBS
 TOTAL - 10,123 LBS EACH
 96 TOTAL REQUIRED

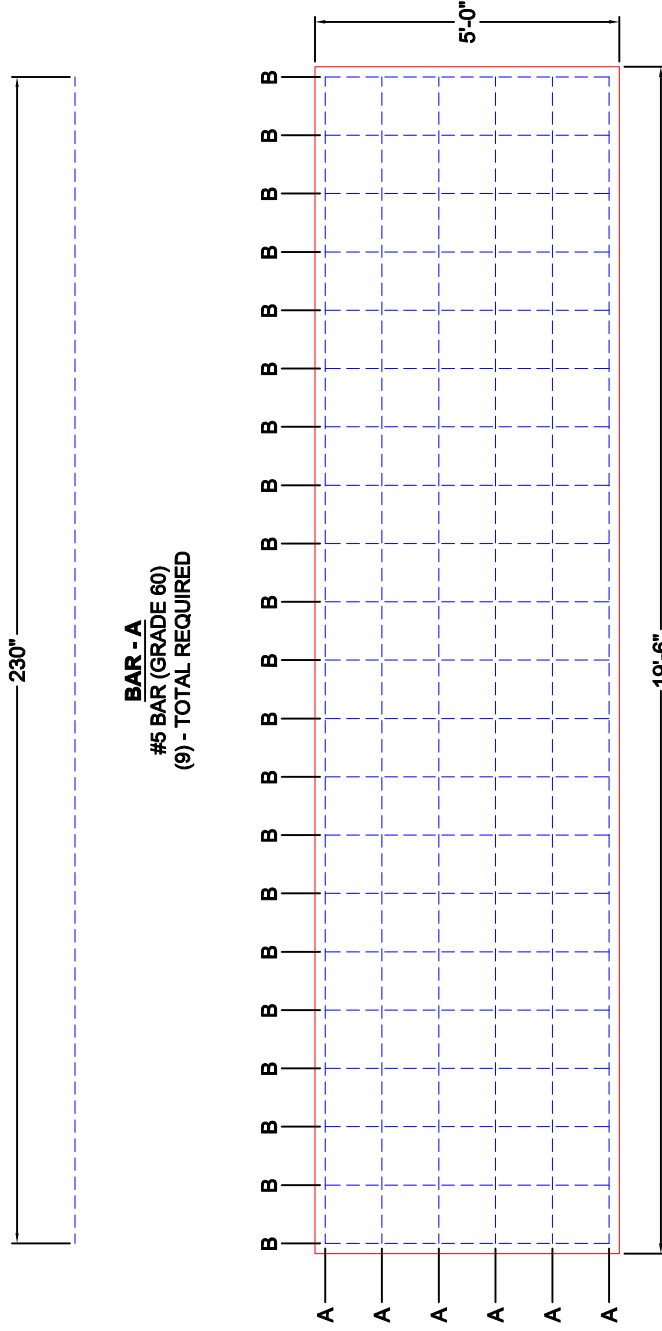

TOP VIEW

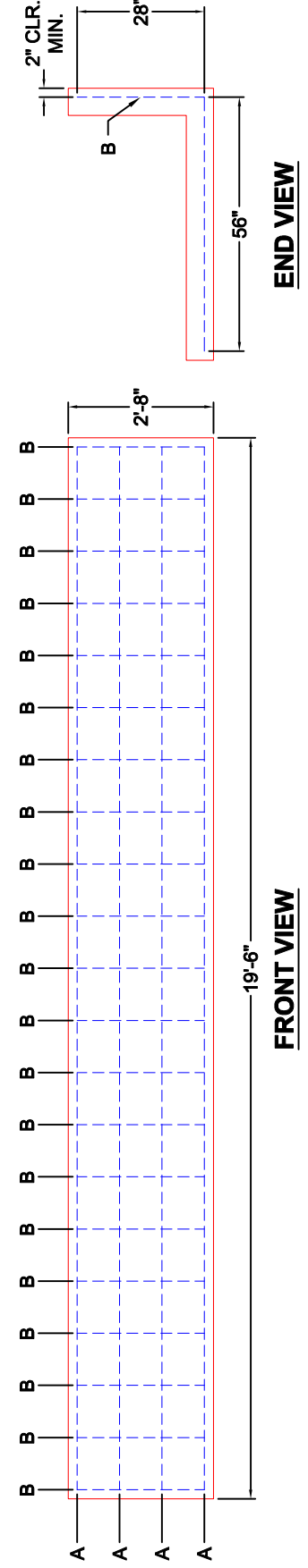

FRONT VIEW

END VIEW