

Job Name: 25-1026 Thompson's Station WWTP (Ph. 2)
 Job Location: Thompson's Station
 Contractor: W&O Construction

Plant: Beaver Dam

Tech: J. Coppage

10/15/2025 2:02:57 PM

PC: A. Chambers



Structure ID: SSMH-B

P1 MH048BA42X

MH BASE w/YYPEX

- P5) 24" - CASTING HEIGHT - 7"
- P4) 48" - ECC XYPEX CONE w/ 24" HOLE - 30"
- P3) 48" - MH RISER w/YYPEX - 72"
- P2) 48" - MH RISER w/YYPEX - 72"
- P1) 48" - MH BASE w/YYPEX - 42"
- 1) JOINT WRAP - 0.065"x6"x50' CONSEAL CS212
- 1) JOINT WRAP PRIMER - CONSEAL CS-75 (1 gal.)
- 1) 48" - MH INVERT CHANNEL w/YYPEX - FULL HEIGHT
- 1) CASTING - JBS 1150 F/C SANITARY
- 3) 48" - Conseal CS-102 1.00" (Double)
- 1) Kor-N-Seal2 - S206-22L
- 1) Kor-N-Seal2 - S206-18L
- 1) Kor-N-Seal2 - S206-22

- Structure Notes:**
1. JBS-1150 SANITARY PROVIDED BY ICAST.
 2. PER ASTM C478 SPECIFICATIONS.
 3. CONCRETE = 4,000 PSI AT 28 DAYS.
 4. REINFORCING PER ASTM A615 (GRADE 60).
- CONE (As .12)
 - RISER/WALLS (As .12)
 - FLOOR (As .31) #5 BARS AT 12" C.C.E.W.

Structure Total: 17576 lb

Rim: 738' Rim to Invert: 18.6' Slack: 2.2' Sump: 2' Step Position: 353°

Position	Elev	Angle	Ext. (cw)	Pipe	Pipe OD	Connector	Hole	Horz Size	Up ()	Offset
Invert 1	719.4'	180°	91.106"	18" DI	19.5"	Kor-N-Seal2 S206-22L	22"	22.854"	0"	0"
Invert 2	720.77'	270°	136.659"	15" PVC SDR35	15.3"	Kor-N-Seal2 S206-18L	18"	18.451"	16.94"	0"
Invert 3	719.5'	76°	38.467"	18" PVC SDR35	18.75"	Kor-N-Seal2 S206-22	22"	22.854"	1.2"	0"
Invert 4										
Invert 5										
Invert 6										
Invert 7										
Invert 8										

RIGHT-SIDE UP VIEW (int. dimensions)

UPSIDE-DOWN VIEW (int. dimensions)

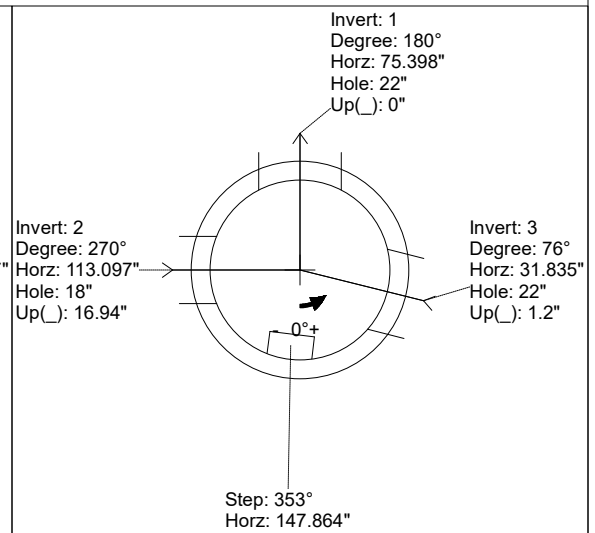
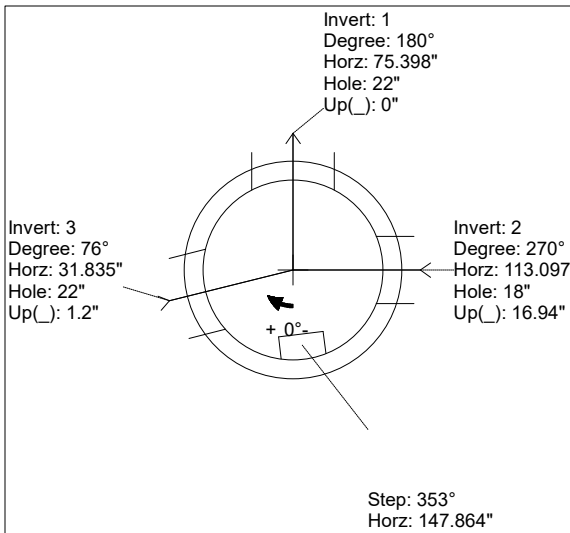
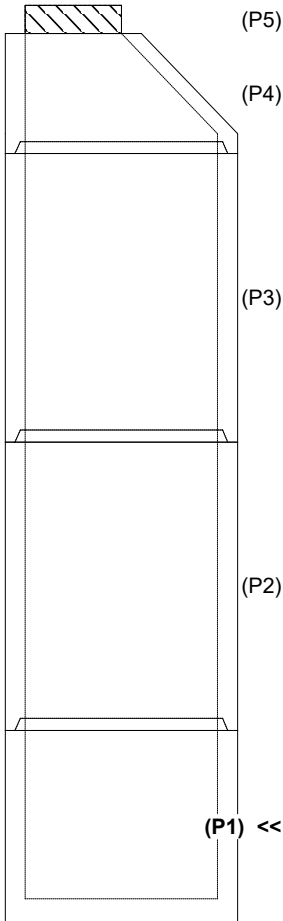

INSIDE WALL DIMENSIONS

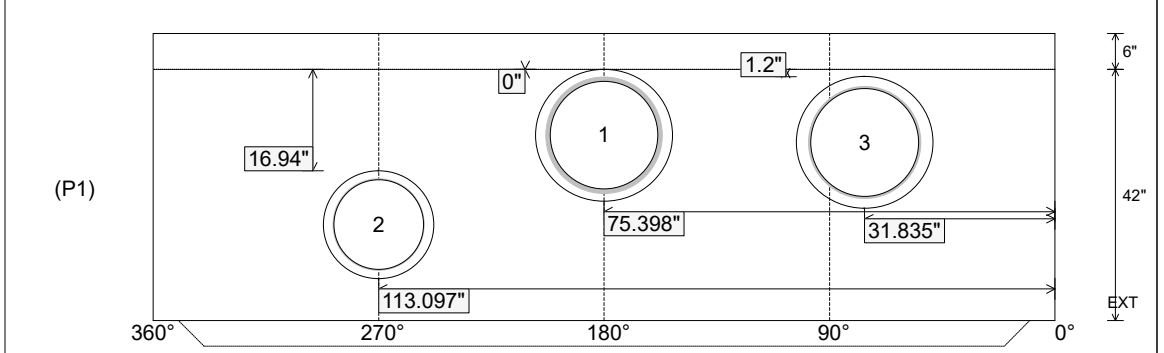

Coating (Int):
Coating (Ext):

Seam Up: Tongue
Seam Dn: n/a

Wall Thickness: 5"
Floor Height: 6"

Height (Int): 42"
Height (Ext): 48"

Weight (Net): 3826 lb
Volume (Net): 0.98cu.yd

Job Name: 25-1026 Thompson's Station WWTP (Ph. 2)
 Job Location: Thompson's Station
 Contractor: W&O Construction

Plant: Beaver Dam
 10/15/2025 2:02:57 PM

Tech: J. Coppage
 PC: A. Chambers



Structure ID: SSMH-B
P1 MH048BA42X

MH BASE w/XYPEX

- P5) 24" - CASTING HEIGHT - 7"
- P4) 48" - ECC XYPEX CONE w/ 24" HOLE - 30"
- P3) 48" - MH RISER w/XYPEX - 72"
- P2) 48" - MH RISER w/XYPEX - 72"
- P1) 48" - MH BASE w/XYPEX - 42"
- 1) JOINT WRAP - 0.065"x6"x50' CONSEAL CS212
- 1) JOINT WRAP PRIMER - CONSEAL CS-75 (1 gal.)
- 1) 48" - MH INVERT CHANNEL w/XYPEX - FULL HEIGHT
- 1) CASTING - JBS 1150 F/C SANITARY
- 3) 48" - Conseal CS-102 1.00" (Double)
- 1) Kor-N-Seal2 - S206-22L
- 1) Kor-N-Seal2 - S206-18L
- 1) Kor-N-Seal2 - S206-22

- Structure Notes:**
1. JBS-1150 SANITARY PROVIDED BY ICAST.
 2. PER ASTM C478 SPECIFICATIONS.
 3. CONCRETE = 4,000 PSI AT 28 DAYS.
 4. REINFORCING PER ASTM A615 (GRADE 60).
- CONE (As .12)
 - RISER/WALLS (As .12)
 - FLOOR (As .31) #5 BARS AT 12" C.C.E.W.

INVERT CHANNEL DRAWING
 FULL HEIGHT INVERT

Structure Total: 17576 lb

Rim: 738' Rim to Invert: 18.6' Slack: 2.2' Sump: 2' Step Position: 353°

Position	Elev	Angle	Ext. (cw)	Pipe	Pipe OD	Connector	Hole	Horz Size	Up ()	Offset
Invert 1	719.4'	180°	91.106"	18" DI	19.5"	Kor-N-Seal2 S206-22L	22"	22.854"	0"	0"
Invert 2	720.77'	270°	136.659"	15" PVC SDR35	15.3"	Kor-N-Seal2 S206-18L	18"	18.451"	16.94"	0"
Invert 3	719.5'	76°	38.467"	18" PVC SDR35	18.75"	Kor-N-Seal2 S206-22	22"	22.854"	1.2"	0"
Invert 4										
Invert 5										
Invert 6										
Invert 7										
Invert 8										

RIGHT-SIDE UP VIEW (int. dimensions)

UPSIDE-DOWN VIEW (int. dimensions)

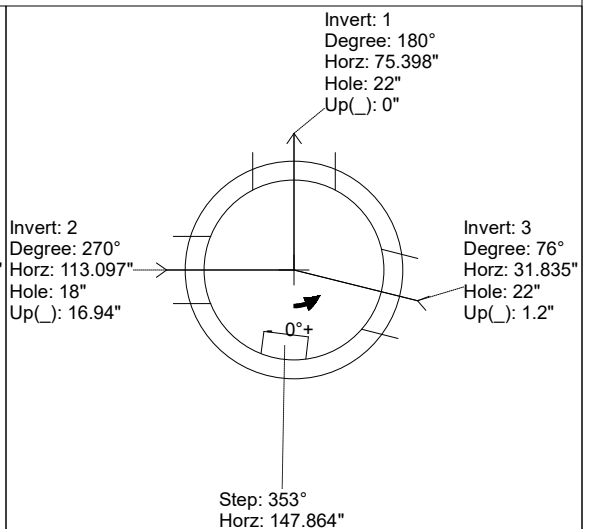
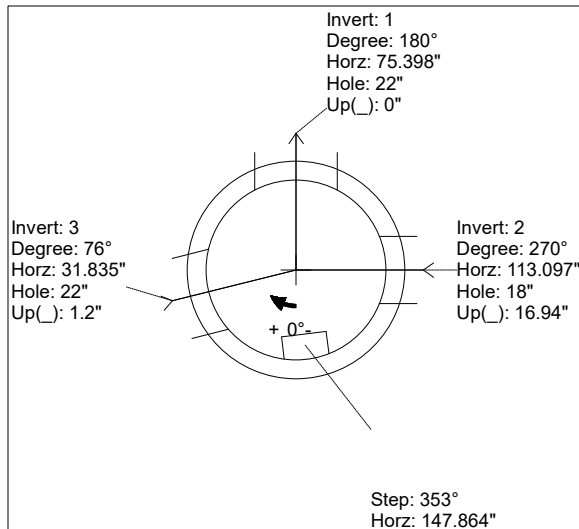
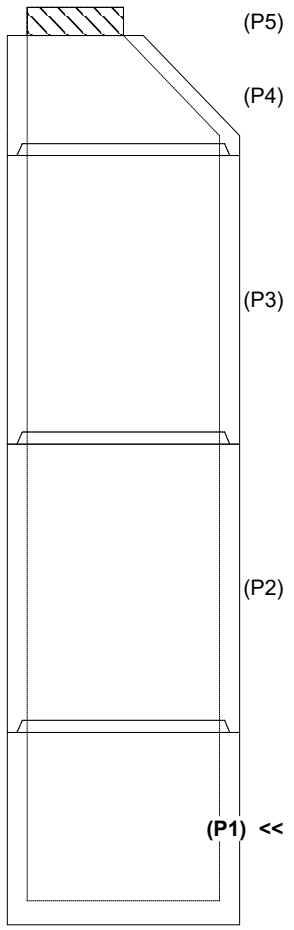

INSIDE WALL DIMENSIONS

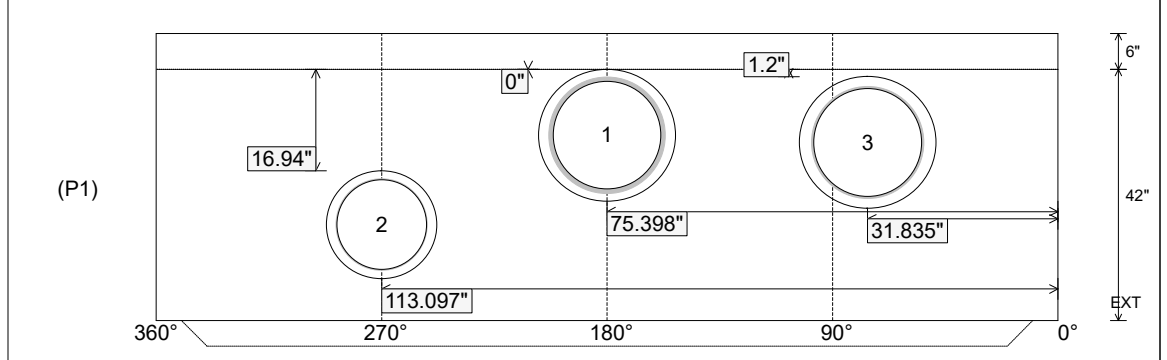

Coating (Int): Coating (Ext):	Seam Up: Tongue Seam Dn: n/a	Wall Thickness: 5" Floor Height: 6"	Height (Int): 42" Height (Ext): 48"	Weight (Net): 3826 lb Volume (Net): 0.98cu.yd
----------------------------------	---------------------------------	--	--	--