

Job Name: 24-4317 Sumner Co Regional Transmission Line C  
 Job Location: Gallatin, TN  
 Contractor: Endesol, Inc.

Plant: Beaver Dam

Tech: J. Coppage

12/9/2025 3:04:18 PM

PC: J. Jarvis



**Structure ID: Meter Box P208**

**P1 BX2436-08BVF**

**BOX BASE 8inW, 8inF, Variable Ht**

- P3) 24" x 36" - CASTING HEIGHT - 4"
- P2) 24" x 36" - BOX RISER 8inW - 30"
- P1) 24" x 36" - BOX BASE 8inW, 8inF, Variable Ht - 35"
- 2) 24" x 36" - Conseal CS-102 1.00"
- 2) Hole - 16
- 3) Hole - 4

0 lb  
 3036 lb  
 4698 lb  
 0 lb  
 0 lb  
 0 lb  
 -----  
 Structure Total: 7733 lb

Structure Notes:

1. JBS-8354 PROVIDED BY ICAST.
2. PER ASTM C913 SPECIFICATIONS.
3. CONCRETE = 5,000 PSI AT 28 DAYS.
4. REINFORCING PER ASTM A615 (GRADE 60).  
 - WALLS (As .12) #5 BARS AT 12" C.C.E.W.  
 - FLOOR (As .12) #5 BARS AT 12" C.C.E.W.

Rim: 746.5' Rim to Invert: 4.33' Slack: 0" Sump: 17.04" Step Position:

Position	Elev	Angle	Ext. (cw)	Pipe	Pipe OD	Connector	Hole	Horz Size	Up ( )	Offset
Invert 1	742.17'	90°	32"	12" DI	13"	Hole 16	16"	16"	15.04"	6"
Invert 2	742.17'	270°	20"	12" DI	13"	Hole 16	16"	16"	15.04"	-6"
Invert 3										
Invert 4										
Invert 5										
Invert 6										
Invert 7										
Invert 8										

RIGHT-SIDE UP VIEW (int. dimensions)

UPSIDE-DOWN VIEW (int. dimenions)

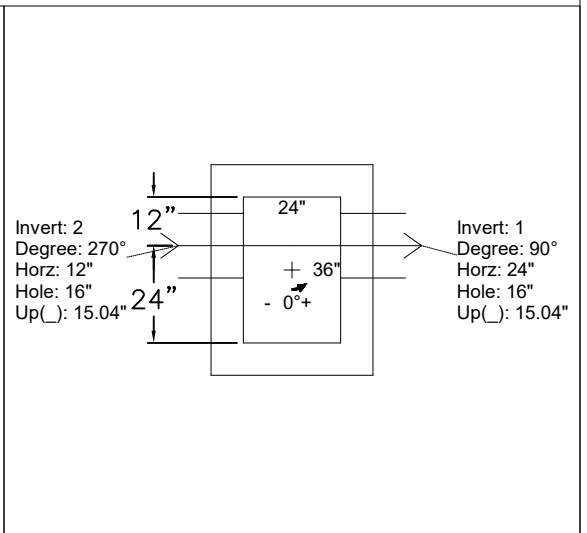
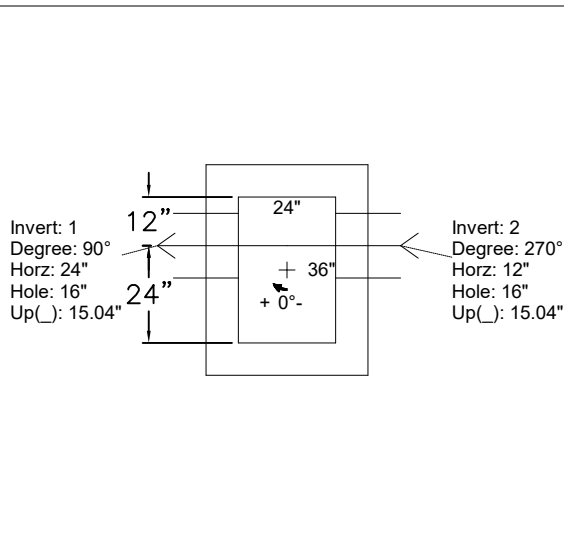
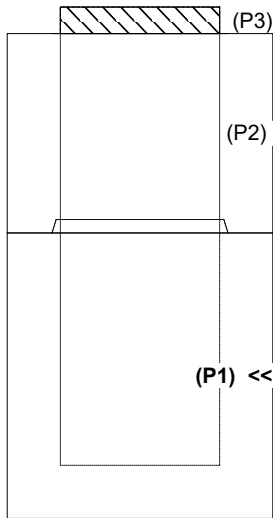

INSIDE WALL DIMENSIONS

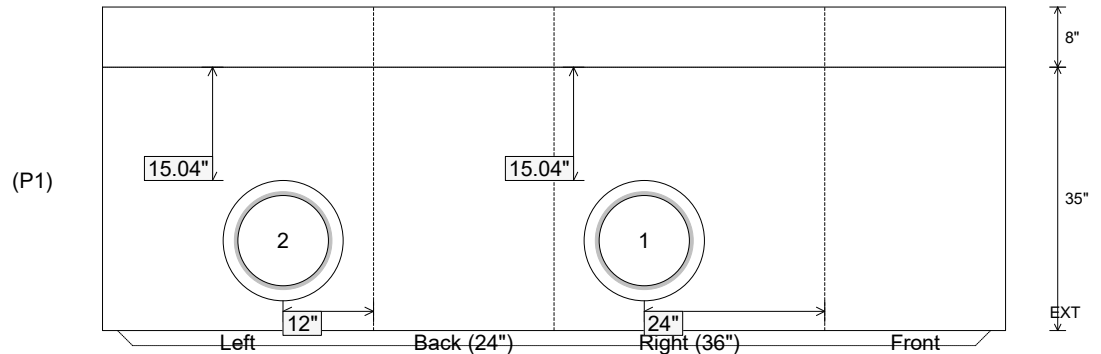

Coating (Int):  
 Coating (Ext):

Seam Up: Tongue  
 Seam Dn: n/a

Wall Thickness: 8"  
 Floor Height: 8"

Height (Int): 35"  
 Height (Ext): 43"

Weight (Net): 4698 lb  
 Volume (Net): 1.2cu.yd