

**Structure ID: SSMH 1 (Rev)**

**P1 MH048BA42**

**MH BASE Custom Ht T/n**

P3) 24" - CASTING HEIGHT - 4" P2) 48" - MH FLAT TOP w/ 24" ECC Hole F/G - 12" P1) 48" - MH BASE Custom Ht T/n - 42" 1) JOINT WRAP PRIMER - CONSEAL CS-75 (1 gal.) 1) JOINT WRAP - 0.065"x6"x50" CONSEAL CS212 1) 48" - SAN. INV. CHANNEL - FULL HEIGHT 1) 48" - Conseal CS-102 1.00" (Double) 3) PSX - 12-08 NYLO 3) MH Step ML-10-TDS-NCR - 10"	0 lb 1561 lb 4121 lb 0 lb 0 lb 1440 lb 0 lb 24 lb 0 lb ----- Structure Total: 7146 lb
--	---

**Structure Notes:**  
 STATION: 0+00 SAN LN A  
 1. PER KYTC & ASTM C-478 SPECS  
 2. CONCRETE: 5,000 PSI AT 28 DAYS  
 3. REINFORCEMENT: PER ASTM A615  
 4. INVERT CHANNEL REQUIRED  
 5. STEPS AT 270 DEGREES

REMAKE OF BASE & INVERT CHANNEL ONLY

Rim: 1040.91'    Rim to Invert: 4.7'    Slack: 0.4"    Sump: 2"    Step Position: 270°

Position	Elev	Angle	Ext. (cw)	Pipe	Pipe OD	Connector	Hole	Horz Size	Up ( )	Offset
Invert 1	1036.21'	0°	0"	8" PVC SDR35	8.5"	PSX 12-08 NYLO	12"	12.129"	0"	0"
Invert 2	1037.31'	139°	70.354"	8" PVC SDR35	8.5"	PSX 12-08 NYLO	12"	12.129"	13.2"	0"
Invert 3	1036.41'	180°	91.106"	8" PVC SDR35	8.5"	PSX 12-08 NYLO	12"	12.129"	2.4"	0"
Invert 4										
Invert 5										
Invert 6										
Invert 7										
Invert 8										

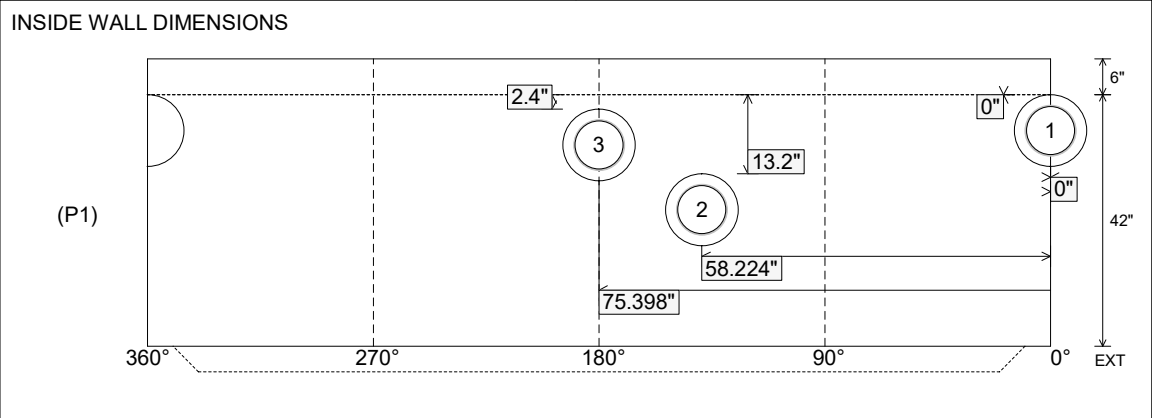
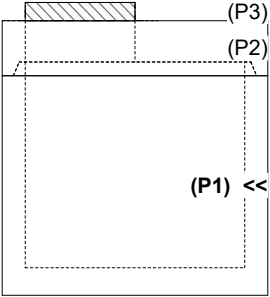
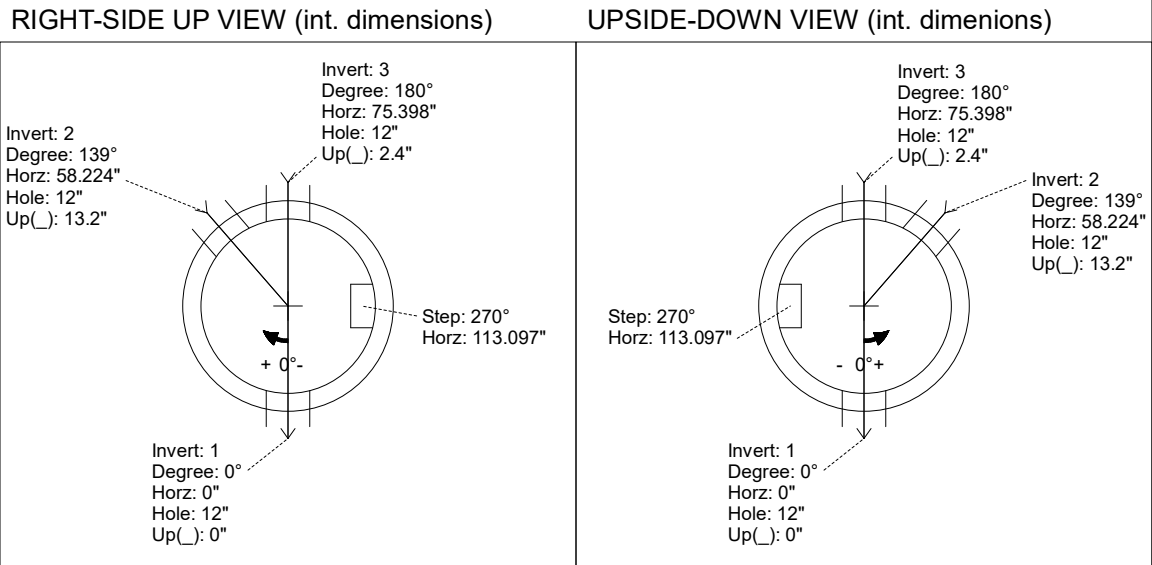

Coating (Int): Coating (Ext):	Seam Up: Tongue Seam Dn: n/a	Wall Thickness: 5" Floor Height: 6"	Height (Int): 42" Height (Ext): 48"	Weight (Net): 4121 lb Volume (Net): 1.05cu.yd
----------------------------------	---------------------------------	--	--	--

**Structure ID: SSMH 1 (Rev)**

**P1 MH048BA42**

**MH BASE Custom Ht T/n**

P3) 24" - CASTING HEIGHT - 4" P2) 48" - MH FLAT TOP w/ 24" ECC Hole F/G - 12" P1) 48" - MH BASE Custom Ht T/n - 42" 1) JOINT WRAP PRIMER - CONSEAL CS-75 (1 gal.) 1) JOINT WRAP - 0.065"x6"x50" CONSEAL CS212 1) 48" - SAN. INV. CHANNEL - FULL HEIGHT 1) 48" - Conseal CS-102 1.00" (Double) 3) PSX - 12-08 NYLO 3) MH Step ML-10-TDS-NCR - 10"	0 lb 1561 lb 4121 lb 0 lb 0 lb 1440 lb 0 lb 24 lb 0 lb ----- Structure Total: 7146 lb
--	---

Structure Notes:  
 STATION: 0+00 SAN LN A  
 1. PER KYTC & ASTM C-478 SPECS  
 2. CONCRETE: 5,000 PSI AT 28 DAYS  
 3. REINFORCEMENT: PER ASTM A615  
 4. INVERT CHANNEL REQUIRED  
 5. STEPS AT 270 DEGREES

**REMAKE OF BASE & INVERT CHANNEL ONLY**

Rim: 1040.91'    Rim to Invert: 4.7'    Slack: 0.4"    Sump: 2"    Step Position: 270°

Position	Elev	Angle	Ext. (cw)	Pipe	Pipe OD	Connector	Hole	Horz Size	Up ( )	Offset
Invert 1	1036.21'	0°	0"	8" PVC SDR35	8.5"	PSX 12-08 NYLO	12"	12.129"	0"	0"
Invert 2	1037.31'	139°	70.354"	8" PVC SDR35	8.5"	PSX 12-08 NYLO	12"	12.129"	13.2"	0"
Invert 3	1036.41'	180°	91.106"	8" PVC SDR35	8.5"	PSX 12-08 NYLO	12"	12.129"	2.4"	0"
Invert 4										
Invert 5										
Invert 6										
Invert 7										
Invert 8										

RIGHT-SIDE UP VIEW (int. dimensions)      UPSIDE-DOWN VIEW (int. dimenions)

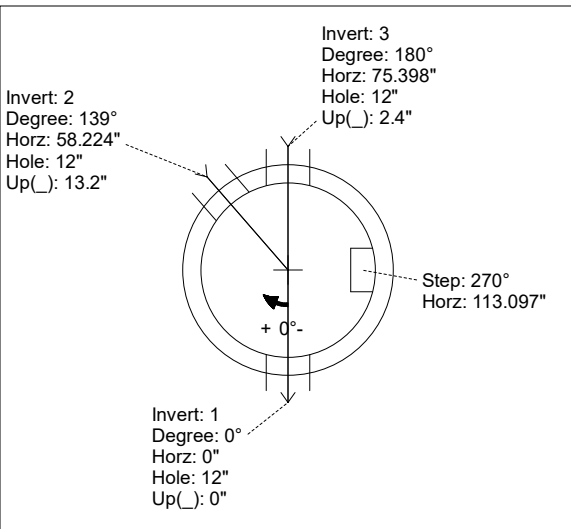

**INVERT CHANNEL DRAWING**

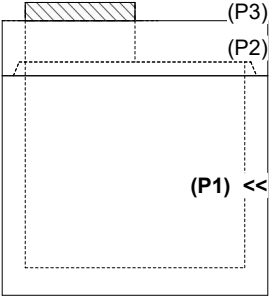

INSIDE WALL DIMENSIONS

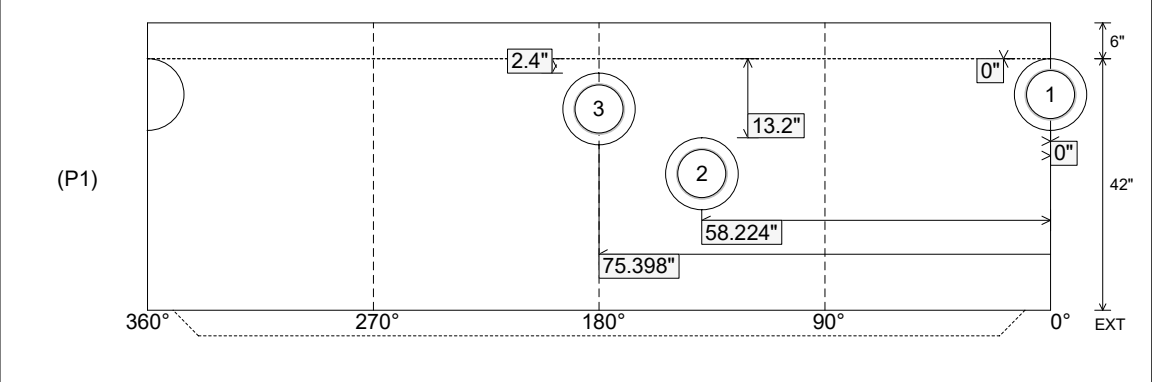

Coating (Int): Coating (Ext):	Seam Up: Tongue Seam Dn: n/a	Wall Thickness: 5" Floor Height: 6"	Height (Int): 42" Height (Ext): 48"	Weight (Net): 4121 lb Volume (Net): 1.05cu.yd
----------------------------------	---------------------------------	--	--	--