

Job Name: 24-3870 314 E Trinity
 Job Location: Nashville, TN
 Contractor: Hayes Pipe Supply

Plant: Beaver Dam

Tech: C.Russ

10/10/2025 11:18:33 AM

PC: E.Bradley



Structure ID: SCI A2

P1 BX3098_06BVF

BOX BASE 6inW, 6inF, Variable Ht

- P3) 28" x 28" - CASTING HEIGHT - 6"
- P2) 30" x 98" - BX FLAT LID 6inW w/28"x28" HOLE - 8"
- P1) 30" x 98" - BOX BASE 6inW, 6inF, Variable Ht - 41"
- 1) 28" x 28" - Conseal CS-102 1.00"
- 2) Hole - 22"

- Structure Notes:
1. PER ASTM C913 SPECIFICATIONS.
 2. CONCRETE = 4,000 PSI AT 28 DAYS.
 3. NO INVERT CHANNEL.
 4. CASTING BY OTHERS
 5. REINFORCING PER ASTM A615 (GRADE 60).
 - TOP SLAB (As .62) #5 BARS AT 6" C.C.E.W.
 - WALLS (As .12) #5 BARS AT 12" C.C.E.W.
 - FLOOR (As .12) #5 BARS AT 12" C.C.E.W.
 6. TOP SLAB TO HAVE 3/4" DEEP DROP KEY.

Structure Total: 10298 lb

FIRST POUR DRAWING

Rim: 535.75' Rim to Invert: 4.65' Slack: 0.8" Sump: 0" Step Position:

Position	Elev	Angle	Ext. (cw)	Pipe	Pipe OD	Connector	Hole	Horz Size	Up ()	Offset
Invert 1	531.1'	0°	21"	15" RCP B WALL	19.5"	Hole 22	22"	22"	-2.25"	0"
Invert 2	532.65'	90°	27"	15" RCP B WALL	19.5"	Hole 22	22"	22"	16.35"	-28"
Invert 3										
Invert 4										
Invert 5										
Invert 6										
Invert 7										
Invert 8										

RIGHT-SIDE UP VIEW (int. dimensions)

UPSIDE-DOWN VIEW (int. dimensions)

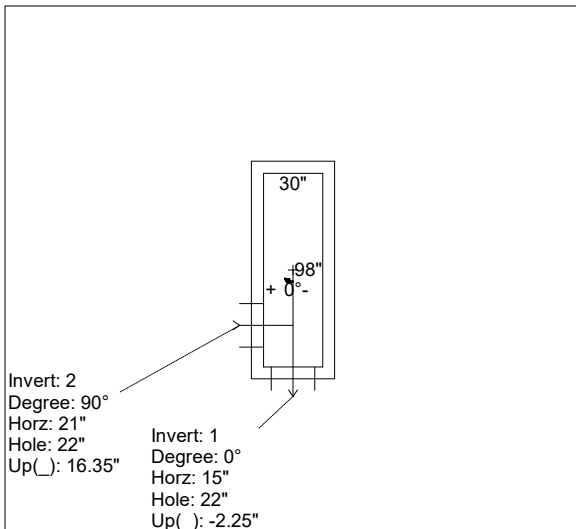
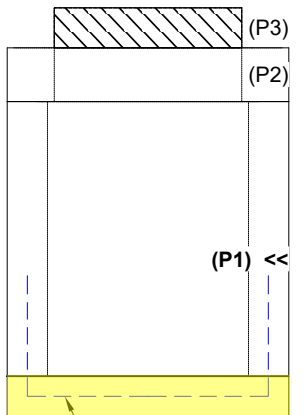

FIRST POUR - 2,326 LBS.
SECOND POUR - 5,397 LBS.
TOTAL - 7,723 LBS.

INSIDE WALL DIMENSIONS

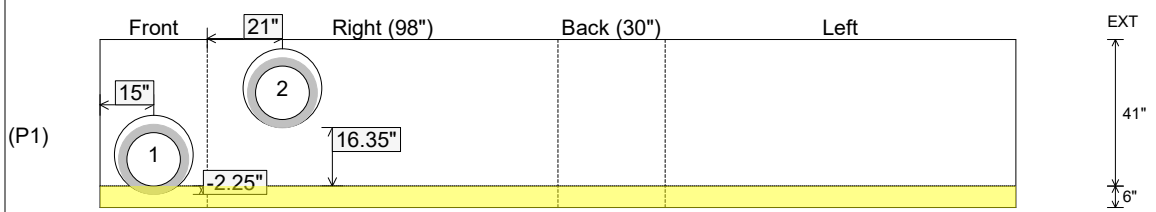

Coating (Int):
 Coating (Ext):

Seam Up: Flat
 Seam Dn: n/a

Wall Thickness: 6"
 Floor Height: 6"

Height (Int): 41"
 Height (Ext): 47"

Weight (Net): 7723 lb
 Volume (Net): 1.97cu.yd

Job Name: 24-3870 314 E Trinity
 Job Location: Nashville, TN
 Contractor: Hayes Pipe Supply

Plant: Beaver Dam

10/10/2025 11:18:33 AM

Tech: C.Russ

PC: E.Bradley



Structure ID: SCI A2

P1 BX3098_06BVF

BOX BASE 6inW, 6inF, Variable Ht

- P3) 28" x 28" - CASTING HEIGHT - 6"
- P2) 30" x 98" - BX FLAT LID 6inW w/28"x28" HOLE - 8"
- P1) 30" x 98" - BOX BASE 6inW, 6inF, Variable Ht - 41"
- 1) 28" x 28" - Conseal CS-102 1.00"
- 2) Hole - 22"

- Structure Notes:
1. PER ASTM C913 SPECIFICATIONS.
 2. CONCRETE = 4,000 PSI AT 28 DAYS.
 3. NO INVERT CHANNEL.
 4. CASTING BY OTHERS
 5. REINFORCING PER ASTM A615 (GRADE 60).
 - TOP SLAB (As .62) #5 BARS AT 6" C.C.E.W.
 - WALLS (As .12) #5 BARS AT 12" C.C.E.W.
 - FLOOR (As .12) #5 BARS AT 12" C.C.E.W.
 6. TOP SLAB TO HAVE 3/4" DEEP DROP KEY.

Structure Total: 10298 lb

SECOND POUR DRAWING

Rim: 535.75' Rim to Invert: 4.65' Slack: 0.8" Sump: 0" Step Position:

Position	Elev	Angle	Ext. (cw)	Pipe	Pipe OD	Connector	Hole	Horz Size	Up ()	Offset
Invert 1	531.1'	0°	21"	15" RCP B WALL	19.5"	Hole 22	22"	22"	-2.25"	0"
Invert 2	532.65'	90°	27"	15" RCP B WALL	19.5"	Hole 22	22"	22"	16.35"	-28"
Invert 3										
Invert 4										
Invert 5										
Invert 6										
Invert 7										
Invert 8										

RIGHT-SIDE UP VIEW (int. dimensions)

UPSIDE-DOWN VIEW (int. dimensions)

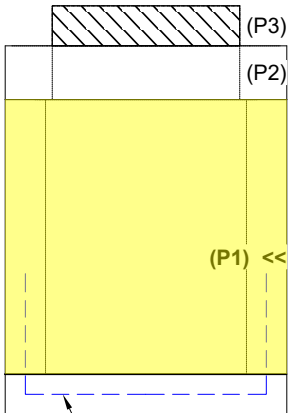

18" X 18" #5 BAR
 @ 12" ON CENTER
 TIED INTO THE MAT

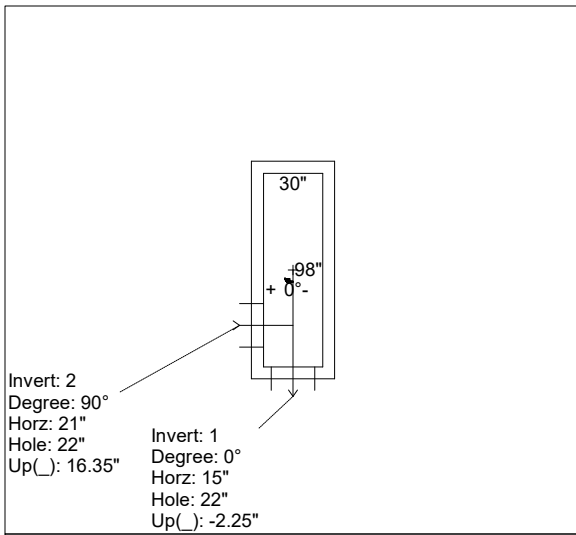

FIRST POUR - 2,326 LBS.
SECOND POUR - 5,397 LBS
TOTAL - 7,723 LBS.

INSIDE WALL DIMENSIONS

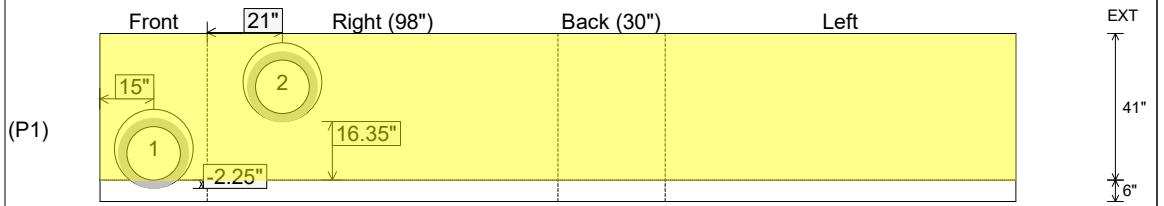

Coating (Int):
 Coating (Ext):

Seam Up: Flat
 Seam Dn: n/a

Wall Thickness: 6"
 Floor Height: 6"

Height (Int): 41"
 Height (Ext): 47"

Weight (Net): 7723 lb
 Volume (Net): 1.97cu.yd