

**Structure ID: 8**

**P1 MH048BA30CDARED**

**MH BASE w/ConBlock-CDA Red T/n**

- |  |  |   |
|--|--|---|
| P5) 24" - CASTING HEIGHT - 7"<br>P4) 24" - GRADE RING w/ConBlock-CDA Red F/F - 4"<br>P3) 48" - CON CONE w/24" HOLE, w/ConBlock-CDA Red F/G - 36"<br>P2) 48" - MH RISER w/ConBlock-CDA Red T/G - 48"<br>P1) 48" - MH BASE w/ConBlock-CDA Red T/n - 30"<br>1) JOINT WRAP - 0.065"x12"x50' CONSEAL CS212<br>1) JOINT WRAP PRIMER - CONSEAL CS-75 (1 gal.)<br>1) ADMIXTURE CONBLOCK CDA RED<br>1) 48" - MH INVERT CHANNEL w/ConBlock-CDA Red - FULL HEIGHT<br>1) CASTING - JBS 1150 F/C SANITARY<br>2) 48" - Conseal CS-102 1.00" (Double)<br>1) PSX - 12M NYLO<br>1) PSX - 12-08 NYLO<br>9) MH Step ML-10-TDS-NCR - 10" | 0 lb<br>270 lb<br>2251 lb<br>3353 lb<br>3330 lb<br>0 lb<br>0 lb<br>0 lb<br>1440 lb<br>250 lb<br>0 lb<br>8 lb<br>8 lb<br>0 lb | <b>Structure Notes:</b><br>1. PER ASTM C-478 SPECIFICATIONS<br>2. CONCRETE: 4,000 PSI AT 28 DAYS<br>3. REINFORCEMENT: PER ASTM A615<br>4. INVERT CHANNEL REQUIRED<br>5. CONBLOCK CDA RED ADMIXTURE REQUIRED<br>6. STEPS AT 269 DEGREES<br>7. CASTING BY ICAST (JBS 1150 FRAME & COVER "SANITARY") |
| <b>Structure Total:</b> 10910 lb   |  |   |

Rim: 552.07' Rim to Invert: 10.41' Slack: 1.92" Sump: 2" Step Position: 269°

Position	Elev	Angle	Ext. (cw)	Pipe	Pipe OD	Connector	Hole	Horz Size	Up ( )	Offset
Invert 1	541.66'	0°	0"	8" DI	9"	PSX 12M NYLO	12"	12.129"	0"	0"
Invert 2	541.86'	178°	90.094"	8" PVC SDR35	8.5"	PSX 12-08 NYLO	12"	12.129"	2.4"	0"
Invert 3										
Invert 4										
Invert 5										
Invert 6										
Invert 7										
Invert 8										

RIGHT-SIDE UP VIEW (int. dimensions)

UPSIDE-DOWN VIEW (int. dimensions)

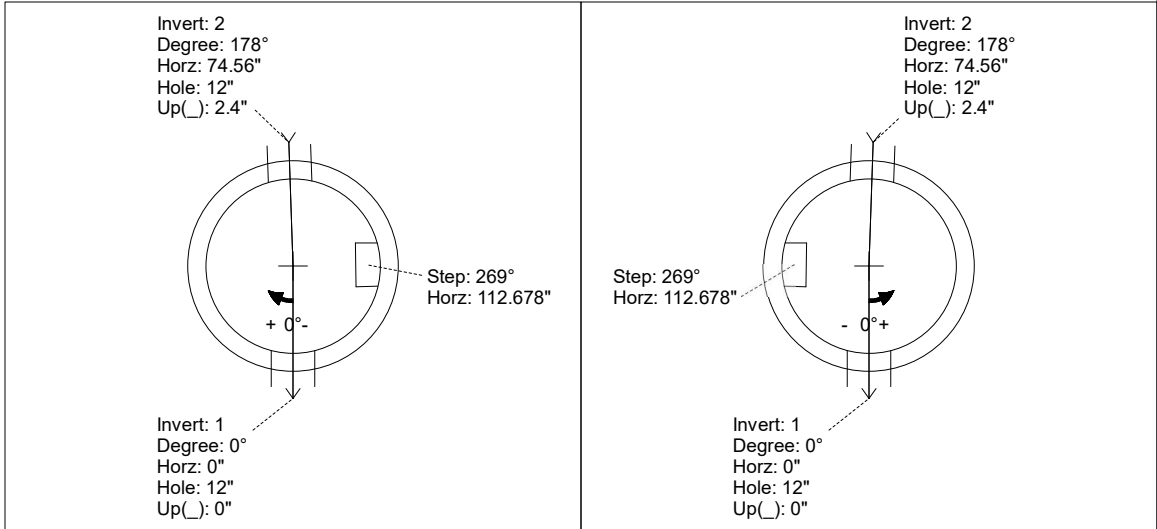
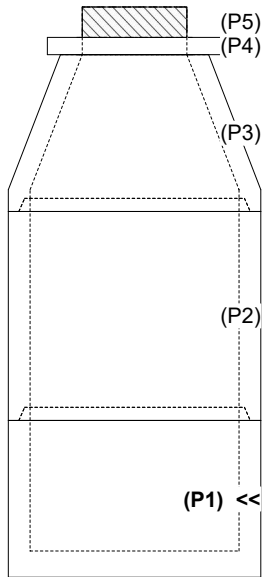

INSIDE WALL DIMENSIONS

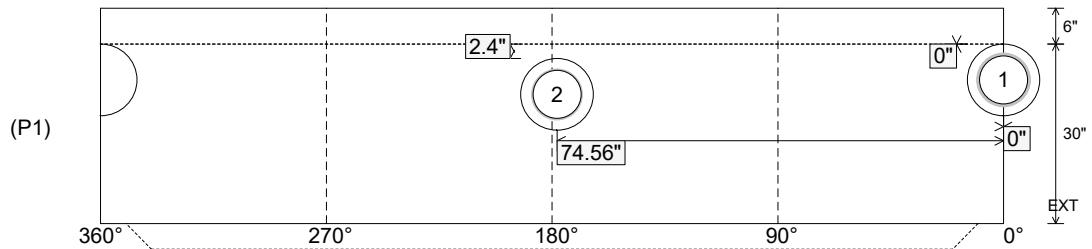

Coating (Int): Coating (Ext):	Seam Up: Tongue Seam Dn: n/a	Wall Thickness: 5" Floor Height: 6"	Height (Int): 30" Height (Ext): 36"	Weight (Net): 3330 lb Volume (Net): 0.85cu.yd
----------------------------------	---------------------------------	--	--	--

