

Job Name: 24-2716 905 E Trinity
 Job Location: Nashville, TN
 Contractor: Hayes Pipe Supply

Plant: Beaver Dam, KY
 10/14/2025 9:36:01 AM

Tech: K. Cardwell
 PC: A. Chambers



Structure ID: B1

P3 MH048CN36

ECC CONE w/ 24" HOLE F/G

- P5) 24" - CASTING HEIGHT - 7"
- P4) 24" - GRADE RING F/F - 4"
- P3) 48" - ECC CONE w/ 24" HOLE F/G - 36"
- P2) 48" - MH RISER T/G - 48"
- P1) 48" - MH BASE T/n - 36"
- 2) 48" - Conseal CS-102 1.00"
- 2) Hole - 26
- 10) MH Step ML-10-TDS-NCR - 10"

0 lb
 270 lb
 3000 lb
 3353 lb
 3379 lb
 0 lb
 0 lb
 0 lb

 10002 lb

Structure Total:

- Structure Notes:
1. PER ASTM C-478 SPECS
 2. CONCRETE: 4,000 PSI AT 28 DAYS
 3. REINFORCEMENT: PER ASTM A615
 4. STEPS AT 238 DEGREES
 5. CASTING: JBS 1150 "STORM" SUPPLIED BY OTHERS

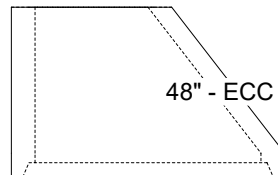
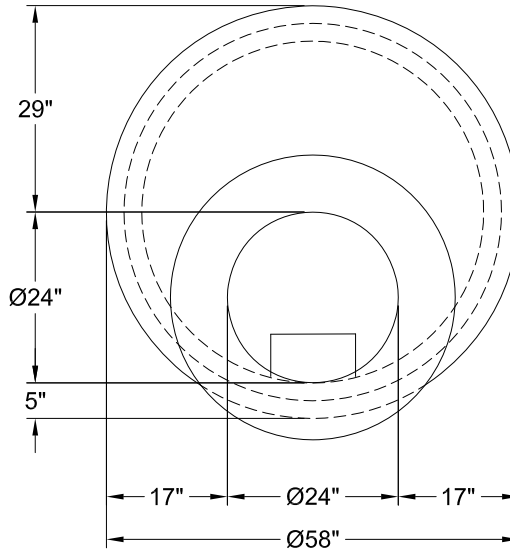

Coating (Int):
 Coating (Ext):

Seam Up: Flat
 Seam Dn: Groove

Wall Thickness: 5"

Height (Ext): 36"

Weight (Net): 3000 lb
 Volume (Net): 0.5cu.yd