

**GENERAL NOTES:**

1. MANUFACTURED TO ASTM C-913 (LATEST REVISION)
2. CONCRETE: 5,000 PSI AT 28 DAYS
3. REINFORCEMENT: #5 BAR @ 8" C.C. E.W. (GRADE 60)
4. WEIGHT: 21,010 LBS
5. CONTRACTOR TO VERIFY ALL DIMENSIONS BEFORE MANUFACTURE
6. JR HOE KY-65A (KYTC DBI TY 12A) FRAMES & BOLTED GRATES SUPPLIED BY ICAST
7. KY-65A FRAMES TO BE CAST INTO TOP OF WALLS

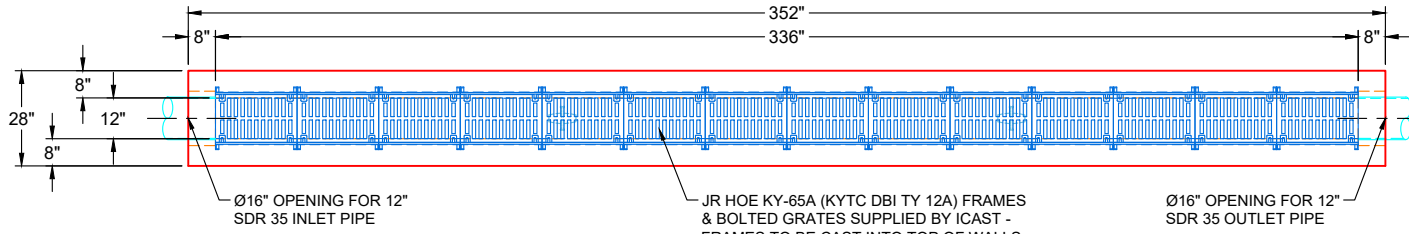

**PLAN VIEW**

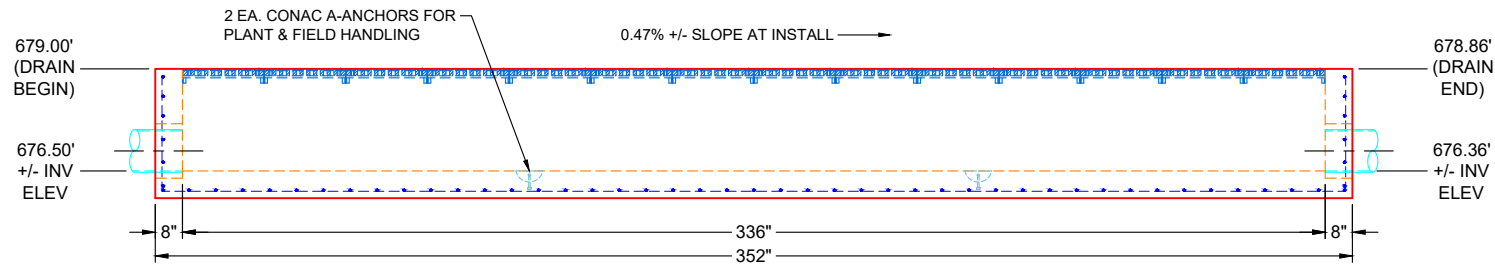

**FRONT VIEW**

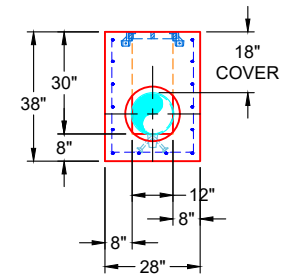

**SIDE VIEW**

**REVISION INFORMATION**

REV.	DATE	DESCRIPTION
NO REVISIONS TO DATE		



SUBMITTAL DRAWING: 1'-0" X 2'-6" X 28'-0" TRENCH DRAIN		
CUSTOMER: PHILLIPS BROS. CONSTRUCTION, LLC		
PROJECT: CHILD DEVELOPMENT CENTER		
STRUCTURE: TRENCH DRAIN		
QUOTE/SALES ORDER NO: 24-2512		
CHECKED BY: B. SMITH	DRAWN BY: K. CARDWELL	
DATE: 09/10/25	SCALE: NTS	PG. 1 OF 1