

Job Name: 24-2287 Freedom Senior Apartments
 Job Location: Lexington, KY
 Contractor: Lagco Inc.

Plant: Beaver Dam, KY
 10/14/2025 11:58:02 AM

Tech: Evan Niles
 PC: Celina Goff



Structure ID: OCS-111

P2 BX242408-VF

BOX RISER 8inW, Variable Ht

- P3) 24" x 24" - CASTING HEIGHT - 0"
- P2) 24" x 24" - BOX RISER 8inW, Variable Ht - 34"
- P1) 24" x 24" - BOX BASE 8inW, 8inF, Variable Ht - 32"
- 1) CASTING - TRASHRACKS LVT-2424-G Inlet Grate
- 2) 24" x 24" - SGL 1"x14.5' Butyl
- 1) Hole - 16
- 1) Hole - 10
- 1) Hole - 8
- 1) SQ. Hole - 12"x12"

0 lb Structure Notes:
 2791 lb 1. PER ASTM C913 SPECIFICATIONS.
 3636 lb 2. CONCRETE = 4,000 PSI AT 28 DAYS.
 61 lb 3. NO INVERT CHANNEL.
 0 lb
 0 lb REINFORCING PER ASTM A615 (GRADE 60).
 0 lb - WALLS (As .12) #5 BARS AT 12" C.C.E.W.
 0 lb - FLOOR (As .12) #5 BARS AT 12" C.C.E.W.
 0 lb 4. CASTING: LVT-2424 TRASH RACK BY OTHERS

Structure Total: 6488 lb

Rim: 994' Rim to Invert: 5.5' Slack: 0" Sump: 0" Step Position:

Position	Elev	Angle	Ext. (cw)	Pipe	Pipe OD	Connector	Hole	Horz Size	Up ()	Offset
Invert 1										
Invert 2										
Invert 3	992'	180°	20"	8" Orifice	8"	Hole 8	8"	8"	8"	0"
Invert 4	993'	270°	20"	12" x 12" Weir	12" x 12"	SQ. Hole 12"x12"	12" x 12"	12"	20"	0"
Invert 5										
Invert 6										
Invert 7										
Invert 8										

RIGHT-SIDE UP VIEW (int. dimensions)

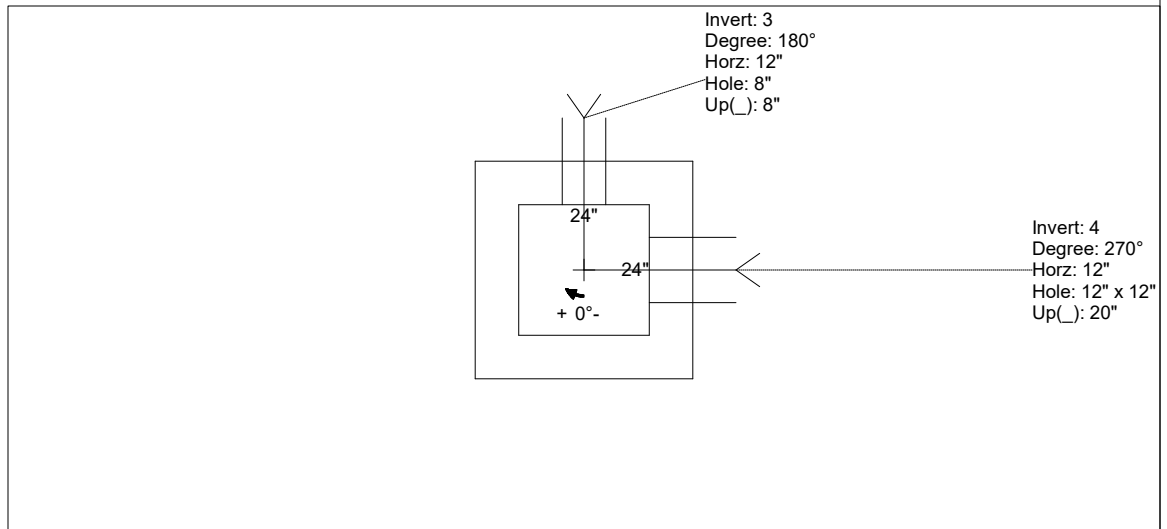
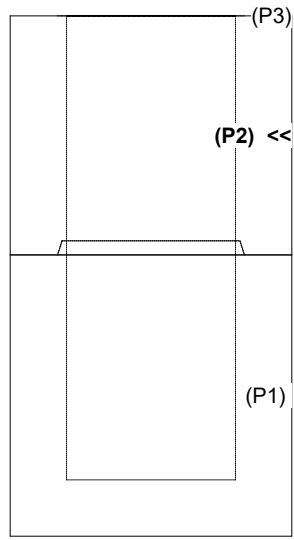

INSIDE WALL DIMENSIONS

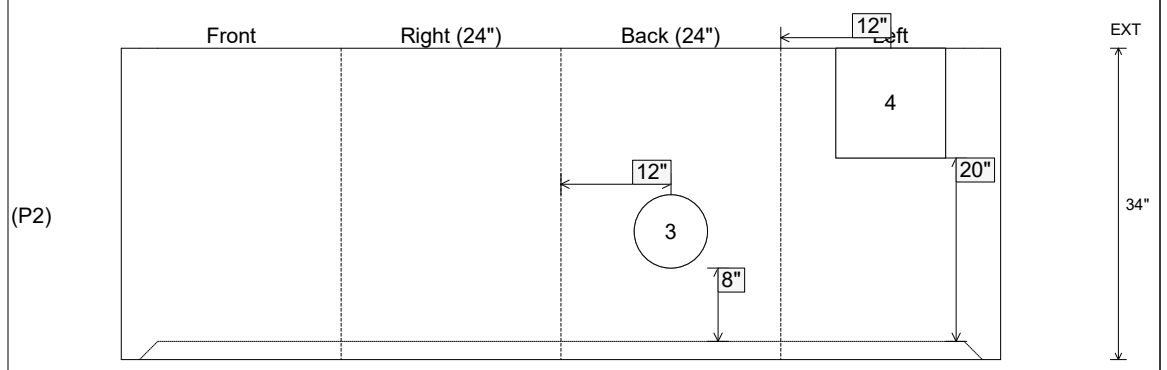

Coating (Int): Coating (Ext):	Seam Up: Flat Seam Dn: Groove	Wall Thickness: 8" Floor Height: 0"	Height (Int): 34" Height (Ext): 34"	Weight (Net): 2791 lb Volume (Net): 0.71cu.yd
----------------------------------	----------------------------------	----------------------------------------	----------------------------------------	--------------------------------------------------