

Job Name: 23-1914 - KYTC Daviess County ID 231032
 Job Location: Owensboro, KY 42701
 Contractor: Mick-Murf Construction Inc.

Plant: 100

Tech: J. Horsley

1/13/2026 11:49:30 AM

PC: C. Goff



Structure ID: 087B (KY B 10ft)

P2 BX036060-0808TS2424

BX TRANS. SLAB 8inW w/24"x24" HOLE ECC T/F

- P6) 8" x 120" - CB INLET KY B 10' TOP F/G - 9"
- P5) 24" x 120" - CB INLET KY B 10' BOTTOM LEFT T/G - 17"
- P4) 24" x 24" - FIELD ADJUSTMENT - 3"
- P3) 24" x 24" - BOX RISER 8inW, Variable Ht F/G - 26"
- P2) 36" x 60" - BX TRANS. SLAB 8inW w/24"x24" HOLE ECC T/F - 8"
- P1) 36" x 60" - BOX BASE 8inW, 8inF, Variable Ht F/n - 72"
- 1) 36" x 60" - Conseal CS-102 1.00"
- 2) 24" x 24" - Conseal CS-102 1.00"
- 1) Hole - 46
- 1) Hole - 22
- 1) Hole - 40
- 1) Hole - 6

- 1660 lb
- 2650 lb
- 0 lb
- 2215 lb
- 2266 lb
- 11265 lb
- 0 lb
- 0 lb
- 0 lb
- 0 lb
- 0 lb
- 0 lb

Structure Total: 20057 lb

Structure Notes:

- ** KYTC STATE PROJECT **
 - 1. PER KYTC CBI TYPE B / ASTM C913 SPEC'S.
 - 2. CONCRETE = 4,000 PI AT 28 DAYS.
 - 3. NO STEPS & NO INVERT CHANNEL.
 - 5. CBI KY B F/G - BY OTHERS.
- REINFORCING PER ASTM A615 (GRADE 60).
 - TOP PHASE (As .62) #5 BARS AT 6" C.C.E.W.
 - TRANS SLAB (As .62) #5 BARS AT 6" C.C.E.W. (DBL MAT.)
 - WALLS/FLOOR (As .31) #5 BARS AT 12" C.C.E.W.

REINFORCEMENT CUT LIST				
BAR	QTY	MATERIAL	LENGTH	SHAPE
R1	12	#5 BAR	5'-0"	STR
R2	8	#5 BAR	3'-4"	STR
R3	20	#5 BAR	4'-0"	STR
R4	16	#5 BAR	0'-10"	STR
R5	8	#5 BAR	1'-6"	STR

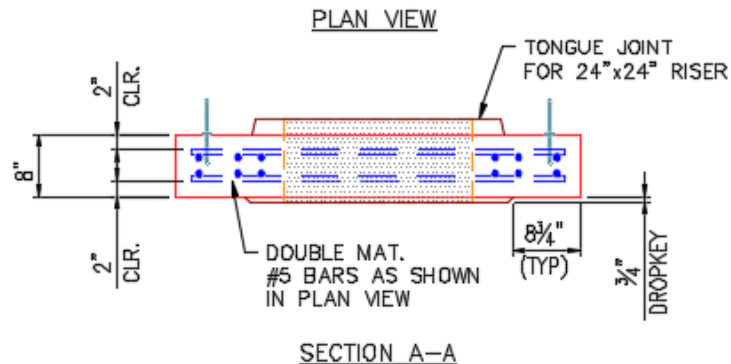
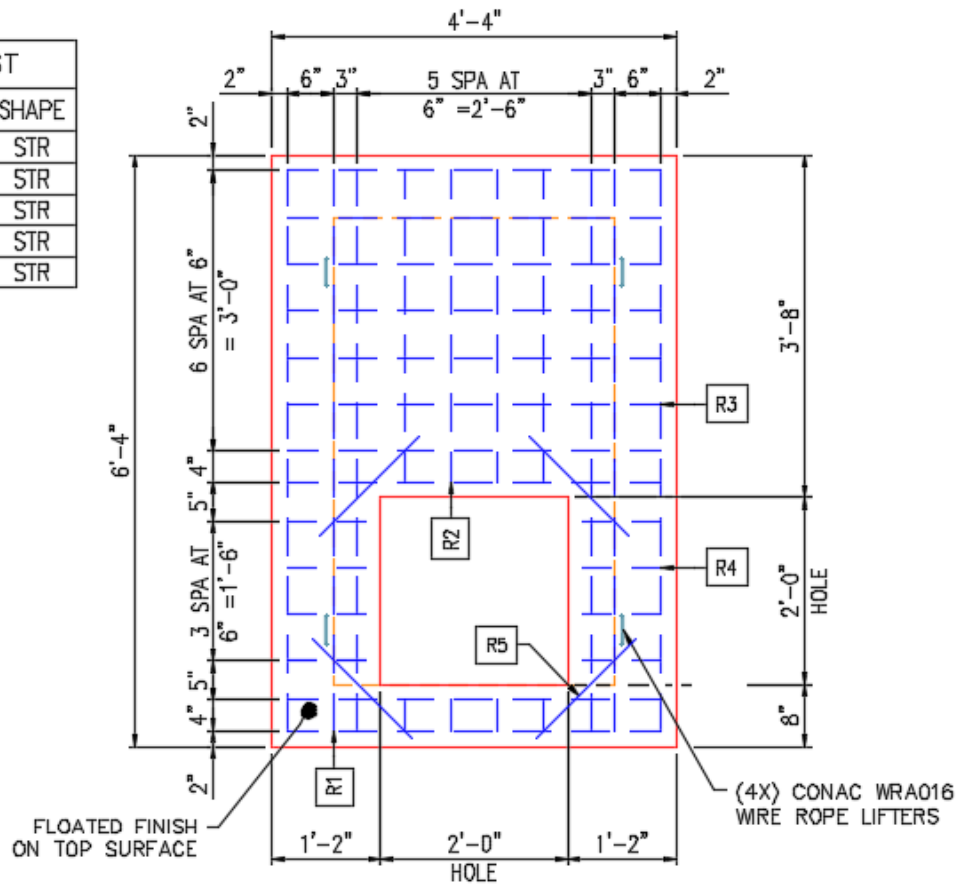

Coating (Int):
 Coating (Ext):

Seam Up: Tongue
 Seam Dn: Flat

Wall Thickness: 8"

Height (Ext): 8"

Weight (Net): 2266 lb
 Volume (Net): 0.58cu.yd