

Job Name: 26-1227 - Project Colt
 Job Location: Evansville, IN
 Contractor: Russell's Excavating

Plant: 100
 5/12/2026 11:30:16 AM

Tech: Jared - F
 PC: A. Chambers



Structure ID: 101-11 MHJ

P1 MH060BA60

MH BASE F/n

- P3) 24" x 36" - CASTING HEIGHT - 4"
- P2) 60" - MH FLAT TOP w/24"x36" Hole F/F - 8"
- P1) 60" - MH BASE F/n - 60"
- 1) CASTING - HOE 518 F/G
- 1) 60" - Conseal CS-102 1.00"
- 1) 24" x 36" - Conseal CS-102 1.00"
- 1) Hole - 44
- 1) Hole - 38
- 2) Hole - 6
- 5) MH Step ML-10-TDS-NCR - 10"

0 lb
 2153 lb
 7517 lb
 354 lb
 0 lb
 0 lb
 0 lb
 0 lb
 0 lb
 0 lb
 0 lb
 10024 lb

- Structure Notes:**
1. INDOT MH TYPE J / ASTM C478 SPEC'S.
 2. CONCRETE = 4,000 PSI AT 28 DAYS.
 3. NO INVERT CHANNEL.
 4. CASTING BY ICAST (HOE 518 F/G).

REINFORCING PER ASTM A615 (GRADE 60).
 - TOP SLAB (As .62) #5 BARS AT 6" C.C.E.W..
 - RISER/WALLS (As .12)
 - FLOOR (As .62) #5 BARS AT 6" C.C.E.W.

Structure Total: 10024 lb

Rim: 385.15' Rim to Invert: 5.8' Slack: 0.475" Sump: 2.875" Step Position: 90°

Position	Elev	Angle	Ext. (cw)	Pipe	Pipe OD	Connector	Hole	Horz Size	Up (⌋)	Offset
Invert 1	379.35'	0°	0"	36" HDPE	41.7"	Hole 44	44"	49.393"	0"	0"
Invert 2	379.35'	192°	120.625"	30" HDPE	35.1"	Hole 38	38"	41.151"	0.375"	0"
Invert 3	383.1'	35°	22"	4" HDPE (perf pipe)	4.8"	Hole 6	6"	6.01"	47.5"	0"
Invert 4	383.1'	125°	78.5"	4" HDPE (perf pipe)	4.8"	Hole 6	6"	6.01"	47.5"	0"
Invert 5										
Invert 6										
Invert 7										
Invert 8										

RIGHT-SIDE UP VIEW (int. dimensions)

UPSIDE-DOWN VIEW (int. dimensions)

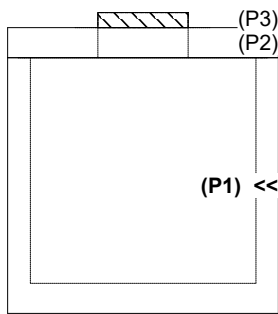
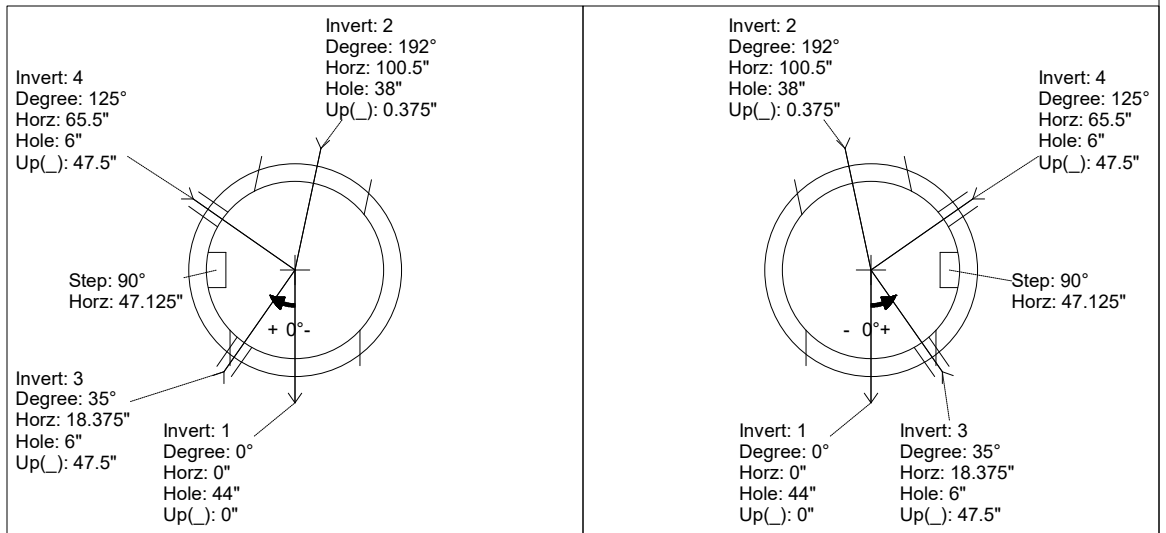

INSIDE WALL DIMENSIONS

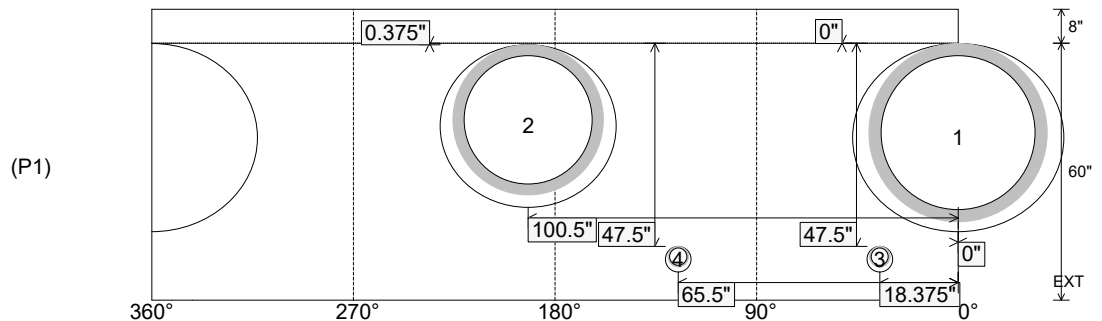

Coating (Int):
 Coating (Ext):

Seam Up: Flat
 Seam Dn: n/a

Wall Thickness: 6"
 Floor Height: 8"

Height (Int): 60"
 Height (Ext): 68"

Weight (Net): 7517 lb
 Volume (Net): 1.92cu.yd