

Job Name: 24-1164 Paddy's Run Flood PS
 Job Location: Louisville, Ky.
 Contractor: Core & Main LP (Lou)

Plant: Beaver Dam, Ky.
 5/18/2026 8:15:27 AM

Tech: S. Felletter
 PC:



Structure ID: MH 2 (2+91)

P1 MH048BA24

MH BASE T/n

- P3) 24" - CASTING HEIGHT - 7"
- P2) 48" - ECC CONE w/ 24" HOLE F/G - 24"
- P1) 48" - MH BASE T/n - 24"
- 1) 48" - STORM INVERT CHANNEL - 1/4 HEIGHT
- 1) JOINT WRAP - 0.065"x6"x50' CONSEAL CS212
- 1) JOINT WRAP PRIMER - CONSEAL CS-75 (1 gal.)
- 1) Chimney Seal - Trelleborg FlexRib Chimney Seal
- 1) CASTING - HOE WT-420-MSD F/C Storm
- 1) 48" - Conseal CS-102 1.00" (Double)
- 2) PSX - 18M DD
- 4) MH Step ML-10-TDS-NCR - 10"

0 lb
 1550 lb
 2789 lb
 1075 lb
 0 lb
 0 lb
 10 lb
 340 lb
 0 lb
 16 lb
 0 lb

 Structure Total: 5780 lb

Structure Notes: 1. PER ASTM C478 & MSD SPECIFICATIONS.
 2. CONCRETE = 5,000 PSI AT 28 DAYS.
 3. CASTING BY ICST (HOE MC-420).
 REINFORCING PER ASTM A615 (GRADE 60).
 - CONE (As .12).
 - RISER/WALLS (As .12).
 - FLOOR (As .31) #5 BARS AT 12" C.C.E.W.

Rim: 415.88' Rim to Invert: 4.55' Slack: 2.6" Sump: 3" Step Position: 90°

Position	Elev	Angle	Ext. (cw)	Pipe	Pipe OD	Connector	Hole	Horz Size	Up ()	Offset
Invert 1	411.33'	0°	0"	15" PVC SDR35	15.3"	PSX 18M DD	18"	18.451"	1.5"	0"
Invert 2	411.33'	200°	101.229"	15" PVC SDR35	15.3"	PSX 18M DD	18"	18.451"	1.5"	0"
Invert 3										
Invert 4										
Invert 5										
Invert 6										
Invert 7										
Invert 8										

RIGHT-SIDE UP VIEW (int. dimensions)

UPSIDE-DOWN VIEW (int. dimensions)

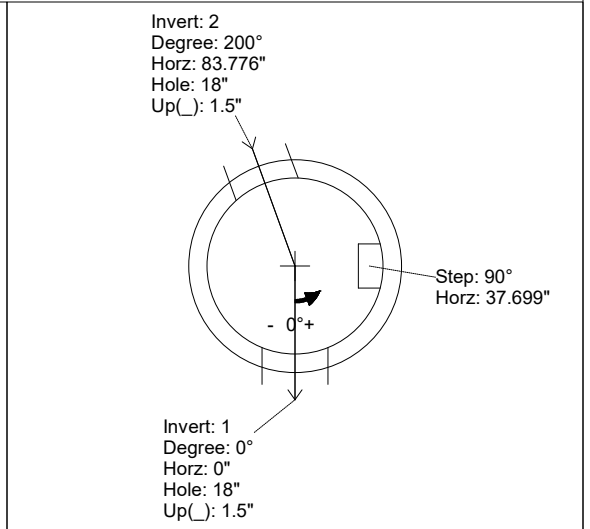
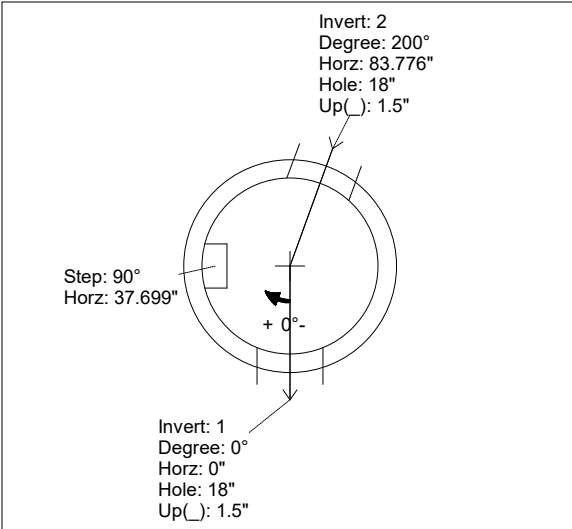
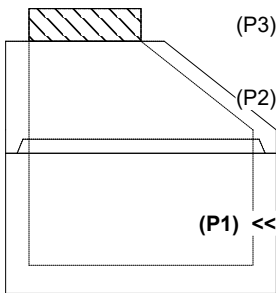

INSIDE WALL DIMENSIONS

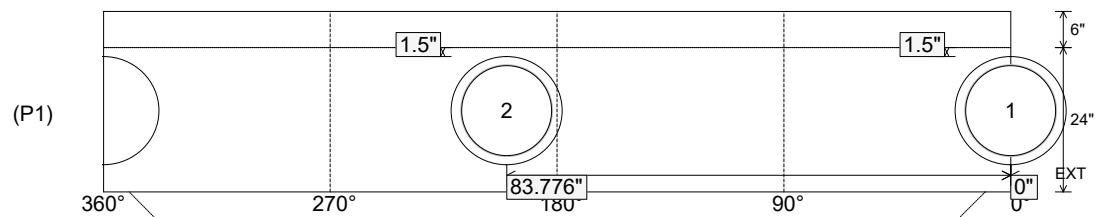

Coating (Int):
 Coating (Ext):

Seam Up: Tongue
 Seam Dn: n/a

Wall Thickness: 5"
 Floor Height: 6"

Height (Int): 24"
 Height (Ext): 30"

Weight (Net): 2789 lb
 Volume (Net): 0.71cu.yd

Job Name: 24-1164 Paddy's Run Flood PS
 Job Location: Louisville, Ky.
 Contractor: Core & Main LP (Lou)

Plant: Beaver Dam, Ky.
 5/18/2026 8:15:27 AM

Tech: S. Felletter
 PC:



Structure ID: MH 2 (2+91)

P1 MH048BA24

MH BASE T/n

- P3) 24" - CASTING HEIGHT - 7"
- P2) 48" - ECC CONE w/ 24" HOLE F/G - 24"
- P1) 48" - MH BASE T/n - 24"
- 1) 48" - STORM INVERT CHANNEL - 1/4 HEIGHT
- 1) JOINT WRAP - 0.065"x6"x50' CONSEAL CS212
- 1) JOINT WRAP PRIMER - CONSEAL CS-75 (1 gal.)
- 1) Chimney Seal - Trelleborg FlexRib Chimney Seal
- 1) CASTING - HOE WT-420-MSD F/C Storm
- 1) 48" - Conseal CS-102 1.00" (Double)
- 2) PSX - 18M DD
- 4) MH Step ML-10-TDS-NCR - 10"

0 lb
 1550 lb
 2789 lb
 1075 lb
 0 lb
 0 lb
 10 lb
 340 lb
 0 lb
 16 lb
 0 lb

 Structure Total: 5780 lb

Structure Notes: 1. PER ASTM C478 & MSD SPECIFICATIONS.
 2. CONCRETE = 5,000 PSI AT 28 DAYS.
 3. CASTING BY ICST (HOE MC-420).
 REINFORCING PER ASTM A615 (GRADE 60).
 - CONE (As .12).
 - RISER/WALLS (As .12).
 - FLOOR (As .31) #5 BARS AT 12" C.C.E.W.

**Invert channel drawing
 1/4 Height invert**

Structure Total: 5780 lb

Rim: 415.88' Rim to Invert: 4.55' Slack: 2.6" Sump: 3" Step Position: 90°

Position	Elev	Angle	Ext. (cw)	Pipe	Pipe OD	Connector	Hole	Horz Size	Up (↓)	Offset
Invert 1	411.33'	0°	0"	15" PVC SDR35	15.3"	PSX 18M DD	18"	18.451"	1.5"	0"
Invert 2	411.33'	200°	101.229"	15" PVC SDR35	15.3"	PSX 18M DD	18"	18.451"	1.5"	0"
Invert 3										
Invert 4										
Invert 5										
Invert 6										
Invert 7										
Invert 8										

RIGHT-SIDE UP VIEW (int. dimensions)

UPSIDE-DOWN VIEW (int. dimensions)

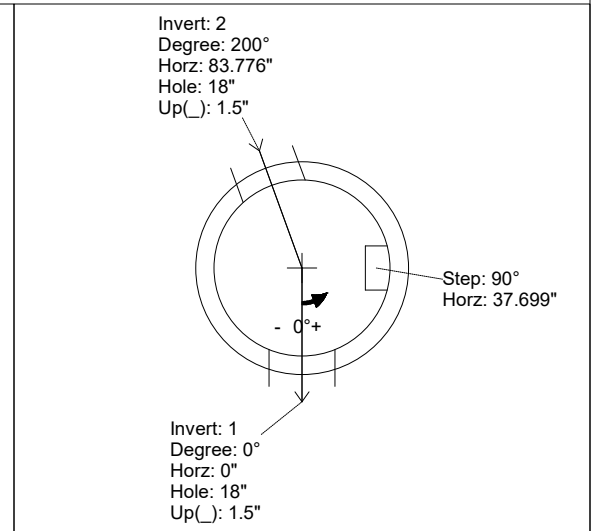
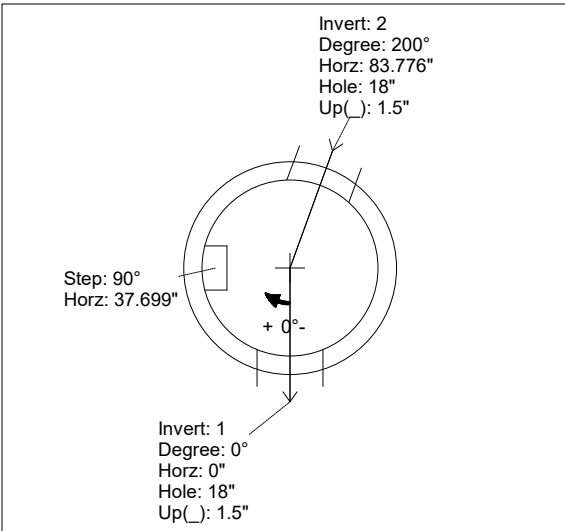
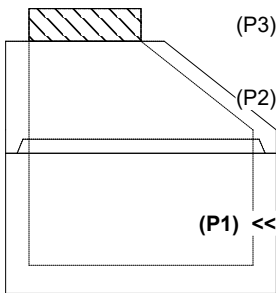

INSIDE WALL DIMENSIONS

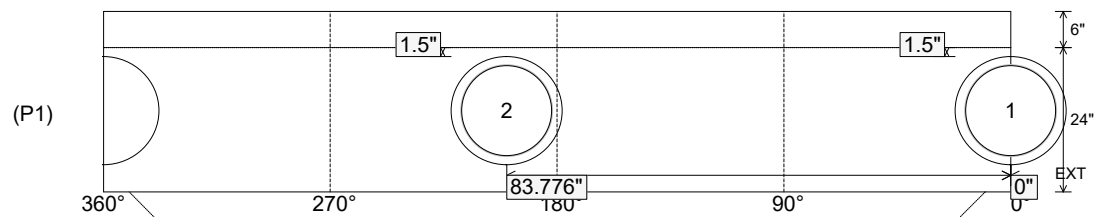

Coating (Int):
 Coating (Ext):

Seam Up: Tongue
 Seam Dn: n/a

Wall Thickness: 5"
 Floor Height: 6"

Height (Int): 24"
 Height (Ext): 30"

Weight (Net): 2789 lb
 Volume (Net): 0.71cu.yd