

Job Name: 26-2324 880717 Shepper & Converse Ave  
 Job Location: Plain City, OH  
 Contractor: Contech Engineering Solutions

Plant: Beaver Dam

Tech: S. Felletter

5/13/2026 11:55:21 AM

PC: C. Goff



**Structure ID: 15-CS-8**

**P4 MH096LD17SP**

**MH FLAT TOP SPEC. (2 - 24"Ø HOLES) F/G**

- P5) 24" - CASTING HEIGHT - 4"
- P4) 96" - MH FLAT TOP SPEC. (2 - 24"Ø HOLES) F/G - 17"
- P3) 96" - MH RISER T/G - 78"
- P2) 96" - MH RISER T/G - 36"
- P1) 96" - MH MONOBASE 13F, Custom Ht T/n - 24"
- 1) CVSTENCILING
- 1) ASSEMBLY REQUIRED
- 3) 96" - Conseal CS-102 1.00"
- 2) Hole - 36
- 1) Hole - 20

**Structure Notes:**  
 4" CASTING BY OTHERS  
 LIFTING ANCHORS TO BE INSTALLED ON THE OUTSIDE OF THE STRUCTURE  
 ICAST TO INSTALL INTERNALS  
 CONTECH'S LOGO AS WELL AS THE INLET AND OUTLET MUST BE STENCILED ONTO THE STRUCTURE  
 P2 & P3 RISERS TO BE MECHANICALLY ATTACHED PRIOR TO INSTALL

Structure Total: 53719 lb

GENERAL NOTES:

1. MANUFACTURED TO ASTM C-478 (LATEST REVISION).
2. CONCRETE 5,000 PSI AT 28 DAYS.
3. WEIGHT: 10,015 LBS.
4. REINFORCING: TOP MAT: #4 BAR @ 18" C/C E.W.  
 BOTTOM MAT: #5 BAR @ 12" C/C E.W.  
 PER ASTM A615 (GRADE 60)

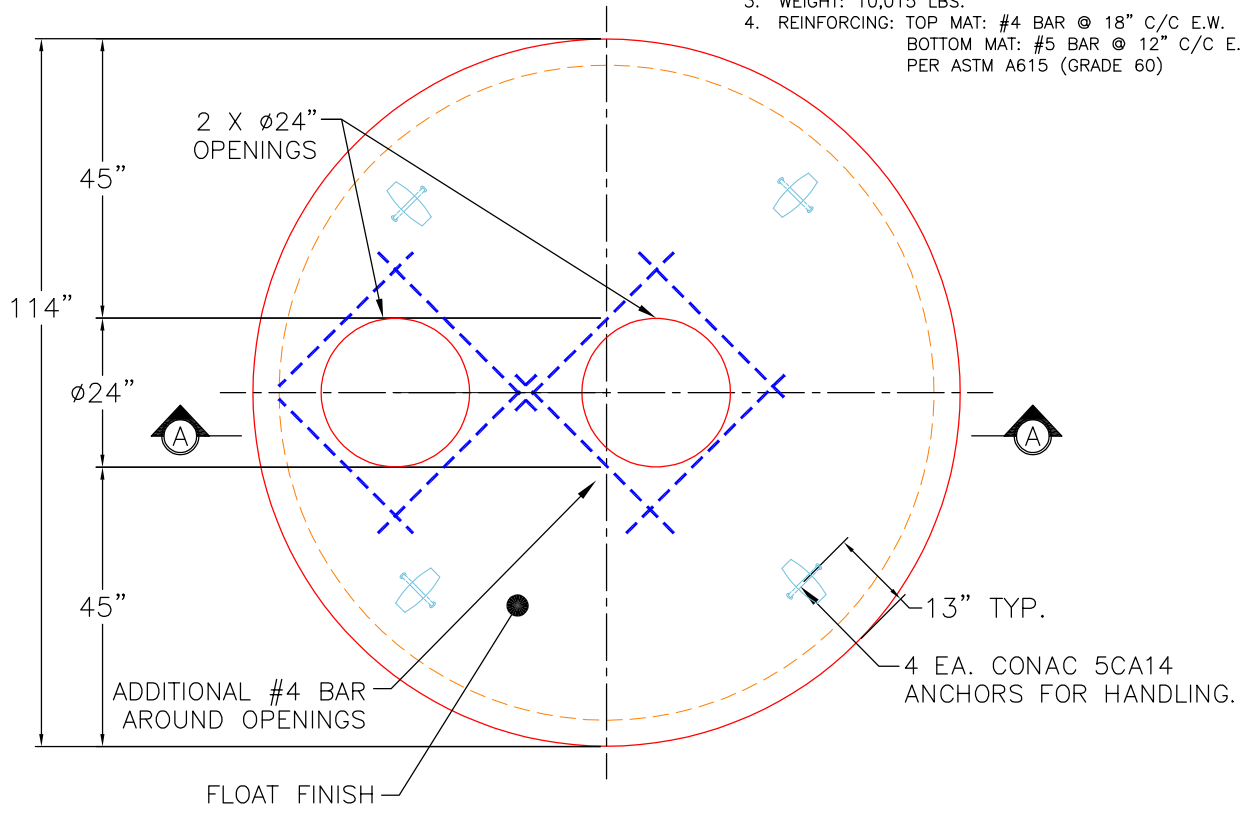

**PLAN VIEW**

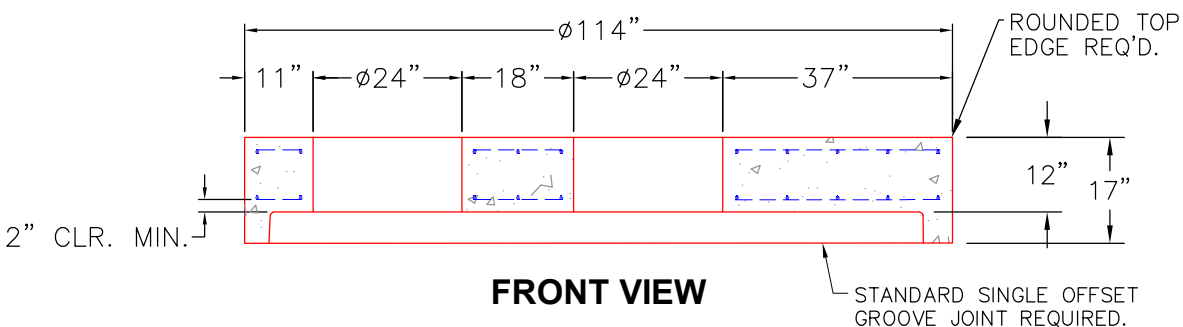

**FRONT VIEW**

Coating (Int):  
 Coating (Ext):

Seam Up: Flat  
 Seam Dn: Groove

Wall Thickness: 9"

Height (Ext): 17"

Weight (Net): 10015 lb  
 Volume (Net): 2.56cu.yd