

Job Name: 26-1230 - Wheelwright WWTP & LS Improvements
 Job Location: Wheelwright, KY
 Contractor: Endesol, Inc.

Plant: 100
 5/6/2026 5:09:02 PM

Tech: Jared - F
 PC: E. Bradley



Structure ID: 4-B

P1 CVBS

Base Slab F/n

P1) 84" x 84" - Base Slab F/n - 8"

Structure Total: 4737 lb

Structure Notes:

1. PER ASTM C913 SPECIFICATIONS.
2. CONCRETE = 4,000 PSI AT 28 DAYS.

REINFORCING PER ASTM A615 (GRADE 60).
 - #5 BARS AT 12" C.C.E.W.

Rim: 0.667' Rim to Invert: 0' Slack: 0" Sump: 0" Step Position:

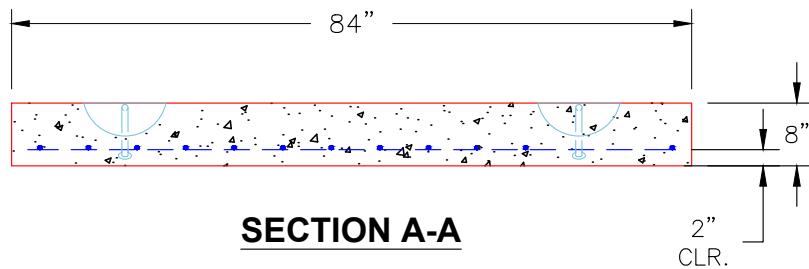
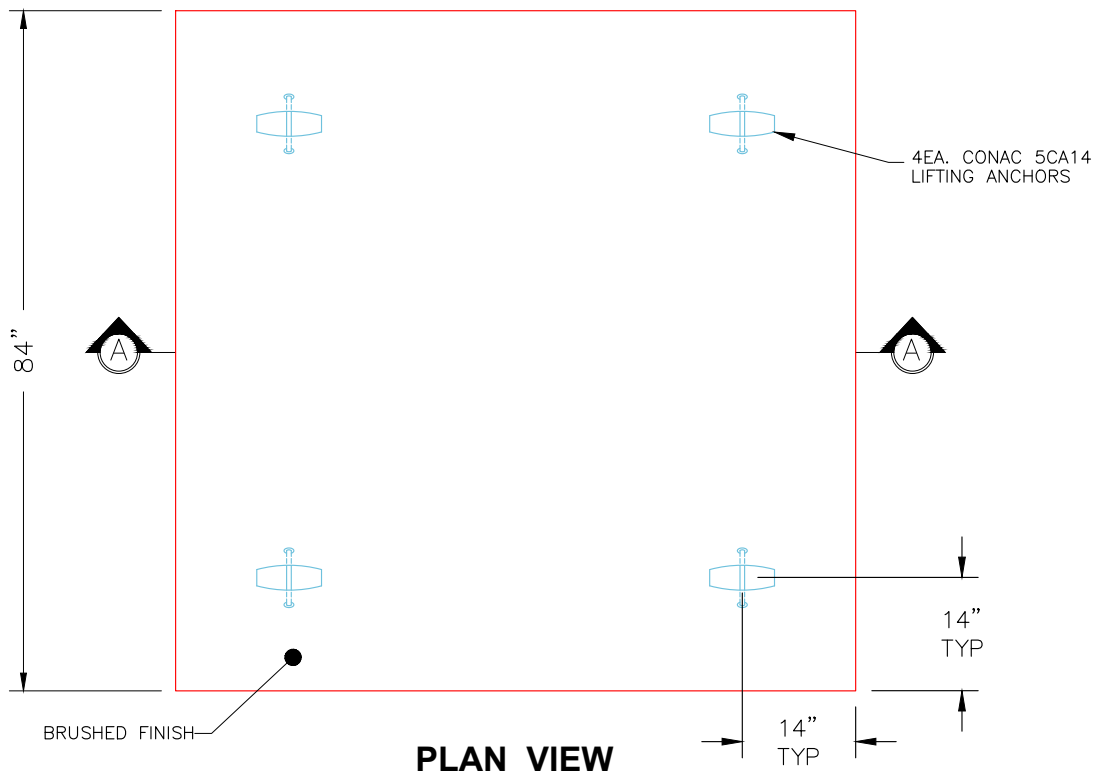

NOTES:

1. MANUFACTURED TO ASTM C-913 (LATEST REVISION).
2. CONCRETE: 4,000 PSI AT 28 DAYS.
3. REINFORCING: #5 BAR @ 12" O.C. E.W. (GRADE 60).

Coating (Int): Coating (Ext):	Seam Up: Flat Seam Dn: n/a	Wall Thickness: 0" Floor Height: 8"	Height (Int): 0" Height (Ext): 0"	Weight (Net): 4737 lb Volume (Net): 1.21cu.yd
----------------------------------	-------------------------------	--	--------------------------------------	--