

Job Name: 26-1227 - Project Colt  
 Job Location: Evansville, IN  
 Contractor: Russell's Excavating

Plant: 100  
 5/12/2026 11:30:12 AM

Tech: Jared - F  
 PC: A. Chambers



**Structure ID: 303-5 MHJ**

**P1 MH060BAVF**

**MH BASE Custom Ht F/n**

- P3) 24" x 36" - CASTING HEIGHT - 4"
- P2) 60" - MH FLAT TOP w/24"x36" Hole F/F - 8"
- P1) 60" - MH BASE Custom Ht F/n - 49"
- 1) CASTING - HOE 518 F/G
- 1) 60" - Conseal CS-102 1.00"
- 1) 24" x 36" - Conseal CS-102 1.00"
- 2) Hole - 24
- 1) Hole - 20
- 2) Hole - 6
- 4) MH Step ML-10-TDS-NCR - 10"

0 lb  
 2153 lb  
 7193 lb  
 354 lb  
 0 lb  
 0 lb  
 0 lb  
 0 lb  
 0 lb  
 0 lb  
 0 lb  
 0 lb  
 Structure Total: 9700 lb

**Structure Notes:**  
 1. INDOT MH TYPE J / ASTM C478 SPEC'S.  
 2. CONCRETE = 4,000 PSI AT 28 DAYS.  
 3. NO INVERT CHANNEL.  
 4. CASTING BY ICAST (HOE 518 F/G).  
  
 REINFORCING PER ASTM A615 (GRADE 60).  
 - TOP SLAB (As .62) #5 BARS AT 6" C.C.E.W..  
 - RISER/WALLS (As .12)  
 - FLOOR (As .62) #5 BARS AT 6" C.C.E.W.

Rim: 379.98' Rim to Invert: 4.98' Slack: 0.385" Sump: 1.625" Step Position: 270

Position	Elev	Angle	Ext. (cw)	Pipe	Pipe OD	Connector	Hole	Horz Size	Up ( )	Offset
Invert 1	375'	0°	0"	18" HDPE	21.2"	Hole 24	24"	24.691"	0"	0"
Invert 2	375.9'	55°	34.5"	15" HDPE	17.6"	Hole 20	20"	20.39"	11.125"	0"
Invert 3	375'	150°	94.25"	18" HDPE	21.2"	Hole 24	24"	24.691"	0"	0"
Invert 4	377.98'	30°	18.875"	4" HDPE (perf pipe)	4.8"	Hole 6	6"	6.01"	37"	0"
Invert 5	377.98'	125°	78.5"	4" HDPE (perf pipe)	4.8"	Hole 6	6"	6.01"	37"	0"
Invert 6										
Invert 7										
Invert 8										

RIGHT-SIDE UP VIEW (int. dimensions)

UPSIDE-DOWN VIEW (int. dimensions)

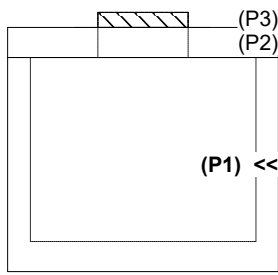
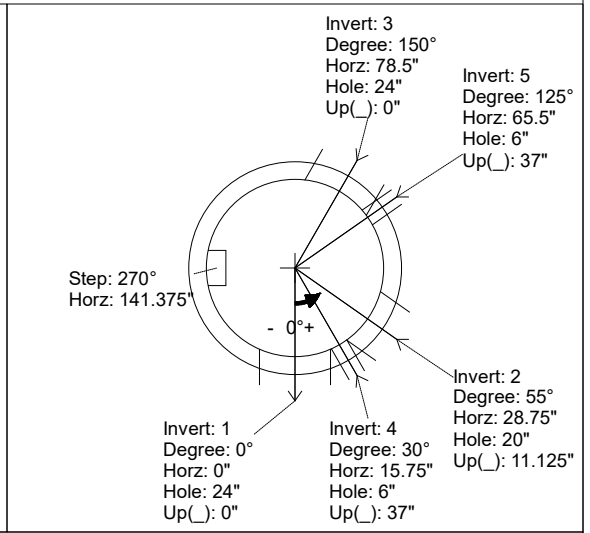
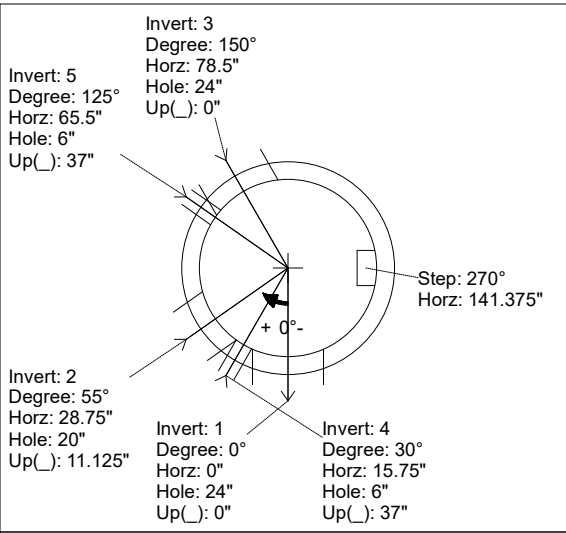

INSIDE WALL DIMENSIONS

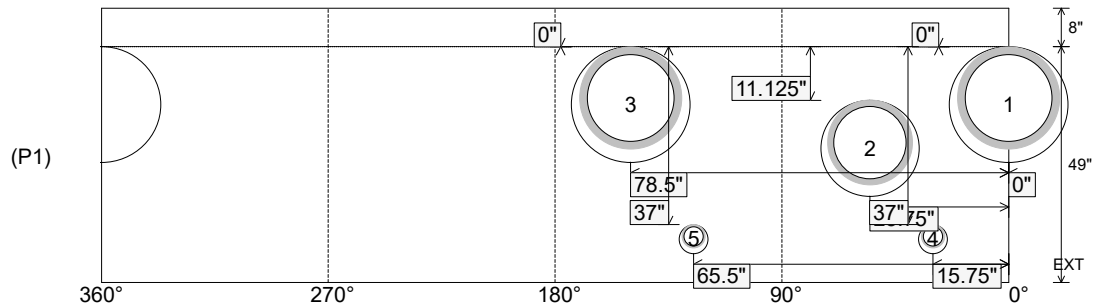

Coating (Int):  
 Coating (Ext):

Seam Up: Flat  
 Seam Dn: n/a

Wall Thickness: 6"  
 Floor Height: 8"

Height (Int): 49"  
 Height (Ext): 57"

Weight (Net): 7193 lb  
 Volume (Net): 1.84cu.yd