

Job Name: 25-3531 - Crescent Hill Filtration Plant Carbon Storage
 Job Location: Louisville, KY
 Contractor: Dugan & Meyers, LLC

Plant: Beaver Dam, KY
 3/30/2026 9:45:22 AM

Tech: K. Cardwell
 PC: J. Jarvis



Structure ID: V-008

P4 BX60120-08LD08-S

BX FLAT TOP 8"W w/60"x120" HATCH

- P5) 60" x 120" - HATCH (CAST FLUSH) - 3"
- P4) 60" x 120" - BX FLAT TOP 8"W w/60"x120" HATCH - 8"
- P3) 60" x 120" - BOX RISER 8inW, Variable Ht - 38"
- P2) 60" x 120" - BOX RISER 8inW, Variable Ht - 47"
- P1) 60" x 120" - BX Separate Base Slab - 8"
- 1) HATCH (Alum.) - HALLIDAY H2R 48"x48"
- 1) This Structure Includes a Cast-In Item (Hatch)
- 4) 60" x 120" - Conseal CS-102 1.00"
- 1) DOGHOUSE - 44"x44"
- 2) Hole - 6.5
- 1) Hole - 11
- 8) MH Step ML-10-TDS-NCR - 10"

100 lb
 2105 lb
 9891 lb
 11241 lb
 6085 lb
 235 lb
 0 lb
 0 lb
 0 lb
 0 lb
 0 lb
 0 lb

Structure Notes:
 1. PER ASTM C913 SPECIFICATIONS.
 2. CONCRETE = 4,000 PSI AT 28 DAYS.
 3. NO INVERT CHANNEL.

 REINFORCING PER ASTM A615 (GRADE 60).
 - TOP SLAB (As .62) #5 BARS AT 6" C.C.E.W.
 - WALLS (As .31) #5 BARS AT 12" C.C.E.W.
 - FLOOR (As .31) #5 BARS AT 12" C.C.E.W.

Structure Total: 29658 lb

GENERAL NOTES:

1. MANUFACTURED TO ASTM C-913 (LATEST REVISION) & DESIGNED TO MEET ASTM C857 & ACI 318 REQUIREMENTS.
2. CONCRETE: 5,000 PSI AT 28 DAYS
3. REINFORCEMENT
 - FLAT LID: #5 BAR @ 6" C.C. E.W. (GRADE 60)
4. HALLIDAY S2S 120" X 60" HATCH SUPPLIED BY ICAST TO BE CAST INTO FLAT LID
5. JOINT SEALANT: CONSEAL CS-102

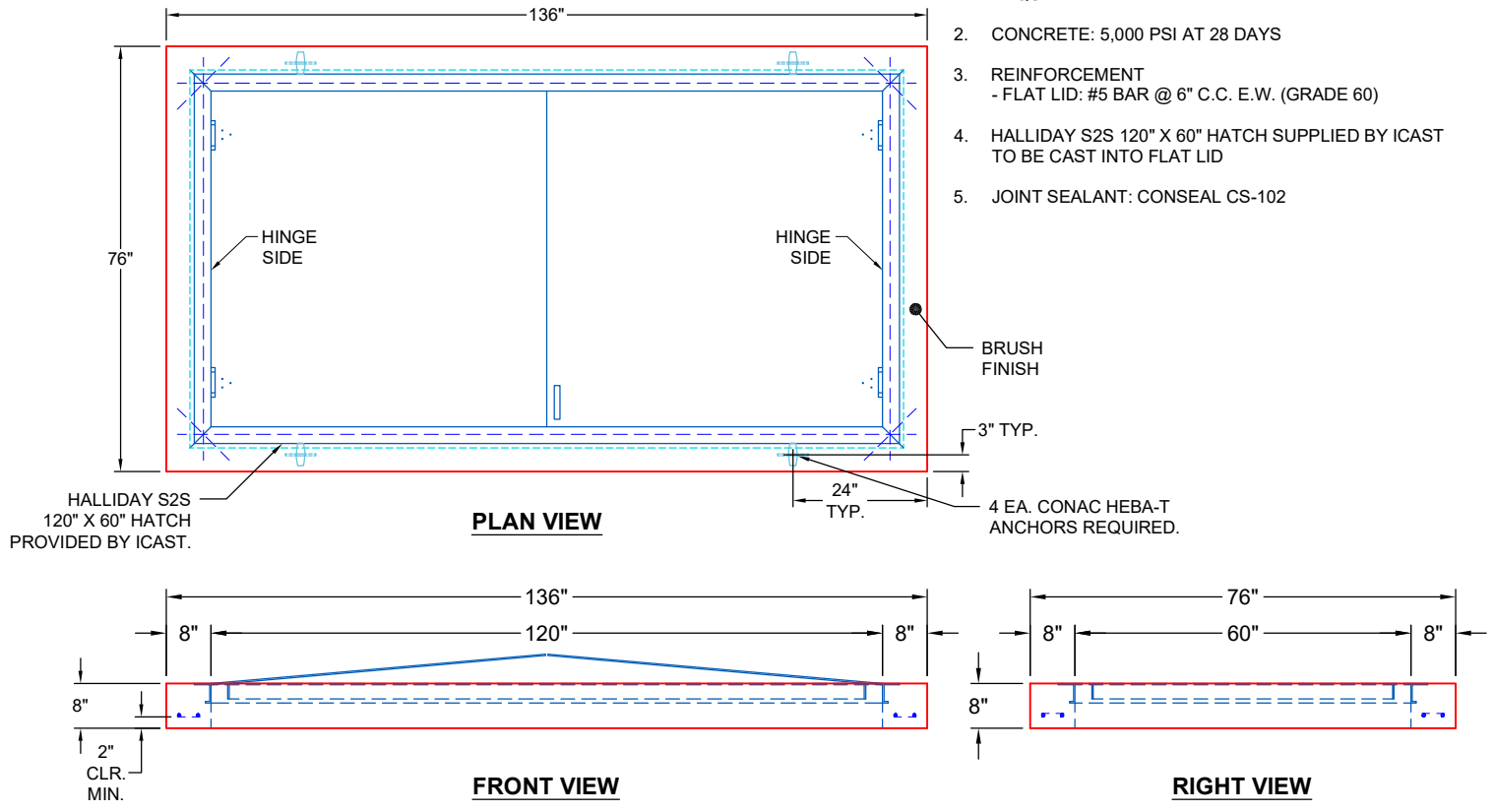

Coating (Int): Coating (Ext):	Seam Up: Flat Seam Dn: Flat	Wall Thickness: 8"	Height (Ext): 8"	Weight (Net): 2105 lb Volume (Net): 0.54cu.yd
----------------------------------	--------------------------------	--------------------	------------------	--