

Job Name: 25-3579 - Lebanon Rd Clarks Run Trunk Sewer Ph 2
 Job Location: Danville, KY
 Contractor: Hubert Excavating & Contracting

Plant: 100

6/3/2026 1:48:08 PM

Tech: J. Horsley

PC: C. Goff



Structure ID: MH A7

P1 MH060BAEVF

MH BASE w/FLANGE (08F/07EF) w/Coating T/n

- P6) 24" - CASTING HEIGHT - 7"
- P5) 24" - GRADE RING F/F - 4"
- P4) 48" - ECC CONE w/ 24" HOLE, w/Coating F/G - 42"
- P3) 48" - MH RISER w/COATING T/G - 72"
- P2) 60" - MH Trans. Slab - 48" Hole ECC, w/Coating T/G - 13"
- P1) 60" - MH BASE w/FLANGE (08F/07EF) w/Coating T/n - 60"
- 1) 60" - MH INVERT CHANNEL - FULL HEIGHT
- 1) JOINT WRAP - 12" WD x 060° MAC WRAP
- 1) SPECIAL EXTERNAL COATING - Carboline 300M
- 1) SECONDARY POUR - Extended Flange
- 2) JOINT WRAP - 12" WD x 048" MAC WRAP
- 1) 60" - Conseal CS-102 1.00" (Double)
- 2) 48" - Conseal CS-102 1.00" (Double)
- 2) 24" - Conseal CS-102 1.00" (Double)
- 2) A-Lok - 1040
- 15) MH Step ML-10-TDS-NCR - 10"

- 0 lb
- 270 lb
- 3116 lb
- 5030 lb
- 1928 lb
- 9231 lb
- 2692 lb
- 0 lb
- 0 lb
- 0 lb
- 0 lb
- 0 lb
- 0 lb
- 0 lb
- 2 lb
- 0 lb
- 0 lb
- 0 lb

- Structure Notes:
1. PER ASTM C-478 SPECIFICATIONS
 2. CONCRETE: 4,000 PSI AT 28 DAYS
 3. REINFORCEMENT: PER ASTM A615
 4. INVERT CHANNEL REQUIRED
 5. CARBOLINE 300M EXTERIOR COATING REQUIRED
 6. STEPS AT 267 DEGREES
 7. HOE MC-375 FRAME & COVER "SANITARY" SUPPLIED BY OTHERS

Structure Total: 22229 lb

FIRST POUR (BASE): 7,881 LBS
SECOND POUR (FLANGE): 1,350 LBS

Rim: 904.32' Rim to Invert: 16.445' Slack: 1.555" Sump: 2.215" Step Position: 267°

Position	Elev	Angle	Ext. (cw)	Pipe	Pipe OD	Connector	Hole	Horz Size	Up ()	Offset
Invert 1	887.875'	0°	0"	30" PVC F679 (PS115)	32"	A-Lok 1040	33.5"	35.543"	0"	0"
Invert 2	887.925'	174°	109.375"	30" PVC F679 (PS115)	32"	A-Lok 1040	33.5"	35.543"	0.625"	0"
Invert 3										
Invert 4										
Invert 5										
Invert 6										
Invert 7										
Invert 8										

RIGHT-SIDE UP VIEW (int. dimensions)

UPSIDE-DOWN VIEW (int. dimensions)

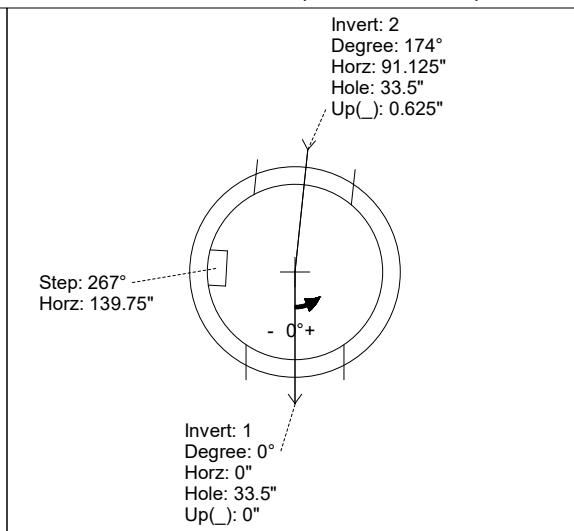
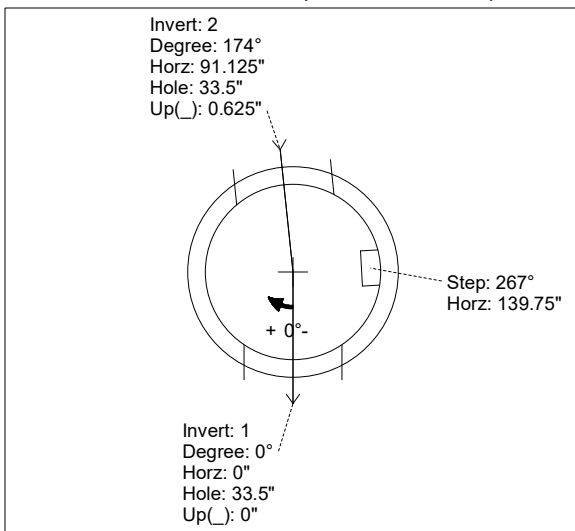
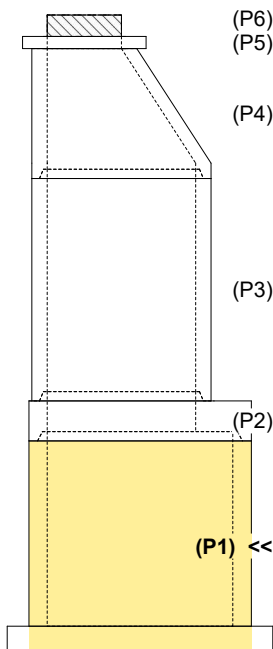

INSIDE WALL DIMENSIONS

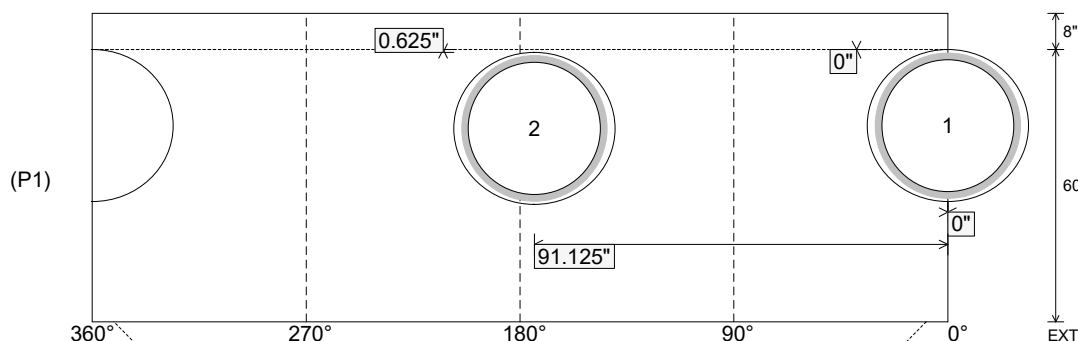

Coating (Int):
Coating (Ext): Carboline Bitumastic 300M

Seam Up: Tongue
Seam Dn: n/a

Wall Thickness: 6"
Floor Height: 8"

Height (Int): 60"
Height (Ext): 68"

Weight (Net): 9231 lb
Volume (Net): 2.36cu.yd

Job Name: 25-3579 - Lebanon Rd Clarks Run Trunk Sewer Ph 2
 Job Location: Danville, KY
 Contractor: Hubert Excavating & Contracting

Plant: 100

Tech: J. Horsley

6/3/2026 1:48:08 PM

PC: C. Goff

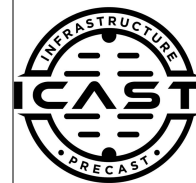

Structure ID: MH A7

P1 MH060BAEVF

MH BASE w/FLANGE (08F/07EF) w/Coating T/n

- P6) 24" - CASTING HEIGHT - 7"
- P5) 24" - GRADE RING F/F - 4"
- P4) 48" - ECC CONE w/ 24" HOLE, w/Coating F/G - 42"
- P3) 48" - MH RISER w/COATING T/G - 72"
- P2) 60" - MH Trans. Slab - 48" Hole ECC, w/Coating T/G - 13"
- P1) 60" - MH BASE w/FLANGE (08F/07EF) w/Coating T/n - 60"
- 1) 60" - MH INVERT CHANNEL - FULL HEIGHT
- 1) JOINT WRAP - 12" WD x 060° MAC WRAP
- 1) SPECIAL EXTERNAL COATING - Carboline 300M
- 1) SECONDARY POUR - Extended Flange
- 2) JOINT WRAP - 12" WD x 048° MAC WRAP
- 1) 60" - Conseal CS-102 1.00" (Double)
- 2) 48" - Conseal CS-102 1.00" (Double)
- 2) 24" - Conseal CS-102 1.00" (Double)
- 2) A-Lok - 1040
- 15) MH Step ML-10-TDS-NCR - 10"

0 lb
 270 lb
 3116 lb
 5030 lb
 1928 lb
 9231 lb
 2692 lb
 0 lb
 0 lb
 0 lb
 0 lb
 0 lb
 0 lb
 0 lb
 2 lb
 0 lb
 0 lb
 0 lb
 22269 lb

- Structure Notes:**
1. PER ASTM C-478 SPECIFICATIONS
 2. CONCRETE: 4,000 PSI AT 28 DAYS
 3. REINFORCEMENT: DRILL & DOWEL #5 BAR @ 8" C.C. E.W. (GRADE 60) FOR FLANGE POUR TIE-IN - 4" MIN. PENETRATION INTO BASE FLOOR & 2" MIN. REBAR CLEARANCE (TYP)
 4. INVERT CHANNEL REQUIRED
 5. CARBOLINE 300M EXTERIOR COATING REQUIRED
 6. STEPS AT 267 DEGREES
 7. HOE MC-375 FRAME & COVER "SANITARY" SUPPLIED BY OTHERS

Structure Total: 22269 lb

FIRST POUR (BASE): 7,881 LBS
SECOND POUR (FLANGE): 1,350 LBS

Rim: 904.32' Rim to Invert: 16.445' Slack: 1.555" Sump: 2.215" Step Position: 267°

Position	Elev	Angle	Ext. (cw)	Pipe	Pipe OD	Connector	Hole	Horz Size	Up ()	Offset
Invert 1	887.875'	0°	0"	30" PVC F679 (PS115)	32"	A-Lok 1040	33.5"	35.543"	0"	0"
Invert 2	887.925'	174°	109.375"	30" PVC F679 (PS115)	32"	A-Lok 1040	33.5"	35.543"	0.625"	0"
Invert 3										
Invert 4										
Invert 5										
Invert 6										
Invert 7										
Invert 8										

RIGHT-SIDE UP VIEW (int. dimensions)

UPSIDE-DOWN VIEW (int. dimensions)

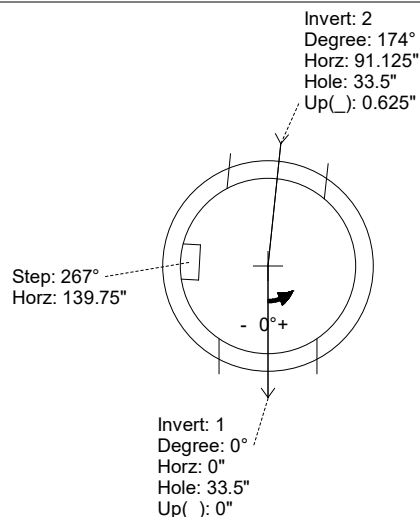
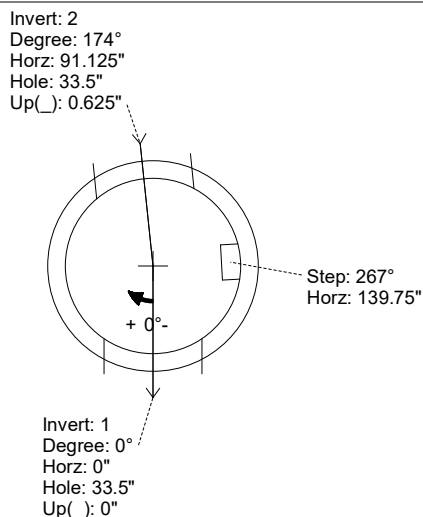

INSIDE WALL DIMENSIONS

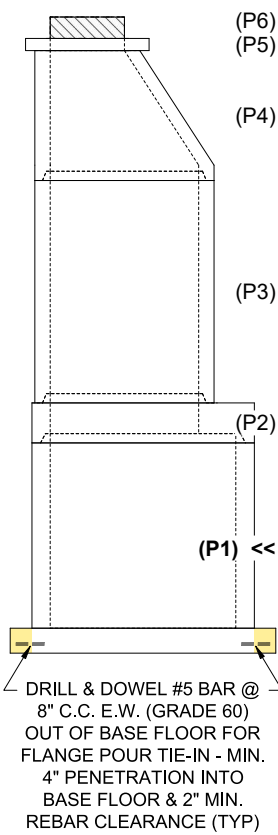
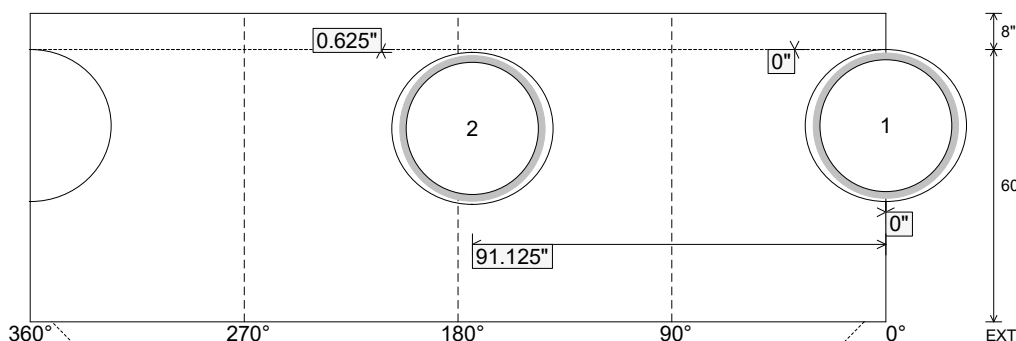

Coating (Int):
 Coating (Ext): Carboline Bitumastic 300M

Seam Up: Tongue
 Seam Dn: n/a

Wall Thickness: 6"
 Floor Height: 8"

Height (Int): 60"
 Height (Ext): 68"

Weight (Net): 9231 lb
 Volume (Net): 2.36cu.yd

Job Name: 25-3579 - Lebanon Rd Clarks Run Trunk Sewer Ph 2
 Job Location: Danville, KY
 Contractor: Hubert Excavating & Contracting

Plant: 100

Tech: J. Horsley

6/3/2026 1:48:08 PM

PC: C. Goff



Structure ID: MH A7

P1 MH060BAEVF

MH BASE w/FLANGE (08F/07EF) w/Coating T/n

P6)	24" - CASTING HEIGHT - 7"	0 lb
P5)	24" - GRADE RING F/F - 4"	270 lb
P4)	48" - ECC CONE w/ 24" HOLE, w/Coating F/G - 42"	3116 lb
P3)	48" - MH RISER w/COATING T/G - 72"	5030 lb
P2)	60" - MH Trans. Slab - 48" Hole ECC, w/Coating T/G - 13"	1928 lb
P1)	60" - MH BASE w/FLANGE (08F/07EF) w/Coating T/n - 60"	9231 lb
1)	60" - MH INVERT CHANNEL - FULL HEIGHT	2692 lb
1)	JOINT WRAP - 12" WD x 060" MAC WRAP	0 lb
1)	SPECIAL EXTERNAL COATING - Carboline 300M	0 lb
1)	SECONDARY POUR - Extended Flange	0 lb
2)	JOINT WRAP - 12" WD x 048" MAC WRAP	0 lb
1)	60" - Conseal CS-102 1.00" (Double)	0 lb
2)	48" - Conseal CS-102 1.00" (Double)	0 lb
2)	24" - Conseal CS-102 1.00" (Double)	0 lb
2)	A-Lok - 1040	2 lb
15)	MH Step ML-10-TDS-NCR - 10"	0 lb
	292.89 SqFt) Carboline Bitumastic 300M [EXT]	0 lb
	Structure Total:	22269 lb

Structure Notes:
 1. PER ASTM C-478 SPECIFICATIONS
 2. CONCRETE: 4,000 PSI AT 28 DAYS
 3. REINFORCEMENT: PER ASTM A615
 4. INVERT CHANNEL REQUIRED
 5. CARBOLINE 300M EXTERIOR COATING REQUIRED
 6. STEPS AT 267 DEGREES
 7. HOE MC-375 FRAME & COVER "SANITARY" SUPPLIED BY OTHERS

Rim: 904.32' Rim to Invert: 16.445' Slack: 1.555" Sump: 2.215" Step Position: 267°

Position	Elev	Angle	Ext. (cw)	Pipe	Pipe OD	Connector	Hole	Horz Size	Up ()	Offset
Invert 1	887.875'	0°	0"	30" PVC F679 (PS115)	32"	A-Lok 1040	33.5"	35.543"	0"	0"
Invert 2	887.925'	174°	109.375"	30" PVC F679 (PS115)	32"	A-Lok 1040	33.5"	35.543"	0.625"	0"
Invert 3										
Invert 4										
Invert 5										
Invert 6										
Invert 7										
Invert 8										

RIGHT-SIDE UP VIEW (int. dimensions)

UPSIDE-DOWN VIEW (int. dimenions)

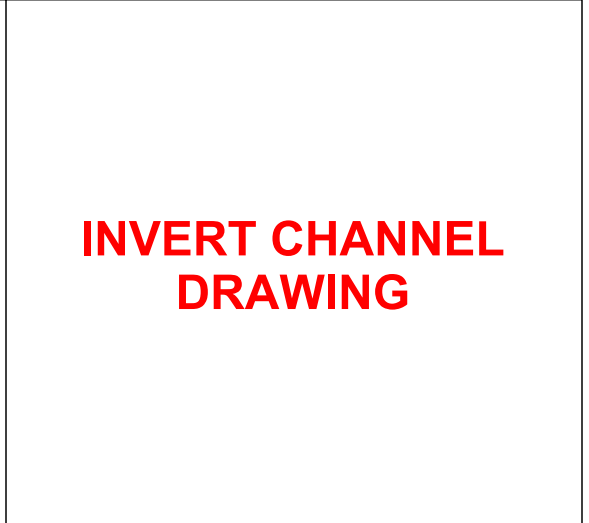
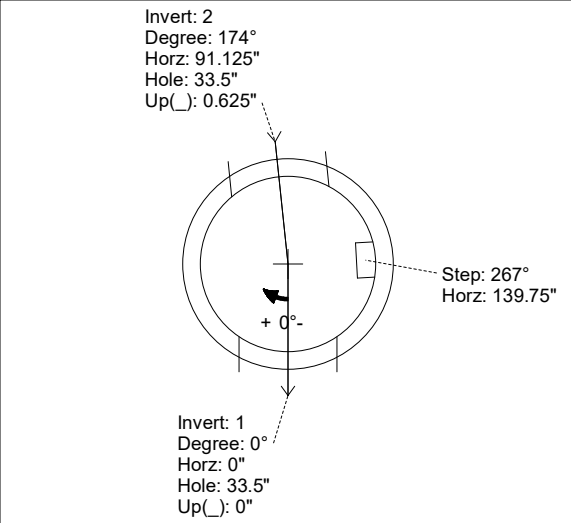
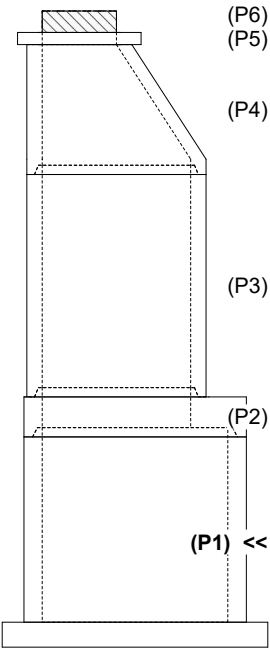

INSIDE WALL DIMENSIONS

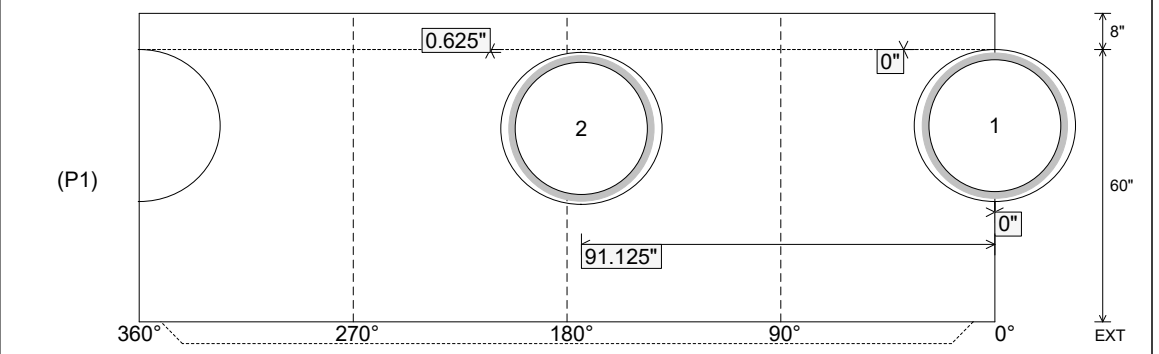

Coating (Int): Coating (Ext): Carboline Bitumastic 300M	Seam Up: Tongue Seam Dn: n/a	Wall Thickness: 6" Floor Height: 8"	Height (Int): 60" Height (Ext): 68"	Weight (Net): 9231 lb Volume (Net): 2.36cu.yd
--	---------------------------------	--	--	--

Job Number:

25-3579

Job Name:

Lebanon Rd Clarks Run Trunk Sewer
Ph 2

Structure:

MH A7

Note:

This Structure Is To Receive An
External Coating of Carboline 300M
(Supplied By iCast)